

15-055-20253

State Geological Survey

KANSAS DRILLERS' LOG

S. 9 T. 26 R. 34 ^R/_W

API No. 15 — 055 — 20,253
County Number

Loc. C N2

Operator
Helmerich & Payne, Inc.

County Finney

Address
Box 558 Garden City, Kansas 67846

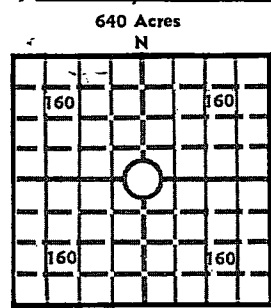

Elev.: Gr. 2957
Locate well correctly

Well No. #A-1 Lease Name Bedford

Footage Location
feet from (N) (S) line feet from (E) (W) line

Principal Contractor Gabbert-Jones, Inc. Geologist Joseph Blair

Spud Date 2-14-77 Total Depth 2904 P.B.T.D. 2840

Date Completed 3-20-77 Purchaser (Gas) Colorado Interstate Gas

DF 2960 KB 2962

CASING RECORD

Report of all strings set — surface, intermediate, production, etc.

Purpose of string	Size hole drilled	Size casing set (in O.D.)	Weight lbs/ft.	Setting depth	Type cement	Sacks	Type and percent additives
Surface	12 1/4	8-5/8	28	804	Howco-Lite Class "H"	350	1/4# Flocele & 2% CaCl
Production	7-7/8"	4 1/2"	10.5	2903	Howco Lite	700	10% Gilsonite
						100	Posmix 18% Salt

LINER RECORD

PERFORATION RECORD

Top, ft.	Bottom, ft.	Sacks cement	Shots per ft.	Size & type	Depth interval
			2	1/2" Omega Jet	2844-2855
			2	1/2" Omega Jet	2786-2790
			2	1/2" Omega Jet	2798-2808

Size	Setting depth	Packer set at
2-3/8"	2829	None

ACID, FRACTURE, SHOT, CEMENT SQUEEZE RECORD

Amount and kind of material used	Depth interval treated
500 gal 15% HCl w/5 gal Morflo Surfactant	2844-2855
Squeezed w/100 sx common cement	2840-2904
2000 gal HCl, 2 gal inhib., 2 gal detergent, 50 ball sealers, Flush w/12 bbls fresh water.	2786-2822
Frac w/120,0-0 gal fresh water & 100,000# 16-30 river sd. Spearhead w/2000 gal 15% HCl.	2786-2822

INITIAL PRODUCTION

Date of first production 6-15-77 Producing method (flowing, pumping, gas lift, etc.) Flowing

RATE OF PRODUCTION PER 24 HOURS
Oil 0 bbls. Gas 1587 MCF Water 2 bbls. Gas-oil ratio CFPB

Disposition of gas (vented, used on lease or sold) Sold-Colorado Interstate Gas Co. Producing interval (s) Council Grove A 2786-2790, 2798-2808 & 2814-22

INSTRUCTIONS: As provided in KCC Rule 82-2-125, within 90 days after completion of a well, one completed copy of this Drillers Log shall be transmitted to the State Geological Survey of Kansas, 4150 Monroe Street, Wichita, Kansas 67209. Copies of this form are available from the Conservation Division, State Corporation Commission, 3830 So. Meridian (P.O. Box 17027), Wichita, Kansas 66217. Phone AC 316-522-2206. If confidential custody is desired, please note Rule 82-2-125. Drillers Logs will be on open file in the Oil and Gas Division, State Geological Survey of Kansas, Lawrence, Kansas 66044

Operator _____ DESIGNATE TYPE OF COMP.: OIL, GAS, DRY HOLE, SWDW, ETC.:

Well No. _____ Lease Name **Bedford "A"** Gas

S 9 T 26S R 34W ^E/_W

WELL LOG

Show all important zones of porosity and contents thereof; cored intervals, and all drill-stem tests, including depth interval tested, cushion used, time tool open, flowing and shut-in pressures, and recoveries.

SHOW GEOLOGICAL MARKERS, LOGS RUN, OR OTHER DESCRIPTIVE INFORMATION.

FORMATION DESCRIPTION, CONTENTS, ETC.	TOP	BOTTOM	NAME	DEPTH
Herrington -Dolomite, gray, shaley & Tan, fine crystalline Dolomite	2502	2518	B. Stone Corral	1876
			Herrington	2502
Krider- Dolomite, tan to buff, fine xln some large xln	2524	2537	Krider	2524
			Winfield	2556
Winfield-Dolomite, buff to tan, fine xln, slightly fossiliferous	2556	2578	U. Ft. Riley	2611
			L. Ft. Riley	2664
			Wreford	2755
			Council Grove	2773
U. Ft Riley-Limey dolomite, buff, fine xln, slightly fossiliferous	2611	2646	TD	2904
L. Ft. Riley-Limestone, tan, xln, fossiliferous	2664	2696	Bond Cement-	
			Gamma Ray	
			Neutron Log	
Wreford-Limestone, lite gray, xln, foss	2755	2773		
Council Grove- Limey silt, very fine grained sd, tan to red	2773			
Council Grove "A"-Limestone, gray, shaley mottled, gray xln, fossiliferous	2800	2840		
Council Grove "B" 1-Limestone, buff to tan, medium fine xln, fossiliferous, fr lxln Ø.	2840	2861		
Council Grove "B" 2-Limestone, buff to white, fine xln, vry foss, some crs foss frag. Good Ø.	2861	2878		
Council Grove "B" 3-Limestone, lite gray, fn xln, fossiliferous, chalky	2878	2904		

USE ADDITIONAL SHEETS, IF NECESSARY, TO COMPLETE WELL RECORD.

Date Received	<i>Kent Fenderholt</i>
	Signature
	District Production Clerk
	Title
	9-25-77
	Date