

IMPORTANT
Kans. Geo. Survey request
samples on this well.

15-055-20278

API No. 15 — 055 — 20,278
County Number

S. 15 T. 26 R. 34 ^K W

Loc. C SE NW

County Finney

Operator
Champlin Petroleum

Address 6051 N. Brookline, Suite 116 Okla City, Okla 73112

Well No. #2 Lease Name Hatfield

Footage Location 1980 feet from (N) (S) line 1980 feet from (E) (W) line

Principal Contractor Service Drilling Company Geologist D. Elich

Spud Date 12-06-77 Total Depth 3010 P.B.T.D.

Date Completed 12-19-77 m ^{XK} Purchaser Gas

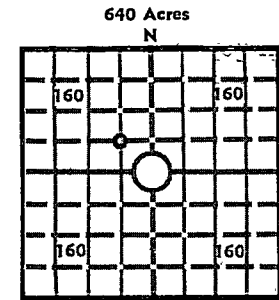

Elev.: Gr. 2947

DF KB 2954

CASING RECORD

Report of all strings set — surface, intermediate, production, etc.

Purpose of string	Size hole drilled	Size casing set (in O.D.)	Weight lbs/ft.	Setting depth	Type cement	Sacks	Type and percent additives
Surface Csg	12-1/4	8-5/8	23	763	Lite wate Class H	200 150	2% CaCl 3%-CaCl
Production Csg	7-7/8	5-1/2	14	3003	Lite wate 50-50 poz	500 100	18% salt

LINER RECORD

PERFORATION RECORD

Top, ft.	Bottom, ft.	Sacks cement	Shots per ft.	Size & type jet	Depth interval
			2	jet	2789-2886

Size	Setting depth	Packer set at
2-3/8	2932	

ACID, FRACTURE, SHOT, CEMENT SQUEEZE RECORD

Amount and kind of material used	Depth interval treated
2500-gals 15% HCL acid	2789-2886
Frac w/120,000 gals wtr; 120,000# 10-20 sand	2789-2886

INITIAL PRODUCTION

Date of first production 12-19-77	Producing method (flowing, pumping, gas lift, etc.) flowing
RATE OF PRODUCTION PER 24 HOURS	Oil None bbls. Gas 2711 estmCF Water 45 bbls. Gas-oil ratio None CFPB
Disposition of gas (vented, used on lease or sold) Vented- Well now shut in waiting on gas connection.	Producing interval(s) 2789-2886

INSTRUCTIONS: As provided in KCC Rule 82-2-125, within 90 days after completion of a well, one completed copy of this Drillers Log shall be transmitted to the State Geological Survey of Kansas, 4150 Monroe Street, Wichita, Kansas 67209. Copies of this form are available from the Conservation Division, State Corporation Commission, 3830 So. Meridian (P.O. Box 17027), Wichita, Kansas 66217. Phone AC 316-522-2206. If confidential custody is desired, please note Rule 82-2-125. Drillers Logs will be on open file in the Oil and Gas Division, State Geological Survey of Kansas, Lawrence, Kansas 66044.

Champlin Petroleum Company

Operator 6051 N. Brookline, Suite 116
Oklahoma City, Oklahoma 73112

DESIGNATE TYPE OF COMP.: OIL, GAS,
DRY HOLE, SWDW, ETC.:

Well No. 2-- Lease Name Hatfield Gas

S 15 T 26 R 34 W

WELL LOG

Show all important zones of porosity and contents thereof; cored intervals, and all drill-stem tests, including depth interval tested, cushion used, time tool open, flowing and shut-in pressures, and recoveries.

SHOW GEOLOGICAL MARKERS, LOGS RUN,
OR OTHER DESCRIPTIVE INFORMATION.

FORMATION DESCRIPTION, CONTENTS, ETC.	TOP	BOTTOM	NAME	DEPTH
Sand, Shale	0	770	Nuclear Log	500-2958
Red Beds	770	950		
Sand, Shale, Anhydrite	950	2200		
Shale, Lime	2200	3010		
TD	3010			

USE ADDITIONAL SHEETS, IF NECESSARY, TO COMPLETE WELL RECORD.

Date Received

H. E. Melvin
Signature

H. E. Melvin

District Clerk

Title

1-16-78

Date