

**KANSAS DRILLERS LOG**

S. 29 T. 26S R. 34 ~~XX~~ W  
Loc. 1250' FSL & 1470' FWL, SW 1/4  
County Finney

API No. 15 — 055 — 20,263  
County Number

Operator  
Helmerich & Payne, Inc.

Address  
P.O. Box 558, Garden City, Kansas 67846

Well No. 1 Lease Name Jones "I"

Footage Location  
1250 feet from ~~XX~~(S) line 1470 feet from ~~XX~~(W) line

Principal Contractor Gabbert-Jones, Inc. Geologist Joe Blair

Spud Date 7-23-77 Total Depth 2960 P.B.T.D. (Bridge 2934 Plug)

Date Completed 10-6-77 Purchaser Gas Colorado Interstate Gas Co.

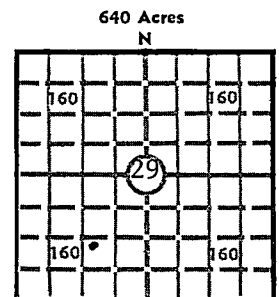

Elev.: Gr. 2987  
DF 2990 KB 2992

**CASING RECORD**

Report of all strings set— surface, intermediate, production, etc.

Purpose of string	Size hole drilled	Size casing set (in O.D.)	Weight lbs/ft.	Setting depth	Type cement	Sacks	Type and percent additives
Surface	12 1/4"	8-5/8"	28#	800	35-65 Pozmix Class H	350 150	6% Gel, 2% CaCl 3% CaCl
Production	7-7/8"	4 1/2"	10.5#	2959	Liteweight 50-50 Pozmix	700 100	10% Gilsonite 18% Salt

**LINER RECORD**

**PERFORATION RECORD**

Top, ft.	Bottom, ft.	Sacks cement	Shots per ft.	Size & type	Depth interval
None			2	1/2" Omega Jet	2939-2944
			2	1/2" Omega Jet	2912-2916
			2	1/2" Omega Jet	2894-2902

**TUBING RECORD**

**ACID, FRACTURE, SHOT, CEMENT SQUEEZE RECORD**

Amount and kind of material used	Depth interval treated
500 gal 15% HCl (Set cast iron plug @ 2934)	2939-2944'
Spearhead w/3500 gal 15% HCl w/120 ball sealers, frac w/100,000 gal fresh water & 66,800# 16-30 river sand	2813-2916

**INITIAL PRODUCTION**

Date of first production 12-22-77	Producing method (flowing, pumping, gas lift, etc.) Flowing				
RATE OF PRODUCTION PER 24 HOURS	Oil 0 bbls.	Gas 950 MCF	Water 35 bbls.	Gas-oil ratio ---	CFPB
Disposition of gas (vented, used on lease or sold) Sold-Colorado Interstate Gas Co.			Producing interval(s) 2813-2916		

INSTRUCTIONS: As provided in KCC Rule 82-2-125, within 90 days after completion of a well, one completed copy of this Drillers Log shall be transmitted to the State Geological Survey of Kansas, 4150 Monroe Street, Wichita, Kansas 67209. Copies of this form are available from the Conservation Division, State Corporation Commission, 3830 So. Meridian (P.O. Box 17027), Wichita, Kansas 66217. Phone AC 316-522-2206. If confidential custody is desired, please note Rule 82-2-125. Drillers Logs will be on open file in the Oil and Gas Division, State Geological Survey of Kansas, Lawrence, Kansas 66044.

Operator  
Helmerich & Payne, Inc.

DESIGNATE TYPE OF COMP.: OIL, GAS,  
DRY HOLE, SWDW, ETC.:  
Gas Well

Well No.  
1

Lease Name  
Jones "I"

S 29 T 26S R 34 <sup>XX</sup>  
W

**WELL LOG**

Show all important zones of porosity and contents thereof; cored intervals, and all drill-stem tests, including depth interval tested, cushion used, time tool open, flowing and shut-in pressures, and recoveries.

SHOW GEOLOGICAL MARKERS, LOGS RUN,  
OR OTHER DESCRIPTIVE INFORMATION.

FORMATION DESCRIPTION, CONTENTS, ETC.	TOP	BOTTOM	NAME	DEPTH
Herrington-Gas	2529	2586	Base Stone	
Winfield - Gas	2586	2644	Corral	1892
Fort Riley-Gas	2644	2752	Herrington	2529
Council-Grove-Gas	2806	2960	Winfield	2586
TD	2960		Ft. Riley	2644
No coring or open hole testing.			Florence	2752
			Council Grove	2806
			TD	2960
			Gamma Ray Neutron Log	1500-2952'

USE ADDITIONAL SHEETS, IF NECESSARY, TO COMPLETE WELL RECORD.

Date Received

*W. E. Spencer*  
Signature

District Production Superintendent

Title

9-29-78

Date

29-26-34W

Kansas Drillers Log Page 2

Operator Helmerich & Payne, Inc.		Type of Completion Gas Well
Well No. 1	Lease Name Jones "I"	

S 29 T 26S R 34 W

Perforation Record

Shots per ft.	Size & Type	Depth Interval
2	1/2" Omega Jet	2872-2882
2	1/2" Omega Jet	2834-2852
2	1/2" Omega Jet	2825-2829
2	1/2" Omega Jet	2813-2818

ACID, FRACTURE, SHOT, CEMENT SQUEEZE RECORD

Amount and kind of material used	Depth interval treated