

State Geological Survey

WICHITA BRANCH

KANSAS DRILLERS LOG

15-093-20518

API No. 15 — 093 — 20,518
County Number

S. 15 T. 26 R. 35 ^K/_W
Loc. 1450' FSL & 1250' FWL SW

Operator
Helmerich & Payne, Inc.

County Kearny

Address
P. O. Box 558 Garden City, Kansas 67846

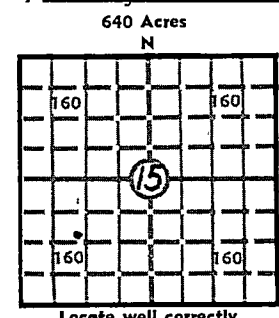

Well No. 1 Lease Name C. B. & L. "C"

Footage Location
1450 feet from (N) (S) line 1250 feet from (E) (W) line

Principal Contractor Gabbert-Jones, Inc. Geologist Joseph G. Blair

Spud Date 5/14/78 Total Depth 2955' P.B.T.D. 2953

Elev.: Gr. 3006

Date Completed 6/29/78 Oil Purchaser Colorado Interstate Gas Co.

DF 3009 KB 3011

CASING RECORD

Report of all strings set — surface, intermediate, production, etc.

Purpose of string	Size hole drilled	Size casing set (in O.D.)	Weight lbs/ft.	Setting depth	Type cement	Sacks	Type and percent additives
Surface	12 1/2"	8 5/8"	28#	815'	Howcolite Class H	350 150	2% CaCl, 1/4#/sk Flocele 3% CaCl
Production	7 7/8"	5 1/2"	14#	2954'	Howcolite 50-50 Pozmix	575 100	1/4#/sk Flocele 18% salt

LINER RECORD

PERFORATION RECORD

Top, ft.	Bottom, ft.	Sacks cement	Shots per ft.	Size & type	Depth interval
None			2	1/2" Omega Jet	2921-2930'
			2	1/2" Omega Jet	2912-2915'
			2	1/2" Omega Jet	2894-2898'

TUBING RECORD

Size	Setting depth	Packer set at
2 3/8"	2947'	None

ACID, FRACTURE, SHOT, CEMENT SQUEEZE RECORD

Amount and kind of material used	Depth interval treated
750 gal. 15% HCl w/26 ball sealers	2921-2930'
Spearhead w/3500 gal. 15% HCl w/140 ball sealers	2793-2930'
Frac w/103,150 gal. fresh water, 40,000# 100 mesh sand and 150,000# 16-30 sand	2793-2930'

INITIAL PRODUCTION

SEE ATTACHED CONTINUATION

Date of first production _____ Producing method (flowing, pumping, gas lift, etc.) Flowing

RATE OF PRODUCTION PER 24 HOURS
Oil -0- bbls. Gas 5200 MCF Water 24 bbls. Gas-oil ratio _____ CFPB

Disposition of gas (vented, used on lease or sold) Sold-Colorado Interstate Gas Co. Producing interval (s) 2921-30', 2912-15', 2894-98', 2871-82', 2852-60', 2823-30', 2813-18', 2806-09', 2793-98'

INSTRUCTIONS: As provided in KCC Rule 82-2-125, within 90 days after completion of a well, one completed copy of this Drillers Log shall be transmitted to the State Geological Survey of Kansas, 4150 Monroe Street, Wichita, Kansas 67209. Copies of this form are available from the Conservation Division, State Corporation Commission, 3830 So. Meridian (P.O. Box 17027), Wichita, Kansas 66217. Phone AC 316-522-2206. If confidential custody is desired, please note Rule 82-2-125. Drillers Logs will be on open file in the Oil and Gas Division, State Geological Survey of Kansas, Lawrence, Kansas 66044.

Operator

Helmerich & Payne, Inc.

DESIGNATE TYPE OF COMP.: OIL, GAS, DRY HOLE, SWDW, ETC.:

Gas Well

Well No.

1

Lease Name

C.B. & L. "C"

S. 15 T. 26 S. R. 35 W

WELL LOG

Show all important zones of porosity and contents thereof; cored intervals, and all drill-stem tests, including depth interval tested, cushion used, time tool open, flowing and shut-in pressures, and recoveries.

SHOW GEOLOGICAL MARKERS, LOGS RUN, OR OTHER DESCRIPTIVE INFORMATION.

FORMATION DESCRIPTION, CONTENTS, ETC.	TOP	BOTTOM	NAME	DEPTH
Sand-redbed	0	552	Herrington	2500'
Sand-blue clay	552	828	Winfield	2558'
Sand-redbed	828	2392	U. Ft. Riley	2608'
Shale	2392	2562	L. Ft. Riley	2655'
Shale-lime	2562	2955	Wreford	2760'
TD	2955'		Council Grove	2790'
			"A" zone	2802'
			"B" zone	2852'
			"C" zone	2872'
			"D" zone	2893'
			"F" zone	2923'
			DTD	2955'
			Gamma Ray Neutron Log	1500-2954'

USE ADDITIONAL SHEETS, IF NECESSARY, TO COMPLETE WELL RECORD.

Date Received

M. E. Spencer
Signature

District Production Superintendent

Title

August 18, 1978

Date

15-26-35W

C.B. & L. "C" #1, Continuation

PERFORATION RECORD

SHOTS PER FOOT	SIZE & TYPE	DEPTH INTERVAL
2	1/2" Omega Jet	2871-2882'
2	1/2" Omega Jet	2852-2860'
2	1/2" Omega Jet	2823-2830'
2	1/2" Omega Jet	2813-2818'
2	1/2" Omega Jet	2806-2809'
2	1/2" Omega Jet	2793-2798'

