

IMPORTANT
 Kans. Geo. Survey request
 samples on this well.

15-093-20454

KANSAS DRILLERS LOG

API No. 15 — 093 County — 20,454 Number

Operator
Helmerich & Payne, Inc.

Address
P. O. Box 558 Garden City, Kansas 67846

Well No. #9 Lease Name Citizens' Bldg., & Loan "B"

Footage Location
1350 feet from XX (S) line 1350 feet from XX (W) line

Principal Contractor Gabbert-Jones, Inc. Geologist Joe Blair

Spud Date 9-18-77 Total Depth 3004 P.B.T.D. 2956

Date Completed 1-11-78 Purchaser Gas
Colorado Interstate Gas Co.

S. 34 T. 26 R. 24 ³⁵ ~~W~~ ^E W
 Loc. 1350' FWL & 1350' FSL
 County Kearny

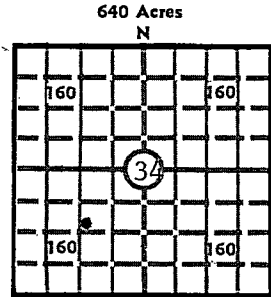

Elev.: Gr. 3022
 DF 3025 KB 3027

CASING RECORD

Report of all strings set — surface, intermediate, production, etc.

Purpose of string	Size hole drilled	Size casing set (in O.D.)	Weight lbs/ft.	Setting depth	Type cement	Sacks	Type and percent additives
Surface	12 1/4"	8-5/8"	28#	804	Howcolite Class H	350 150	2% CaCl, 1/4# Flocele/sk 3% CaCl
Production	7-7/8"	5 1/2"	14#	3003	Howcolite 50-50 Pozmix	575 100	10% Gilsonite 2% gel, 18% salt

LINER RECORD

PERFORATION RECORD

Top, ft.	Bottom, ft.	Sacks cement	Shots per ft.	Size & type	Depth interval
None			2	1/2" Omega jet	2965-72'
TUBING RECORD			2	1/2" Omega jet	2939-45
			2	1/2" Omega jet	2919-28, 2898-2906, 2851-82 & 2838-43

ACID, FRACTURE, SHOT, CEMENT SQUEEZE RECORD

Amount and kind of material used	Depth interval treated
750 gallons 15% HCl w/20 ball sealers	2965-72
Set retainer @ 2956' and squeezed w/100 sx Class H	2965-72
750 gallons 15% HCl w/20 ball sealers (Record of Frac attached)	2939-45

INITIAL PRODUCTION

Date of first production <u>3-19-78</u>		Producing method (flowing, pumping, gas lift, etc.) <u>Flowing</u>			
RATE OF PRODUCTION PER 24 HOURS	Oil <u>None</u>	Gas <u>1210</u> bbls.	Water <u>12</u> MCF	Gas-oil ratio	CFPB
Disposition of gas (vented, used on lease or sold) <u>Sold-Colorado Interstate Gas Co.</u>			Producing interval(s) <u>Council Grove D 2939-45, C 2919-28, B 2898-2906, A 2851-82 & 2838-43</u>		

INSTRUCTIONS: As provided in KCC Rule 82-2-125, within 90 days after completion of a well, one completed copy of this Drillers Log shall be transmitted to the State Geological Survey of Kansas, 4150 Monroe Street, Wichita, Kansas 67209. Copies of this form are available from the Conservation Division, State Corporation Commission, 3830 So. Meridian (P.O. Box 17027) Wichita, Kansas 66217. Phone AC 316-522-2206. If confidential custody

Well No.
9

Lease Name
Citizens Building & Loan "B"

S 34 T 26 R 35 W E
W

WELL LOG

Show all important zones of porosity and contents thereof; cored intervals, and all drill-stem tests, including depth interval tested, cushion used, time tool open, flowing and shut-in pressures, and recoveries.

SHOW GEOLOGICAL MARKERS, LOGS RUN, OR OTHER DESCRIPTIVE INFORMATION.

FORMATION DESCRIPTION, CONTENTS, ETC.	TOP	BOTTOM	NAME	DEPTH
Sand-Shale	0	641	Base-Stone	
Sand	641	815	Corral	1894
Shale	815	898	Herrington	2553
Redbed-Shale	898	1567	Winfield	2611
Sand-Shale	1567	2137	Ft Riley	2666
Lime-Shale	2137	2259	Florence	2774
Shale-Lime	2259	2610		
Limē=Shale	2610	3004		
Total Depth	3004		Wreford	2810
No. drill stem testing or coring this well.			Council Grove	2831
			DTD	3004
			LTD	2999
			Gamma Ray Neutron Log	1500-2999

USE ADDITIONAL SHEETS, IF NECESSARY, TO COMPLETE WELL RECORD.

Date Received

W. E. Spencer
Signature

District Production Superintendent
Title

August 14, 1978
Date

34-26-35w

Citizens Building & Loan "B" No. 9
Helmerich & Payne, Inc.
Sec. 34-T26S-R35W, Kearny County, Kansas

Fracture Record

Amount & Kind of Material Used	Depth Interval Treated
Spearhead w/3500 gal 15% HCL w/140 ball sealers	2838-2945
Frac w/100,000 gal slick water & 200,000# 16-30 river sd	2839-2945