

22-26-38W

JUL 18 1973

State Geological Survey  
WICHITA, BRANCH

KANSAS DRILLERS LOG

S. 22 T. 26 R. 38 W  
Loc. 1250' FSL x 2590' FWL  
County Kearny

API No. 15 - 093 - 20,066  
County Number

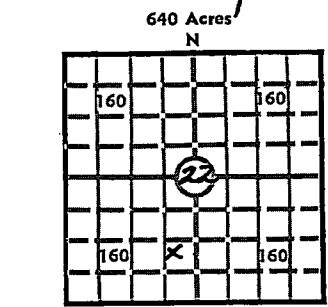

Locate well correctly  
Elev.: Gr. 3205  
DF \_\_\_\_\_ KB \_\_\_\_\_

Operator  
Amoco Production Company

Address  
P.O. Box 432 - Liberal Ks. 67901

Well No. 2 Lease Name Reynold Gas Unit

Footage Location  
1250 feet from (S) line 2590 feet from (W) line

Principal Contractor Service Drilling Company Geologist \_\_\_\_\_

Spud Date 5-5-73 Total Depth 2895 P.B.T.D. 2894

Date Completed 6-7-73 Oil Purchaser \_\_\_\_\_

CASING RECORD

Report of all strings set— surface, intermediate, production, etc.

Purpose of string	Size hole drilled	Size casing set (in O.D.)	Weight lbs/ft.	Setting depth	Type cement	Sacks	Type and percent additives
Surface	12 1/4	8 5/8	23	702	Class A	650	3% Cacl.
Production	7 7/8	5 1/2	14	2895	Special	700	18% Cacl.

LINER RECORD

PERFORATION RECORD

Top, ft.	Bottom, ft.	Sacks cement	Shots per ft.	Size & type	Depth interval
			2	1/2	2794 - 2803
TUBING RECORD					2704 - 14, 2722 - 24
					2734 - 38, 2756 - 62
					2772 - 83

ACID, FRACTURE, SHOT, CEMENT SQUEEZE RECORD

Amount and kind of material used	Depth interval treated
<u>Acidize w/1500 Gal. 15%</u>	<u>2794 - 2803</u>
<u>Spearhead w/2500 Gal. 15% . Frac w/100,000 Gal</u>	<u>2704 - 2803</u>
<u>Water and 100,000 # Sand</u>	

INITIAL PRODUCTION

Date of first production 6-7-73 Producing method (flowing, pumping, gas lift, etc.) Flowing

RATE OF PRODUCTION PER 24 HOURS  
Oil \_\_\_\_\_ Gas 11,000 MCF Water \_\_\_\_\_ Gas-oil ratio \_\_\_\_\_ CFPB \_\_\_\_\_

Disposition of gas (vented, used on lease or sold) Waiting on pipeline connection Producing interval (s) 2704 - 2803

INSTRUCTIONS: As provided in KCC Rule 82-2-125, within 90 days after completion of a well, one completed copy of this Drillers Log shall be transmitted to the State Geological Survey of Kansas, 4150 Monroe Street, Wichita, Kansas 67209. Copies of this form are available from the Conservation Division, State Corporation Commission, 3830 So. Meridian (P.O. Box 17027), Wichita, Kansas 66217. Phone AC 316-522-2206. If confidential custody is desired, please note Rule 82-2-125. Drillers Logs will be on open file in the Oil and Gas Division, State Geological Survey of Kansas, Lawrence, Kansas

DESIGNATE TYPE OF COMPLETION: OIL, GAS, DRY HOLE, SWDW, ETC.:

Gas

Well No.

2

Lease Name

Rexroad Gas Unit

S 22 T 26 R 38 E W

WELL LOG

Show all important zones of porosity and contents thereof; cored intervals, and all drill-stem tests, including depth interval tested, cushion used, time tool open, flowing and shut-in pressures, and recoveries.

SHOW GEOLOGICAL MARKERS, LOGS RUN, OR OTHER DESCRIPTIVE INFORMATION.

FORMATION DESCRIPTION, CONTENTS, ETC.	TOP	BOTTOM	NAME	DEPTH
Sand	0	570	Radioactivity	1302-2892
Sand - Red Bed	570	702		
Red Bed - Sand	702	1202		
Sand	1202	1442		
Shale	1442	1739		
Shale - Sand	1739	2228		
Lime - Shale	2228	2895		
		T.D.		

Test Info:

24 Hr. SIP 212<sup>#</sup>

20 Min. Open Flow 11.0 MMCFD

Log Tops:

Co Cr 2698

USE ADDITIONAL SHEETS, IF NECESSARY, TO COMPLETE WELL RECORD.

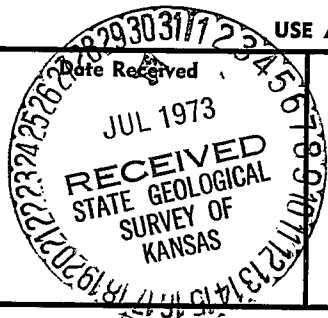

Signature

J.W. Vaughn

Title

Area Administrative Supervisor

Date