

Cowley

KANSAS

SECTION 36 TOWNSHIP 31S RANGE 6E

WELL NO. #6- Brooks

COMPANY Ayesh Oil

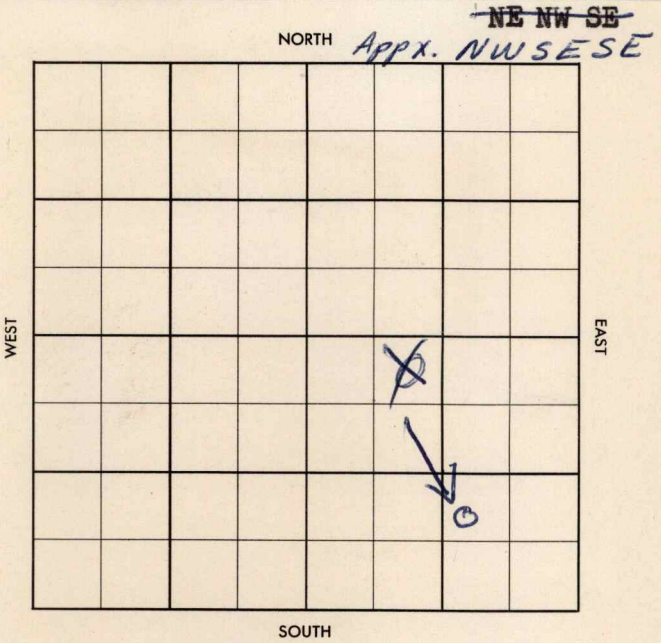

AM 2031  
 Mr. Peckham Oil  
 Frank H. ...  
 AM 5232 CORRECTION

FORM 518 SUNRAY

County Cowley Elev. 1402  
 Sec. 36 Twp. 31 Rge. 6E  
 Company Ayesh Oil  
 Farm Name Brooks No. 6

TOPS	DEPTH	LOG	DATUM
Anh.			
Tp. <u>stain</u>	<u>1752</u>		
H.			
Tr.			
Dg.			
BL.			
L.	<u>1911</u>		
K.C.			
B.K.C. <u>Lay</u>	<u>2131</u>		
Ce. <u>Lay</u> sd	<u>2190</u>		
C.			
M.			
M.			
K.			
Mz.			
Ma.			
V.			
S.			
S.			
A.			
R.			
Pe.			
G.			
T.D.	<u>2250</u>		

APP. NWSESE  
 Loc. in Sec. NE NW SE  
300  
900 SL  
1150 EL

Geol. \_\_\_\_\_  
 Contr. \_\_\_\_\_  
 Hallmark \_\_\_\_\_  
 Pool Burden  
Estes Townsite

COMPLETE  
 AUG 28 '57

Date Comm. 7-22-57  
8" @ 200/175 WOC JUL 31 '57

crd 2180-94 <sup>2212</sup> AUG 8 '57 corr. core int. Full rec  
 Lay 2131 Lay sd 2190  
<sup>RTD 1,2,30</sup>  
4 1/2 c 2249/100 MICT CO 2222  
 AUG 1 '57 X spot correction

(in SE 40 Acres) PF many  
 zn. to Mine Sale Tools 57.5  
 in and Re PF AUG 21 '57 AUG 28 '57 X sd  
 MICT CO 2240 16/2204  
 08 no tst SQ CO 2230 12/

Co.  
 Sec.  
 No.  
 Sec.  
 T.  
 R.

2200-03 test 550 nat. Bd oil  
Frac 900# sd x 900 oil Psp. P.  
Ld. complete 25 Bopd +  
wt.

Lay sd. PF. 2200-03

RTD 2250

PDTD 2230

County Cowley Elev. \_\_\_\_\_  
 Sec. 36 Twp. 31 Rge. 6E  
 Company Ayesh Oil  
 Farm Name Brooks No. 6

TOPS	DEPTH	LOG	DATUM
Anh.			
Tp.			
H.			
Tr.			
Dg.			
Bl.			
L.			
K.C.			
B.K.C.			
Ce.			
C.			
M.			
M.			
K.			
Mz.			
Mq.			
V.			
S.			
S.			
A.			
R.			
Pe.			
G.			
T.D.			

Loc. in Sec. \_\_\_\_\_  
 NE NW SE  
*Burden*  
*Townsite*  
 Geol. \_\_\_\_\_  
 Contr. \_\_\_\_\_  
 Hallmark  
 Pool  
 Estes



Date Comm. 7-22-57  
8" @ 200/175 WOC

*30*

Co.  
Lse.  
No.  
Sec.  
T.  
R.