

Section 9 Township 20 Range 24 W

Well No. # 1 McCreight

Company D. R. Lauck

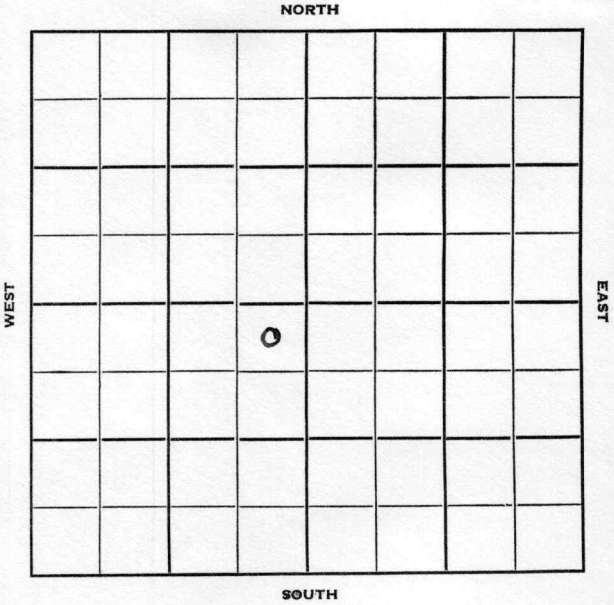

Ness

KANSAS

Sec. 9 Twp. 20 R. 24 W ✓

Well No. # 1 McCreight Farm

D. R. Lauck Company

Lauck Contractor

Wildcat

330 Ft. from N. Line

..... Ft. from S. Line

330 Ft. from E. Line

..... Ft. from W. Line

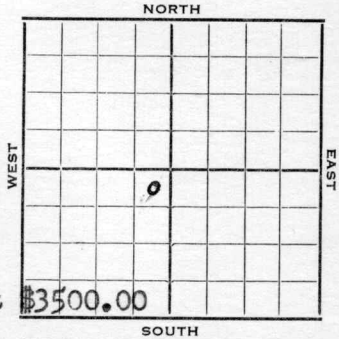

NE NE SW

Texas & Sinclair support \$3500.00

1952	Elev. 2340' REPORT
3/26	Moving In
4/1	8" @ 188' Drlg. 3120'
4/9	Heeb. 3771 Lans. 3817 Drlg. 4340 in Marm.
4/23	Spud 3-26-52 D&A TD 4528 8" @ 188 Heeb. 3771 Lans. 3817 Cong. 4372 Miss 4402 DST 4402-12 open 1 hr. rec. 6' ocm Miss 4415 DST 4419-30 open 1 hr. rec. 65' oil 50' hocm 60' sw TD 4528 5" @ 4520 Schl. tops: Heeb. 3731 Lans. 3810 Cong. 4365 Miss. 4394 20/ 4418-22 B/ 24 gfph 40% wtr. 250 A S/ 53 bw 3 hr. PB 4338 12/ 4314-17 500 A S/ 27 bw 3 hr. D&A

ABANDONED

