

PL

KANSAS

11-11-11E

WELL COMPLETION REPORT AND DRILLER'S LOG

API No. 15 — 197 — 20,112
County Number

S. 11 T. 11 R. 11 E
Loc. ~~NWSE~~ 100' E of NWNWSE
County Wabaunsee

Operator
Tutcher Oil & Gas Co.

Address
Box 308 Overbrook, Ks. 66524

Well No. #1 Lease Name Stahl Estate

Footage Location
2310' feet from (S) line 2210' feet from (E) line

Principal Contractor Geologist
Glacier Petroleum Co., Inc. John E. Hickox

Spud Date Date Completed Total Depth P.B.T.D.
7-18-80 7-24-80 1965' 2965 -

Directional Deviation Oil and/or Gas Purchaser

State Geological Survey
WICHITA BRANCH

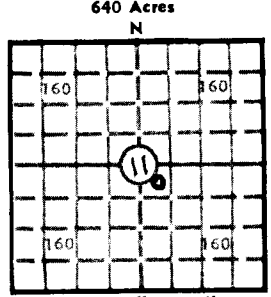

Locate well correctly
Elev.: Gr. 1122'
DF KB 1127

CASING RECORD

Report of all strings set — surface, intermediate, production, etc.

Purpose of string	Size hole drilled	Size casing set (in O.D.)	Weight lbs/ft.	Setting depth	Type cement	Sacks	Type and percent additives
Surface	12-1/4"	8-5/8"		212'	Portland	110	3% CaCl ₂

LINER RECORD

PERFORATION RECORD

Top, ft.	Bottom, ft.	Sacks cement	Shots per ft.	Size & type	Depth interval
-			-		

Size	Setting depth	Packer set at
-		

ACID, FRACTURE, SHOT, CEMENT SQUEEZE RECORD

Amount and kind of material used	Depth interval treated
-	

INITIAL PRODUCTION

Date of first production D & A 7-24-80 Producing method (flowing, pumping, gas lift, etc.) -

RATE OF PRODUCTION PER 24 HOURS	Oil bbls.	Gas MCF	Water bbls.	Gas-oil ratio CFPB

Disposition of gas (vented, used on lease or sold) Producing interval(s)

INSTRUCTIONS: As provided in KCC Rule 82-2-125, within 90 days after completion of a well, one completed copy of this Drillers Log shall be transmitted to the State Geological Survey of Kansas, 4150 Monroe Street, Wichita, Kansas 67209. Copies of this form are available from the Conservation Division, State Corporation Commission, 245 No. Water, Wichita, Kansas 67202. Phone AC 316-522-2206. If confidential custody is desired, please note Rule 82-2-125. Drillers Logs will be on open file in the Oil and Gas Division, State Geological Survey of Kansas, Lawrence, Kansas 66044.

Operator Tutchter Oil & Gas Co.

DESIGNATE TYPE OF COMP.: OIL, GAS,
DRY HOLE, SWDW, ETC.: Dry hole

Well No. 1 Lease Name Stahl Estate

S ~~11~~ T ~~11~~ R ~~11~~ ^E₂₃

WELL LOG

Show all important zones of porosity and contents thereof; cored intervals, and all drill-stem tests, including depth interval tested, cushion used, time tool open, flowing and shut-in pressures, and recoveries.

SHOW GEOLOGICAL MARKERS, LOGS RUN, OR OTHER DESCRIPTIVE INFORMATION.

FORMATION DESCRIPTION, CONTENTS, ETC.	TOP	BOTTOM	NAME	DEPTH
Lime and shale	600	624		
Lime and shale	624	978	Topeka	624
Sand, lime, and shale	978	1180		
Lime	1180	1315	Lansing	1180
Lime	1315	1537	Kansas City	1315
Shale and lime	1537	1749	Base Kansas City	1537
Shale	1749	2186	Cherokee	1749
Lime, dolomite, and chert	2186	2349	Mississippian	2186
Shale	2349	2599	Kinderhook	2349
Dolomite	2599	2870	Hunton	2599
Shale and dolomite	2870	2935	Maquoketa	2870
Dolomite	2935	2965	Viola	2935
		TD		
			NSO or Gas	

USE ADDITIONAL SHEETS, IF NECESSARY, TO COMPLETE WELL RECORD.

Date Received

John E. Hickox
 Signature
 John E. Hickox
 Title
 Geologist
 9-23-80
 Date

11-11-80

PL

DRILLERS LOG
State Geological Survey
WICHITA, BRANCH

S. 12 T. 11 S R. 11 E

Loc. NW SE
County Wabaunsee

API No. 15 - 197 - 20,112
County Number

Operator
Tutcher Oil & Gas

Address
P. O. Box 308 Overbrook, Kansas 66524

Well No. 1 Lease Name Stahl

Footage Location
feet from (N) (S) line feet from (E) (W) line

Principal Contractor: Glacier Drilling Company, Inc. Geologist: John Hickox

Spud Date: 07-18-80 Total Depth: 2965' P.B.T.D.

Date Completed: 07-24-80 Oil Purchaser

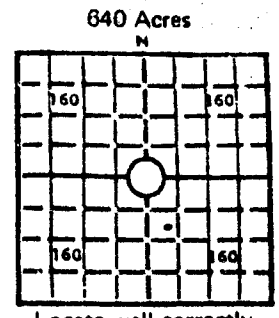

640 Acres
N
Locate well correctly
Elev.: Gr. 1122
DF KB 2970'

CASING RECORD

Report of all strings set—surface, intermediate, production, etc.

Purpose of string	Size hole drilled	Size casing set (in O.D.)	Weight lbs/ft.	Setting depth	Type cement	Sacks	Type and percent additives
SURFACE		8-5/8"		213'		110	
PRODUCTION							

WELL LOG

Show all important zones of porosity and contents thereof; cored intervals, and all drill-stem tests, including depth interval tested, cushion used, time tool open, flowing and shut-in pressures, and recoveries.

Formation	Top	Btm.	Formation	Top	Btm.	Formation	Top	Btm.
Soil	0	3						
Shale	3	113						
Lime	113	116						
Shale little lime	116	267						
Lime & shale	267	457						
Shale w/lime stk	457	1154						
Lime lansing	1154	1319						
Lime KC	1319	1437						
Shale w/lime	1437	2186						
Lime Miss.	2186	2599						
Hunton	2685	2754						
Lime	2754	2923						
Viola	2923	2965						
RTD		2965						