

KANSAS State Geological Survey  
**DRILLERS LOG**  
 WICHITA, BRANCH

**IMPORTANT**  
 Kans. Geo. Survey request  
 samples on this well.

S. 31 T. 11 R. 9 <sup>E</sup>/<sub>W</sub>  
 Loc. 1650 FWL 1250 FWL SW/4  
 County Riley

API No. 15 — 161 — 20,020  
 County Number

Operator  
Little George Oil Company

Address 225 Sutton Place  
Wichita, Kansas 67202

Well No. #1 Lease Name Hess

Footage Location  
 feet from (N) (S) line \_\_\_\_\_ feet from (E) (W) line \_\_\_\_\_

Principal Contractor Berentz Drilling Geologist Earl Brandt

Spud Date 5-3-74 Total Depth 1940 P.B.T.D. \_\_\_\_\_

Date Completed 5-7-74 Oil Purchaser \_\_\_\_\_

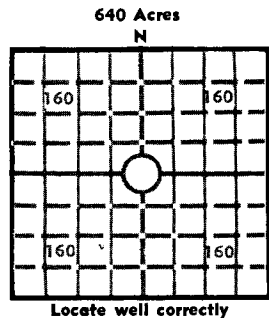

Elev.: Gr. \_\_\_\_\_  
 DF \_\_\_\_\_ KB 1465

**CASING RECORD**

Report of all strings set — surface, intermediate, production, etc.

Purpose of string	Size hole drilled	Size casing set (in O.D.)	Weight lbs/ft.	Setting depth	Type cement	Sacks	Type and percent additives
Surface		8 5/8		98'		70	

**LINER RECORD**

**PERFORATION RECORD**

Top, ft.	Bottom, ft.	Sacks cement	Shots per ft.	Size & type	Depth interval

**TUBING RECORD**

Size	Setting depth	Packer set at

**ACID, FRACTURE, SHOT, CEMENT SQUEEZE RECORD**

Amount and kind of material used	Depth interval treated

**INITIAL PRODUCTION**

Date of first production \_\_\_\_\_ Producing method (flowing, pumping, gas lift, etc.) \_\_\_\_\_

RATE OF PRODUCTION PER 24 HOURS	Oil	Gas	Water	Gas-oil ratio
	bbls.	MCF	bbls.	CFPB

Disposition of gas (vented, used on lease or sold) \_\_\_\_\_ Producing interval(s) \_\_\_\_\_

INSTRUCTIONS: As provided in KCC Rule 82-2-125, within 90 days after completion of a well, one completed copy of this Drillers Log shall be transmitted to the State Geological Survey of Kansas, 4150 Monroe Street, Wichita, Kansas 67209. Copies of this form are available from the Conservation Division, State Corporation Commission, 3830 So. Meridian (P.O. Box 17027), Wichita, Kansas 66217. Phone AC 316-522-2206. If confidential custody is desired, please note Rule 82-2-125. Drillers Logs will be on open file in the Oil and Gas Division, State Geological Survey of Kansas, Lawrence, Kansas 66044.

Operator m Little George Oil Co. DESIGNATE TYPE OF COMP.: OIL, GAS, DRY HOLE, SWDW, ETC.:

Well No. 1 Lease Name Hess

S 31 T 11 R 9W E W

**WELL LOG**

Show all important zones of porosity and contents thereof; cored intervals, and all drill-stem tests, including depth interval tested, cushion used, time tool open, flowing and shut-in pressures, and recoveries.

SHOW GEOLOGICAL MARKERS, LOGS RUN, OR OTHER DESCRIPTIVE INFORMATION.

FORMATION DESCRIPTION, CONTENTS, ETC.	TOP	BOTTOM	NAME	DEPTH
No tests - no log.				
Sample tops:				
Hb	1180	+285		
L	1342	+123		
KC	1441	+24		
Stk	1587	-122		
B/KC	1679	-214		
ChSd	1815	-350		
K	1838	-373		
H	1919	-454		
RTD	1940	-475		



USE ADDITIONAL SHEETS, IF NECESSARY, TO COMPLETE WELL RECORD.

Date Received	<i>Donald J. Malone</i> Signature
	Exploration Mgr. Title
	5-8-74 Date