

8-12-21E81

STATE CORPORATION COMMISSION OF KANSAS  
OIL & GAS CONSERVATION DIVISION

WELL COMPLETION OR RECOMPLETION FORM  
ACO-1 WELL HISTORY

DESCRIPTION OF WELL AND LEASE

Operator: license # ... KCC # 4366  
name ... J. & D. Drilling Co.  
address ... P.O. B. x. 392  
City/State/Zip Tonganoxie, KS 66086



Operator Contact Person John Brewer  
Phone ... (913) 845-2407

Factor: license # ... 174  
name ... Brewer, Inc.

Wellsite Geologist Dean O. Sharpe  
Phone ... (913) 674-3686

PURCHASER Mason Greenhouse

Designate Type of Completion  
 New Well  Re-Entry  Workover

- Oil  SWD  Temp Abd
- Gas  Inj  Delayed Comp.
- Dry  Other (Core, Water Supply etc.)

If OWWO: old well info as follows:

Operator  
Well Name  
Comp. Date Old Total Depth

WELL HISTORY

Drilling Method:  Mud Rotary  Air Rotary  Cable

9/85 9/6/85 9/27/85  
Spud Date Date Reached TD Completion Date

800' PBT  
Total Depth

Amount of Surface Pipe Set and Cemented at 40 feet

Multiple Stage Cementing Collar Used?  Yes  No

If Yes, Show Depth Set feet

If alternate 2 completion, cement circulated from 797 feet depth to surface w/ 111 SX cmt

API NO. 15- 103-20,379  
County Leavenworth  
Sec 8 Twp 12 Rge 21

660 Ft North from Southeast Corner of Section  
4620 Ft West from Southeast Corner of Section  
(Note: locate well in section plat below)

Lease Name Greenwell Well# 1 KC-2

Field Name Irick Gas Field

Producing Formation Squirrel Sands

Elevation: Ground 903 KB

Section Plat

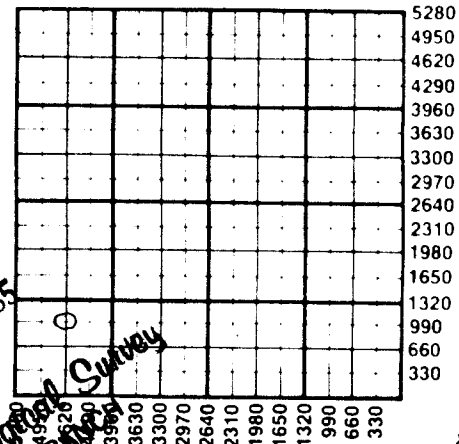

DFR 3 0 1985  
State Geological Survey  
WICHITA BRANCH

WATER SUPPLY INFORMATION

Source of Water:

Division of Water Resources Permit #

Groundwater (Well) Ft North From Southeast Corner a  
Ft. West From Southeast Corner  
Sec Twp Rge  East  West

Surface Water 4290 Ft North From Southeast Corner a  
(Stream, Pond etc.) 990 Ft West From Southeast Corn  
Sec 8 Twp 12 Rge 21  East  West

Other (explain) (purchased from city, R.W.D.#)

Disposition of Produced Water:  Disposal  Repressuring

Docket #

INSTRUCTIONS: This form shall be completed in duplicate and filed with the Kansas Corporation Commission, 200 Colorado Derby Building, Wichita, Kansas 67202, within 90 days after completion or recompletion of any well. Rules 82-3-130 and 82-3-107 apply.

Information on side two of this form will be held confidential for a period of 12 months if requested in writing and submitted with the form. See rule 82-3-107 for confidentiality in excess of 12 months.

One copy of all wireline logs and drillers time log shall be attached with this form. Submit CP-4 form with all plugged wells. Submit CP-111 form with all temporarily abandoned wells.

**SIDE TWO**

Operator Name J. & D. Drilling Co. Lease Name Greenwell Well# 1 SEC 8 TWP. 12 RGE. 21 81

East  
 West

**WELL LOG**

**INSTRUCTIONS:** Show important tops and base of formations penetrated. Detail all cores. Report all drill stem test giving interval tested, time tool open and closed, flowing and shut-in pressures, whether shut-in pressure reached static level, hydrostatic pressures, bottom hole temperature, fluid recovery, and flow rates if gas to surface during test. Attach extra sheet if more space is needed. Attach copy of log.

Drill Stem Tests Taken  Yes  No  
 Samples Sent to Geological Survey  Yes  No  
 Cores Taken  Yes  No

**Formation Description**  
 Log  Sample

Name	Top	Bottom
Base K.C.		47
Top of Nobtown sd	454	
Squirrel sd	676	708

<b>TUBING RECORD</b>		size	set at	packer at	Liner Run	<input type="checkbox"/> Yes	<input type="checkbox"/> No
Date of First Production	Producing method <input checked="" type="checkbox"/> flowing <input type="checkbox"/> pumping <input type="checkbox"/> gas lift <input type="checkbox"/> Other (explain) .....						
9/27/85							
Estimated Production Per 24 Hours	Oil	Gas	Water	Gas-Oil Ratio	Gravity		
	Bbls	133 MCF	Bbls	CFPB			

Disposition of gas:  vented  
 sold  
 used on lease

**METHOD OF COMPLETION**  
 open hole  perforation  
 other (specify) .....

Dually Completed.  
 Commingled

**PRODUCTION INTERVAL**  
 686-692

<b>CASING RECORD</b> <input type="checkbox"/> new <input type="checkbox"/> used							
Report all strings set - conductor, surface, intermediate, production, etc.							
Purpose of string	size hole drilled	size casing set (in O.D.)	weight lbs/ft.	setting depth	type of cement	# sacks used	type and percent additives
Surface Production	8 7/8"	7"	18 lbs.	40'	Common	36	none
	6 1/4"	2 7/8"	5 lbs.	798'	60/40 OMC	111	Portland 40% Gel. 2% Gilsonite 5%
<b>PERFORATION RECORD</b>				<b>Acid, Fracture, Shot, Cement Squeeze Record</b>			
shots per foot	specify footage of each interval perforated			(amount and kind of material used)			Depth
2	686-692 Top of the Squirrel						686