

State Geological Survey
WICHITA BRANCH

15-197-20060
34-13-12E

KANSAS DRILLERS LOG

API No. 15 —————
County Number

Operator
DUNNE EQUITIES, INC. 1707

Address
SUITE 140 260 NORTH ROCK ROAD WICHITA, KANSAS 67206

Well No. 2 Lease Name Stratton

Footage Location
1320 feet from (N) (S) line 1320 feet from (E) (W) line

Principal Contractor Jackman & Jackman Geologist Dean E. Seeber

Spud Date 7/6/76 Total Depth 3077' P.B.T.D.

Date Completed 7/13/76 Oil Purchaser D & A Plugged

S. 34 T. 13 R. 12 E
Loc. SW SW NE
County Wabunsee

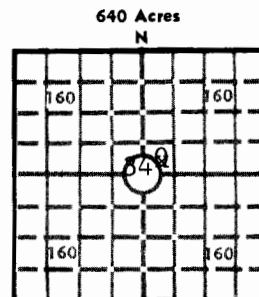

Locate well correctly
Elev.: Gr. 1356
DF KB

CASING RECORD

Report of oil strings set— surface, intermediate, production, etc.

Purpose of string	Size hole drilled	Size casing set (in O.D.)	Weight lbs/ft.	Setting depth	Type cement	Sacks	Type and percent additives
Surface	12½"	8 5/8"	used	127'	Comm	50	

LINER RECORD

PERFORATION RECORD

Top, ft.	Bottom, ft.	Sacks cement	Shots per ft.	Size & type	Depth interval

TUBING RECORD

Size	Setting depth	Packer set at

ACID, FRACTURE, SHOT, CEMENT SQUEEZE RECORD

Amount and kind of material used	Depth interval treated

INITIAL PRODUCTION

Date of first production D & A	Producing method (flowing, pumping, gas lift, etc.)
RATE OF PRODUCTION PER 24 HOURS	Oil bbls. Gas MCF Water bbls. Gas-oil ratio CFPB
Disposition of gas (vented, used on lease or sold)	Producing interval (s)

INSTRUCTIONS: As provided in KCC Rule 82-2-125, within 90 days after completion of a well, one completed copy of this Drillers Log shall be transmitted to the State Geological Survey of Kansas, 4150 Monroe Street, Wichita, Kansas 67209. Copies of this form are available from the Conservation Division, State Corporation Commission, 3830 So. Meridian (P.O. Box 17027), Wichita, Kansas 66217. Phone AC 316-522-2206. If confidential custody is desired, please note Rule 82-2-125. Drillers Logs will be on open file in the Oil and Gas Division, State Geological Survey of Kansas, Lawrence, Kansas 66044.

Operator		DESIGNATE TYPE OF COMP.: OIL, GAS, DRY HOLE, SWDW, ETC.:
Well No.	Lease Name	
S _____ T _____ R _____ E _____ W _____		

WELL LOG

Show all important zones of porosity and contents thereof; cored intervals, and all drill-stem tests, including depth interval tested, cushion used, time tool open, flowing and shut-in pressures, and recoveries.

SHOW GEOLOGICAL MARKERS, LOGS RUN,
OR OTHER DESCRIPTIVE INFORMATION.

FORMATION DESCRIPTION, CONTENTS, ETC.	TOP	BOTTOM	NAME	DEPTH
<p>USE ADDITIONAL SHEETS, IF NECESSARY, TO COMPLETE WELL RECORD.</p>				

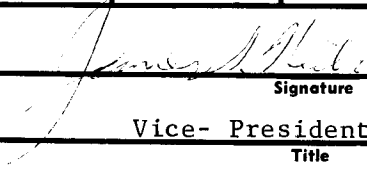
Date Received		
	Signature	
	Vice- President	
	Title	
	January 24, 1978	
	Date	

24-13-150

34-13-12E

WELL LOG

Company Dunne Equities Inc.
 Farm Stratton
 Well 2
 Location SW SW of NE 1/4 of 34 13 12 Wabunsee County, Kansas
 Commenced 7/6/76
 Completed 7/13/76
 Casing 127' of 6 5/8" cemented with 80 sacks
 Contractor Jackman & Jackman
 Production D & A
 Total Depth 3077'

	(clay)	
Soil & clay	0 -	6
Shale & shells	6	61
Shale & lime	61	128
Lime & shale	128	325
Shale & shells	325	1142
Lime	1142	1145
Sandy shale	1145	1292
Shale	1292	1307
Lime	1307	1409
Shale	1409	1464
Lime	1464	1681
Shale & shells	1681	2283
Lime	2283	2743
Shale	2743	2903
Lime	2903	3044
Shale	3044	3068
Lime	3068	3077

0' is 4' above ground level.