

21-13-23E

KANSAS DRILLERS LOG

S. 21 T. 13 R. 23E E
W
Loc. SE 1/4 NW 1/4 NW 1/4

API No. 15 — 091 — 20202
County Number

County Johnson

Operator BREUER, INC. (Art Swank, Landowner)

Address 1216 N. 155th Street, Basehor, Ks. 66007

Well No. 1 Lease Name Swank/Breuer

Footage Location 1,000 ft. N line 1,000 ft. W line
feet from (N) (S) line feet from (E) (W) line

Principal Contractor BREUER, INC. Geologist

Spud Date April 16, 1980 Total Depth 368 ft. P.B.T.D.

Date Completed April 18, 1980 Oil Purchaser

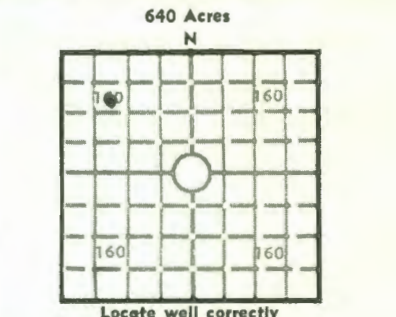

Elev.: Gr. _____

DF _____ KB _____

CASING RECORD

Report of all strings set — surface, intermediate, production, etc.

Purpose of string	Size hole drilled	Size casing set (in O.D.)	Weight lbs/ft.	Setting depth	Type cement	Sacks	Type and percent additives
Production	6"	4 1/2 OD	9 lb.	368	Neat T/B	30	None

LINER RECORD

PERFORATION RECORD

Top, ft.	Bottom, ft.	Sacks cement	Shots per ft.	Size & type	Depth interval

TUBING RECORD

Size	Setting depth	Packer set at
3/4" Steel	368 ft.	None

Bleeder Line ACID, FRACTURE, SHOT, CEMENT SQUEEZE RECORD

Amount and kind of material used	Depth interval treated

INITIAL PRODUCTION

Date of first production April 20, 1980 Producing method (flowing, pumping, gas lift, etc.)

RATE OF PRODUCTION PER 24 HOURS
Oil _____ Gas 20,000Cu. MCF Water _____ Gas-oil ratio _____ CFPB

Disposition of gas (vented, used on lease or sold) Private Residence Producing interval(s)

INSTRUCTIONS: As provided in KCC Rule 82-2-125, within 90 days after completion of a well, one completed copy of this Drillers Log shall be transmitted to the State Geological Survey of Kansas, 4150 Monroe Street, Wichita, Kansas 67209. Copies of this form are available from the Conservation Division, State Corporation Commission, 3830 So. Meridian (P.O. Box 17027), Wichita, Kansas 66217. Phone AC 316-522-2206. If confidential custody is desired, please note Rule 82-2-125. Drillers Logs will be on open file in the Oil and Gas Division, State Geological Survey of Kansas, Lawrence, Kansas 66044.

BREUER, INC.
1216 N. 155th Street
Basehor, Kansas 66007

21-13-23E

DESIGNATE TYPE OF COMP.: OIL, GAS,
DRY HOLE, SWDW, ETC.:

Operator	BREUER, INC. 1216 N. 155th Street Basehor, Kansas 66007		DESIGNATE TYPE OF COMP.: OIL, GAS, DRY HOLE, SWDW, ETC.:
Well No.	1	Lease Name	Art Swank
			GAS (PRIVATE RES.)
S	T	R	E W

WELL LOG

Show all important zones of porosity and contents thereof; cored intervals, and all drill-stem tests, including depth interval tested, cushion used, time tool open, flowing and shut-in pressures, and recoveries.

SHOW GEOLOGICAL MARKERS, LOGS RUN,
OR OTHER DESCRIPTIVE INFORMATION.

FORMATION DESCRIPTION, CONTENTS, ETC.	TOP	BOTTOM	NAME	DEPTH
Clay	0	3		
Broken Rock & Clay	3	8		
Shale	8	35		
Lime	35	59		
Shale	59	60		
Lime	60	89		
Shale	89	138		
Lime	138	143		
Shale	143	145		
Lime	145	147		
Shale	147	160		
Lime	160	165		
Shale	165	170		
Lime	170	176		
Shale	176	184		
Red Bed Shale	184	186		
Shale	186	192		
Lime	192	211		
Shale	211	214		
Lime	214	216		
Shale	216	220		
Lime (Hard)	220	233		
Shale	233	234		
Lime	234	254		
Shale	254	259		
Lime	259	277		
Dark Shale	277	281		
Lime	281	282		
Shale	282	283		
Lime	283	286		
Shale	286	288		
Lime BKC	288	295		
Shale	295	320		
Shale	320	327		
Sand Gas (Little Gas)	327	333		
Shale	333	340		
Sand Gas	340	344		
Shale	344	354		
Sand Gas	354	368		
T.D.	368			

RECEIVED
STATE GEOLOGICAL COMMISSION
APR 28 1980
GEOLOGICAL DIVISION
TOPEKA, KANSAS

USE ADDITIONAL SHEETS, IF NECESSARY, TO COMPLETE WELL RECORD.

Date Received	Signature <i>Roy D. Brewer</i>
	Title President, Breuer, Inc.
	Date 4-21-80

21-13-23E