

IMPORTANT
Kans. Geo. Survey request
samples on this well.

KANSAS DRILLERS LOG

S. 24 T. 14 R. 17 **E**
Loc. C W2 NW SE
County Douglas

API No. 15 — 045 — 20,112
County Number

Operator
Dunne Equities, Inc.

Address
260 North Rock Road, Suite 140 Wichita, Kansas 67206

Well No. # 1 Lease Name Anderson "B" & P. card has Anderson "A"

Footage Location
feet from (N) (S) line _____ feet from (E) (W) line _____

Principal Contractor Alco Drilling Co. Geologist Dean E. Seeber

Spud Date 9/27/79 Total Depth 1980 P.B.T.D. _____

Date Completed 10/3/79 Oil Purchaser D & A

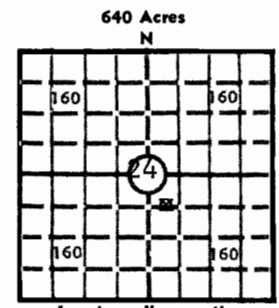

Elev.: Gr. 1102
DF _____ KB _____

CASING RECORD

Report of all strings set — surface, intermediate, production, etc.

Purpose of string	Size hole drilled	Size casing set (in O.D.)	Weight lbs/ft.	Setting depth	Type cement	Sacks	Type and percent additives
Surface	9"	7"	used tested	511'	Common	140	3 C.C.

LINER RECORD

PERFORATION RECORD

Top, ft.	Bottom, ft.	Sacks cement	Shots per ft.	Size & type	Depth interval
TUBING RECORD					
Size	Setting depth	Packer set at			

ACID, FRACTURE, SHOT, CEMENT SQUEEZE RECORD

Amount and kind of material used	Depth interval treated

INITIAL PRODUCTION

Date of first production _____		Producing method (flowing, pumping, gas lift, etc.) _____			
RATE OF PRODUCTION PER 24 HOURS	Oil _____ bbls.	Gas _____ MCF	Water _____ bbls.	Gas-oil ratio _____	CFPB _____
Disposition of gas (vented, used on lease or sold) _____			Producing interval (s) _____		

INSTRUCTIONS: As provided in KCC Rule 82-2-125, within 90 days after completion of a well, one completed copy of this Drillers Log shall be transmitted to the State Geological Survey of Kansas, 4150 Monroe Street, Wichita, Kansas 67209. Copies of this form are available from the Conservation Division, State Corporation Commission, 3830 So. Meridian (P.O. Box 17027), Wichita, Kansas 66217. Phone AC 316-522-2206. If confidential custody is desired, please note Rule 82-2-125. Drillers Logs will be on open file in the Oil and Gas Division, State Geological Survey of Kansas, Lawrence, Kansas 66044.

Operator		DESIGNATE TYPE OF COMP.: OIL, GAS, DRY HOLE, SWDW, ETC.:
Well No.	Lease Name	
S _____ T _____ R _____ E _____ W _____		

WELL LOG

Show all important zones of porosity and contents thereof; cored intervals, and all drill-stem tests, including depth interval tested, cushion used, time tool open, flowing and shut-in pressures, and recoveries.

SHOW GEOLOGICAL MARKERS, LOGS RUN, OR OTHER DESCRIPTIVE INFORMATION.

FORMATION DESCRIPTION, CONTENTS, ETC.	TOP	BOTTOM	NAME	DEPTH

USE ADDITIONAL SHEETS, IF NECESSARY, TO COMPLETE WELL RECORD.

Date Received	Signature
	VICE- PRESIDENT
	Title
	March 20, 1980
	Date