

10-1420E

TAC

STATE CORPORATION COMMISSION OF KANSAS
OIL & GAS CONSERVATION DIVISION
WELL COMPLETION OR RECOMPLETION FORM
ACO-1 WELL HISTORY
DESCRIPTION OF WELL AND LEASE

API NO. 15-045-21-048
County Douglas
SW NE SW Sec 10 Twp 14 Rge 20 East West
1815
3820 Ft North from Southeast Corner of Section
Ft West from Southeast Corner of Section
(Note: Locate well in section plat below)
Lease Name Hoskinson
Field Name
Producing Formation Lower Squirrel
Elevation: Ground KB

Operator: License # 9511
Name Alternative Energy Systems, Inc.
Address 533 W. Washington
Box 603
City/State/Zip Cuba, MO, 65453

Purchaser Enron Oil Trading & Trans. Co.

Operator Contact Person Johnny L. Giles
Phone 314-985-2839

Contractor: License # 3550
Name Central Plains

Wellsite Geologist James F. Stegeman
Phone 913-782-3191

Designate Type of Completion
 New Well Re-Entry Workover
 Oil SWD Temp Abd
 Gas Inj Delayed Comp
 Dry Other (Core, Water Supply etc.)

If ONWO: old well info as follows:
Operator
Well Name
Comp. Date Old Total Depth

WELL HISTORY

Drilling Method:
 Mud Rotary Air Rotary Cable
8-9-88 8-20-88 9-6-88
Spud Date Date Reached TD Completion Date
1600 330 Set plug &
Total Depth PBDT cement in at 1600 ft.
Set pipe to 330 ft. & cement back to surface
Amount of Surface Pipe Set and Cemented at feet
Multiple Stage Cementing Collar Used? Yes No
If yes, show depth set feet
If alternate 2 completion, cement circulated from 330 feet depth to surface 150.5x cmt
Cement Company Name Consolidated
Invoice # 00195001

NOV 09 1988

KANSAS GEOLOGICAL SURVEY
WICHITA BRANCH

RECEIVED
STATE CORPORATION COMMISSION
NOV 9 1988

CONSERVATION DIVISION
Wichita, Kansas

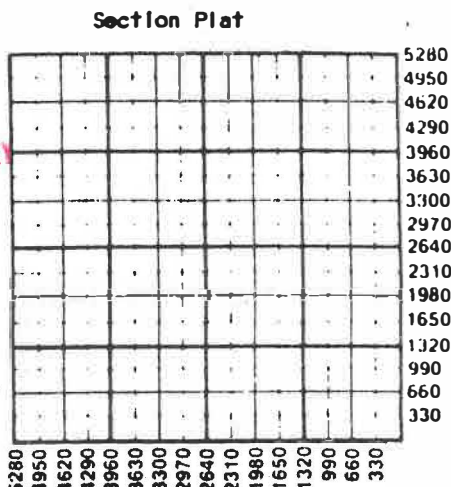

WATER SUPPLY INFORMATION

Disposition of Produced Water: Disposal
Docket # Repressuring

Questions on this portion of the ACO-1 call:

Water Resources Board (913) 296-3717

Source of Water:
Division of Water Resources Permit #

Groundwater Ft North from Southeast Corner (Well) Ft West from Southeast Corner of Sec Twp Rge East West

Surface Water Ft North from Southeast Corner (Stream, pond etc) Ft West from Southeast Corner Sec Twp Rge East West

Other (explain) (purchased from city, R.W.D. #)

INSTRUCTIONS: This form shall be completed in duplicate and filed with the Kansas Corporation Commission, 209 Colorado Derby Building, Wichita, Kansas 67202, within 90 days after completion or recompletion of any well. Rule 82-3-130 and 82-3-107 apply.

Information on side two of this form will be held confidential for a period of 12 months if requested in writing and submitted with the form. See rule 82-3-107 for confidentiality in excess of 12 months. One copy of all wireline logs and drillers time log shall be attached with this form. Submit CP-4 form with all plugged wells. Submit CP-111 form with all temporarily abandoned wells.

All requirements of the statutes, rules and regulations promulgated to regulate the oil and gas industry have been fully complied with and the statements herein are complete and correct to the best of my knowledge.

Signature [Signature]
Title President Date 11-5-88

Subscribed and sworn to before me this 5th day of November 1988
Notary Public [Signature]
Date Commission Expires 7-15-90

K.C.C. OFFICE USE ONLY
F Letter of Confidentiality Attached
C Wireline Log Received
C Drillers Time Log Received
Distribution
KCC SWD/Rep NGPA
KGS Plug Other (Specify)

Section 10 Page 50

10-14-20E

SIDE TWO

Operator Name Alternative Energy Systems, Inc. Lease Name..... Hoskinson Well #..... 1.....

Sec..... 16..... Twp..... 14..... Rge..... 20..... East West County..... Douglas.....

WELL LOG

INSTRUCTIONS: Show important tops and base of formations penetrated. Detail all cores. Report all drill stem tests giving interval tested, time tool open and closed, flowing and shut-in pressures, whether shut-in pressure reached static level, hydrostatic pressures, bottom hole temperature, fluid recovery, and flow rate if gas to surface during test. Attach extra sheet if more space is needed. Attach copy of log.

Drill Stem Tests Taken Yes No
 Samples Sent to Geological Survey Yes No
 Cores Taken Yes No

Formation Description
 Log Sample

Name	Top	Bottom
Hertha	446	454
Lower Squirrel	782	791

CASING RECORD <input type="checkbox"/> New <input type="checkbox"/> Used							
Report all strings set-conductor, surface, intermediate, production, etc.							
Purpose of String	Size Hole Drilled	Size Casing Set (in O.D.)	Weight Lbs/Ft.	Setting Depth	Type of Cement	#Sacks Used	Type and Percent Additives
Surface Production	8 7/8	6 7/8	8	40	Portland	10	None
	5	2 7/8		330	Oil Well	153	gel
PERFORATION RECORD				Acid, Fracture, Shot, Cement Squeeze Record			
Shots Per Foot	Specify Footage of Each Interval Perforated			(Amount and Kind of Material Used)		Depth	
3	783-790			140 bbl. of oil			
				5 sacks 12-20			
				50 sacks 8-12			
TUBING RECORD				Liner Run <input type="checkbox"/> Yes <input type="checkbox"/> No			
Date of First Production	Producing Method						
	<input checked="" type="checkbox"/> Flowing <input type="checkbox"/> Pumping <input type="checkbox"/> Gas Lift <input type="checkbox"/> Other (explain).....						
Estimated Production Per 24 Hours	Oil	Gas	Water	Gas-Oil Ratio	Gravity		
	1	0	50				
	bbls	MCF	Bbls	CFPB			

METHOD OF COMPLETION

Production Interval

Disposition of gas: Vented Open Hole Perforation Dually Completed
 Sold Other (Specify) 783 790
 Used on Lease Conmingled