

2/23/87

RELEASED
DATE **MAR 1 1988**
ALL COMPLETION OR RECOMPLETION FORM
FROM CONFIDENTIAL

STATE CORPORATION COMMISSION OF KANSAS
OIL & GAS CONSERVATION DIVISION
DATE **MAR 1 1988**
ALL COMPLETION OR RECOMPLETION FORM
FROM CONFIDENTIAL
ACQ-1 WELL HISTORY

API NO. 15 - 045-20,970

County Douglas, *KCC record*

SE SE NW NE SE NW
13 14 20 X East West
(location) Sec Twp Rge

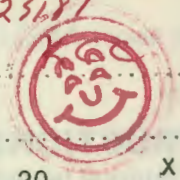

DESCRIPTION OF WELL AND LEASE

Operator: license # 7880
name Kansas Oil Properties, Inc.
address R. R. #3, Box 189A
City/State/Zip Baldwin City, KS 66006

2805 FEL 2805 Ft North from Southeast Corner of Section
3795 FSL 3135 Ft West from Southeast Corner of Section
(Note: locate well in section plat below)

KCC record
Lease Name Shephard II Well# 4

Operator Contact Person Robert Schachtner
Phone 913-594-2413 of 913-594-3534

Field Name In-field

Contractor: license # 5666
name Finch's Drilling, Inc.

Producing Formation First Squirrel

Wellsite Geologist none
Phone

Elevation: Ground KB

PURCHASER Inland Purchasing & Transportation Co

MAR 24 1988

**KANSAS GEOLOGICAL SURVEY
WICHITA BRANCH**

Designate Type of Completion
 New Well Re-Entry Workover

Section Plat

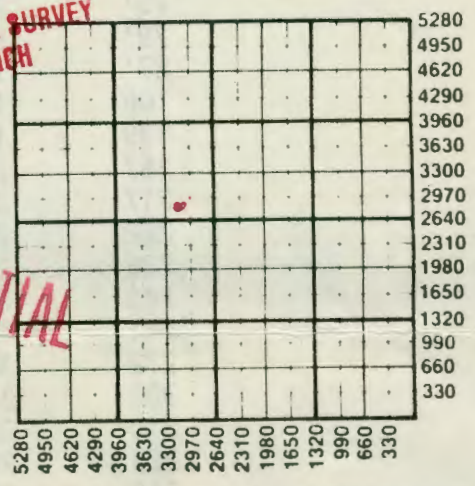

Oil SWD Temp Abd
 Gas Inj Delayed Comp.
 Dry Other (Core, Water Supply etc.)

CONFIDENTIAL

If Old Well: old well info as follows:
Operator
Well Name
Comp. Date Old Total Depth

WATER SUPPLY INFORMATION

Drilling Method: Mud Rotary Air Rotary Cable

Source of Water:
Division of Water Resources Permit #

.12/8/86... 12/8/86... 1/6/87...
Spud Date Date Reached TD Completion Date

Groundwater Ft North From Southeast Corner and
(Well) Ft. West From Southeast Corner of
Sec Twp Rge East West

.805'
Depth PBDT

Surface Water Ft North From Southeast Corner and
(Stream, Pond etc.) Ft West From Southeast Corner
Sec Twp Rge East West

Amount of Surface Pipe Set and Cemented at 40.2' feet

Multiple Stage Cementing Collar Used? Yes No

Date of First Production Producing method flowing pumping gas lift Other (explain)

Estimated Production Per 24 Hours	Oil	Gas	Water	Gas-Oil Ratio	Gravity
5.0	Bbls	MCF	.2%	CFPB	27.0

Disposition of gas: vented sold used on lease
METHOD OF COMPLETION: open hole perforation other (specify)

SIDE TWO

East
 West

Operator Name Kansas Oil Properties, Inc. Lease Name Shephard II. Well# 4. SEC. 13. TWP. 14. RGE. 20.

SE SE NW

WELL LOG

INSTRUCTIONS: Show important tops and base of formations penetrated. Detail all cores. Report all drill stem tests, flowing interval tested, time tool open and closed, flowing and shut-in pressures, whether shut-in pressure reached static level, hydrostatic pressures, bottom hole temperature, fluid recovery, and flow rates if gas to surface during test. Attach extra sheet if more space is needed. Attach copy of log.

Drill Stem Tests Taken		Formation Description		Name	Top	Bottom
Samples Sent to Geological Survey	<input type="checkbox"/> Yes <input checked="" type="checkbox"/> No	<input type="checkbox"/> Log	<input type="checkbox"/> Sample			
Cores Taken	<input checked="" type="checkbox"/> Yes <input type="checkbox"/> No					
Topsoil & Clay	0'	16'		Shale	600'	608'
Sand & Gravel	16'	35'		Lime	608'	609'
Lime	35'	41'		Shale	609'	638'
Shale	41'	44'		Lime	638'	640'
Lime	44'	67'		Shale	640'	641'
Shale	67'	73' Black		Lime	641'	644'
Lime	73'	79'		Shale	644'	658'
Shale	79'	87'		Sand	648'	664' Brown, No Show
Lime	87'	106'		Shale	664'	666' White
Shale	106'	139'		Sand	666'	672' Circulate No Show
Lime	139'	157'				
Shale	157'	217'		Sand	672'	676' " "
Lime	217'	222'		Sand	676'	678' Smell
Shale	222'	226'		Sand	678'	679' No Show
Lime	226'	245' Iola		Sand	679'	680' " "
Shale	245'	261'		Sand	680'	683' " "
Lime	261'	272'		Oil Sand	683'	684' Good Show
Shale	272'	303'		Sand	684'	700' Gas
Lime	303'	310'		Oil Sand	700'	704.3' Broken
Shale	310'	322'		Oil Sand	704.3'	719.5' Good
Lime	322'	348'		Lime	719.5'	720.5'
Shale	348'	356'		Oil Sand	720.5'	725' Good
Lime	356'	379'		Sand	725'	729' Brown
Shale	379'	384'		Sand & Shale	729'	735' Black, No Oil
Lime	384'	396' Hertha				
Shale	396'	557'		Shale	735'	805' T.D.
Lime	557'	561'				
Shale	561'	564'				
Lime	564'	571'				
Shale	571'	575'				
Lime	575'	581'				
Shale	581'	598'				
Lime	598'	600'				

CONFIDENTIAL

CASING RECORD <input checked="" type="checkbox"/> new <input type="checkbox"/> used							
Report all strings set - conductor, surface, intermediate, production, etc.							
purpose of string	size hole drilled	size casing set (in O.D.)	weight lbs/ft.	setting depth	type of cement	# sacks used	type and percent additives
surface	9 1/4"	6 1/4"		40.2'	portland	15-16	2% gel
completion	5 1/8"	2 7/8"		794'	portland	65	2% gel

PERFORATION RECORD		Acid, Fracture, Shot, Cement Squeeze Record	
shots per foot	specify footage of each interval perforated	(amount and kind of material used)	Depth
shot every			