

**WELL COMPLETION REPORT AND DRILLER'S LOG**

API No. 15 — 091 — 20,197  
County Number

S. 22 T. 14 R. 22 E  
Loc. 1016' nsl 840' ewl SW  $\frac{1}{4}$

County Johnson

Operator  
Jack Sanders

Address  
Box 96 Wellsville, KS 66092

Well No. # 9 Lease Name Teeker

Footage Location 1016 feet from (N) (S) line 840' feet from (E) (W) line SW  $\frac{1}{4}$

Principal Contractor McGown Drilling, Inc. Geologist

Start Date 4/23/80 Date Completed 4/26/80 Total Depth 875 P.B.T.D.

Directional Deviation Oil and/or Gas Purchaser LaJet Inc.

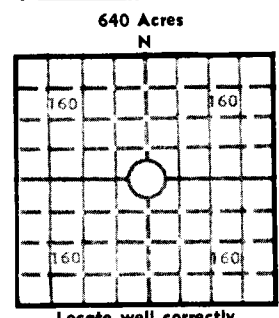

Elev.: Gr. \_\_\_\_\_  
DF \_\_\_\_\_ KB \_\_\_\_\_

**CASING RECORD**

Report of all strings set — surface, intermediate, production, etc.

Purpose of string	Size hole drilled	Size casing set (in O.D.)	Weight lbs/ft.	Setting depth	Type cement	Sacks	Type and percent additives
Production	6 $\frac{1}{4}$	4 $\frac{1}{2}$		863	Bulk	55	<del>55 sx Gel</del> 5 sx Gel

**LINER RECORD**

**PERFORATION RECORD**

Top, ft.	Bottom, ft.	Sacks cement	Shots per ft.	Size & type	Depth interval
			1	Glass	841-848

Size	Setting depth	Packer set at
2	863	0

**ACID, FRACTURE, SHOT, CEMENT SQUEEZE RECORD**

Amount and kind of material used	Depth interval treated
55 sx Sand 150 <del>Water</del>	841 to 848

**INITIAL PRODUCTION**

Date of first production <u>June 9, 1980</u>	Producing method (flowing, pumping, gas lift, etc.) <u>Pumping</u>
RATE OF PRODUCTION PER 24 HOURS	Oil $\frac{1}{4}$ bbls. Gas _____ MCF Water <u>5</u> bbls. Gas-oil ratio _____ CFPB
Disposition of gas (vented, used on lease or sold) <u>Vented</u>	Producing interval(s) <u>841-848</u>

INSTRUCTIONS: As provided in KCC Rule 82-2-125, within 90 days after completion of a well, one completed copy of this Drillers Log shall be transmitted to the State Geological Survey of Kansas, 4150 Monroe Street, Wichita, Kansas 67209. Copies of this form are available from the Conservation Division, State Corporation Commission, 245 No. Water, Wichita, Kansas 67202. Phone AC 316-522-2206. If confidential custody is desired, please note Rule 82-2-125. Drillers Logs will be on open file in the Oil and Gas Division, State Geological Survey of Kansas, Lawrence, Kansas 66044.

Operator

DESIGNATE TYPE OF COMP.: OIL, GAS, DRY HOLE, SWDW, ETC.:

Well No.

Lease Name

S \_\_\_\_\_ T \_\_\_\_\_ R \_\_\_\_\_ E \_\_\_\_\_ W \_\_\_\_\_

### WELL LOG

Show all important zones of porosity and contents thereof; cored intervals, and all drill-stem tests, including depth interval tested, cushion used, time tool open, flowing and shut-in pressures, and recoveries.

SHOW GEOLOGICAL MARKERS, LOGS RUN, OR OTHER DESCRIPTIVE INFORMATION.

FORMATION DESCRIPTION, CONTENTS, ETC.	TOP	BOTTOM	NAME	DEPTH

USE ADDITIONAL SHEETS, IF NECESSARY, TO COMPLETE WELL RECORD.

Date Received

*Jack W. Sandus*  
 \_\_\_\_\_  
 Signature

*Owner*  
 \_\_\_\_\_  
 Title

*Sept. 15, 1980*  
 \_\_\_\_\_  
 Date