

S. 10 T. 14 R. 22 E

Loc. SW SE NE SE

County Johnson

WELL COMPLETION REPORT AND
DRILLER'S LOG

API No. 15 — 091 — 20250
County Number

Operator
Rader Exploration Co.

Address
Route 1 Eudora, KS 66025

Well No. 1-W Lease Name Andrews

Footage Location
183' FSL feet from (N) (S) line 550' FEL feet from (E) (W) line

Principal Contractor Kent Drilling Co. Geologist Alan Rader

Spud Date Feb. 20 Date Completed 2/22/81 Total Depth 750.0' P.B.T.D. 732.8'

Directional Deviation none Oil and/or Gas Purchaser Maclaskey Vacuum Transport

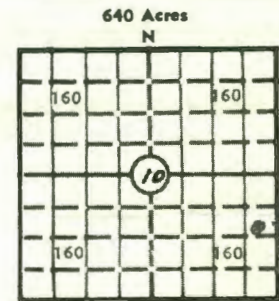

Locate well correctly
Elev.: Gr. 1009.67

DF 1010.52 KB

CASING RECORD

Report of all strings set — surface, intermediate, production, etc.

Purpose of string	Size hole drilled	Size casing set (in O.D.)	Weight lbs/ft.	Setting depth	Type cement	Sacks	Type and percent additives
Surface	9"	7 1/2"	32.30	74'	portland 40/60 saltsat.	22	40% salt sat. pos.-mix.
Casing	6-5/8"	2-7/8"	8.7	733'	portland	122	40% salt sat. poss.-mix.

LINER RECORD

PERFORATION RECORD

Top, ft.	Bottom, ft.	Sacks cement	Shots per ft.	Size & type	Depth interval
			1 1/2		690-696

Size	Setting depth	Packer set at

ACID, FRACTURE, SHOT, CEMENT SQUEEZE RECORD

Amount and kind of material used	Depth interval treated
one sack of sand, load hole, one sack of salt, one sack of sand.	690-696
total: 2 sacks fine sand and 1 sack of salt.	

INITIAL PRODUCTION

Date of first production 6-1-81 Producing method (flowing, pumping, gas lift, etc.) injection

RATE OF PRODUCTION PER 24 HOURS	Oil	Gas	Water	Gas-oil ratio
	bbls.	MCF	bbls.	CFPB

Disposition of gas (vented, used on lease or sold) Producing interval (s)

INSTRUCTIONS: As provided in KCC Rule 82-2-125, within 90 days after completion of a well, one completed copy of this Drillers Log shall be transmitted to the State Geological Survey of Kansas, 4150 Monroe Street, Wichita, Kansas 67209. Copies of this form are available from the Conservation Division, State Corporation Commission, 245 No. Water, Wichita, Kansas 67202. Phone AC 316-522-2206. If confidential custody is desired, please note Rule 82-2-125. Drillers Logs will be on open file in the Oil and Gas Division, State Geological Survey of Kansas, Lawrence, Kansas 66044.

330002

Operator Alan Rader DESIGNATE TYPE OF COMP.: OIL, GAS, DRY HOLE, SWDW, ETC.: Injection

Well No. 1-W Lease Name Andrews

S 10 T 14S R 22 E

WELL LOG

Show all important zones of porosity and contents thereof; cored intervals, and all drill-stem tests, including depth interval tested, cushion used, time tool open, flowing and shut-in pressures, and recoveries.

SHOW GEOLOGICAL MARKERS, LOGS RUN, OR OTHER DESCRIPTIVE INFORMATION.

Table with 5 columns: FORMATION DESCRIPTION, CONTENTS, ETC., TOP, BOTTOM, NAME, DEPTH. Rows include Soil and Clay, Lime, Shale, Stanton, Base of K.C., Breezy Hill, Upper Sq., 2nd Sq., 3rd Sq.

USE ADDITIONAL SHEETS, IF NECESSARY, TO COMPLETE WELL RECORD.

Date Received, Signature (Alan Rader), Title (owner), Date (11-20-81)

MICHIGAN DIVISION OF MINERAL RESOURCES