

SIDE ONE

20-14-205

STATE CORPORATION COMMISSION OF KANSAS
OIL & GAS CONSERVATION DIVISION
WELL COMPLETION OR RECOMPLETION FORM
ACO-1 WELL HISTORY
DESCRIPTION OF WELL AND LEASE

C

API NO. 15-091-21,824
County Johnson
SE. SW. NW Sec 20 Twp 14 Rge 22

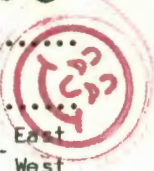

Operator: License # 5320
Name Double O Petroleum, Inc.
Address 401 S. Main, Suite 11
City/State/Zip Ottawa, KS 66067

2912 - ecc
2805
4455
4524 - ecc
(Note: Locate well in section plat below)

Purchaser Enron

Lease Name Guetterman Well # 9

Operator Contact Person Glenn Evans
Phone 913 242-5733

Field Name Gardner Edgerton

Contractor: License # 8509
Name Evans Energy Development, Inc.

Producing Formation Bartlesville

Wellsite Geologist none
Phone

Elevation: Ground unknown KB

Designate Type of Completion
 New Well Re-Entry Workover

Oil SWD Temp Abd
 Gas Inj Delayed Comp.
 Dry Other (Core, Water Supply etc.)

If ONWO: old well info as follows:
Operator
Well Name
Comp. Date Old Total Depth

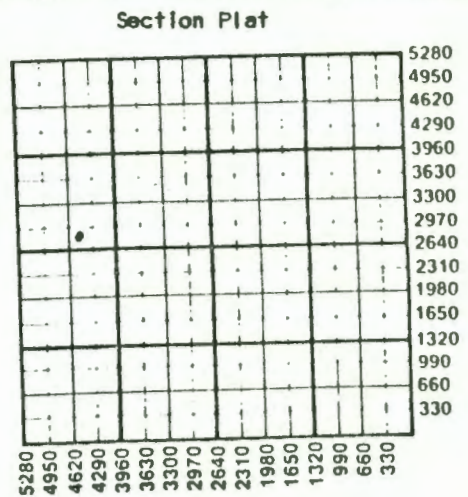

WATER SUPPLY INFORMATION

Disposition of Produced Water: N/A Disposal
Docket # Repressuring

WELL HISTORY

Drilling Method: Mud Rotary Air Rotary Cable

Questions on this portion of the ACO-1 call:

Water Resources Board (913) 296-3717

Source of Water: N/A
Division of Water Resources Permit #

Groundwater Ft North from Southeast Corner (Well) Ft West from Southeast Corner of Section Twp Rge East West

Surface Water Ft North from Southeast Corner (Stream, pond etc) Ft West from Southeast Corner Section Twp Rge East West

Other (explain) (purchased from city, R.W.D. #)

955 N/A
Total Depth PBTD

Amount of Surface Pipe Set and Cemented at 20 feet
Multiple Stage Cementing Collar Used? Yes No
If yes, show depth set feet

If alternate 2 completion, cement circulated from 955 feet depth to top of 94 SX cmt
Cement Company Name Consolidated 66371

Estimated Production Per 24 Hours	Oil	Gas	Water	Gas-Oil Ratio	Gravity
	2 Bbls	trace MCF	Bbls	CFPB	21

METHOD OF COMPLETION

Production Interval

Disposition of gas: Vented Sold Open Hole Perforation Other (Specify)

