

20-14-22



STATE CORPORATION COMMISSION OF KANSAS
OIL & GAS CONSERVATION DIVISION
WELL COMPLETION OR RECOMPLETION FORM
ACO-1 WELL HISTORY
DESCRIPTION OF WELL AND LEASE

API NO. 15-091/21.924
County... Johnson
NW SE SW Sec 20 Twp 14 Rge 22 East West

Operator: License # 03113
Name Martin Oil Properties
Address P.O. Box 18423
City/State/Zip Okla. City, OK 73154

875 Ft North from Southeast Corner of Section
3865 Ft West from Southeast Corner of Section
(Note: Locate well in section plat below)

Purchaser Enron

Lease Name East Morris Well # 11

Operator Contact Person Dean Kramer
Phone (913) 883 4871

Field Name

Producing Formation Bartlesville Sandstone

Contractor: License # 5335
Name Hawkeye Drilling Co.

Elevation: Ground KB

Wellsite Geologist
Phone

Designate Type of Completion
 New Well Re-Entry Workover

Oil SWD Temp Abd
Gas Inj Delayed Completion
Dry Other (Core, Water Supply etc.)

If ONWO: old well info as follows:
Operator
Well Name
Comp. Date Old Total Depth

RECEIVED
STATE CORPORATION COMMISSION
AUG 5 1988
KANSAS GEOLOGICAL SURVEY
WICHITA BRANCH

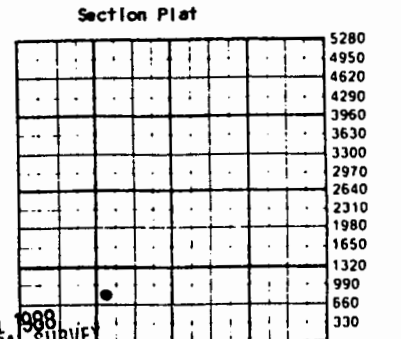

WATER SUPPLY INFORMATION

Disposition of Produced Water: Disposal
Docket # Repressuring

Questions on this portion of the ACO-1 call:
Water Resources Board (913) 296-3717
Source of Water:
Division of Water Resources Permit #
Groundwater Ft North from Southeast Corner (Well) Ft West from Southeast Corner
Sec Twp Rge East West
Surface Water Ft North from Southeast Corner (Stream, pond etc) Ft West from Southeast Corner
Sec Twp Rge East West
Other (explain)
(purchased from city, R.W.D. #)

WELL HISTORY
Drilling Method: Mud Rotary Air Rotary Cable
12/28/87... 1/11/88... 3/16/88...
Spud Date Date Reached TD Completion Date
960'... 951.8'
Total Depth PBTD
Amount of Surface Pipe Set and Cemented at 40 feet
Multiple Stage Cementing Collar Used? Yes No
If yes, show depth set... feet
If alternate 2 completion, cement circulated from... feet depth to... w/... SX cmt
Cement Company Name
Invoice #

INSTRUCTIONS: This form shall be completed in triplicate and filed with the Kansas Corporation Commission, 200 Colorado Derby Building, Wichita, Kansas 67202, within 120 days of the spud date of any well. Rule 82-3-130, 82-3-107 and 82-3-106 apply. Information on side two of this form will be held confidential for a period of 12 months if requested in writing and submitted with the form. See rule 82-3-107 for confidentiality in excess of 12 months. One copy of all wireline logs and drillers time log shall be attached with this form. Submit CP-4 form with all plugged wells. Submit CP-111 form with all temporarily abandoned wells.

All requirements of the statutes, rules and regulations promulgated to regulate the oil and gas industry have been fully complied with and the statements herein are complete and correct to the best of my knowledge.

Signature

Title... Date 2/3/90

Subscribed and sworn to before me this... day of...
City Public...

Date Commission Expires 2-11-90

K.C.C. OFFICE USE ONLY
F Letter of Confidentiality Attached
C Wireline Log Received
C Drillers Time Log Received
Distribution
KCC SWD/Rep NGPA
KGS Plug Other (Specify)

MARJORIE CHILTON
State of Kansas
Mv Appl. Exp.

Sec 20 Twp 14 Rge 22 E

20-14-22E

Operator Name Martin Oil Properties Lease Name East Morris Well # 11

Sec. 20 Twp. 14 Rge. 22 East West County Johnson

WELL LOG

INSTRUCTIONS: Show important tops and base of formations penetrated. Detail all cores. Report all drill stem tests giving interval tested, time tool open and closed, flowing and shut-in pressures, whether shut-in pressure reached static level, hydrostatic pressures, bottom hole temperature, fluid recovery, and flow rates if gas to surface during test. Attach extra sheet if more space is needed. Attach copy of log.

Drill Stem Tests Taken Yes No
 Samples Sent to Geological Survey Yes No
 Cores Taken Yes No

Bartlesville

Attached

Formation Description
 Log Sample

Name Top Bottom

Attached

CASING RECORD <input type="checkbox"/> New <input type="checkbox"/> Used							
Report all strings set-conductor, surface, intermediate, production, etc.							
Purpose of String	Size Hole Drilled	Size Casing Set (in O.D.)	Weight Lbs/Ft.	Setting Depth	Type of Cement	#Sacks Used	Type and Percent Additives
Surface	6 5/8"	6"			100%	15	
Production	5 1/8"	2 7/8"		951.8			
PERFORATION RECORD				Acid, Fracture, Shot, Cement Squeeze Record			
Shots Per Foot	Specify Footage of Each Interval Perforated			Amount and Kind of Material Used		Depth	
2	877.0' to 884.0'			50 Gal. Acid 80 bbl Oil Frac			
TUBING RECORD		Size	Set At	Packer at	Liner Run <input type="checkbox"/> Yes <input type="checkbox"/> No		
		2 7/8"	951.8				
Date of First Production	Producing Method						
	<input type="checkbox"/> Flowing <input checked="" type="checkbox"/> Pumping <input type="checkbox"/> Gas Lift <input type="checkbox"/> Other (explain).....						
Estimated Production Per 24 Hours	Oil	Gas	Water	Gas-Oil Ratio	Gravity		
	15 Bbls	MCF	Bbls	CFPB			

METHOD OF COMPLETION

Production Interval

Disposition of gas: Vented Open hole Perforation
 Sold Other (Specify)
 Used on Lease Dually Completed
 Commingled

20-14-22E

LOG

Company Martin Oil Properties Lease East Morris Well No. 11

<u>Depth Interval, Feet</u>	<u>Description</u>
	<u>BARTLESVILLE SANDSTONE</u>
884.0 - 884.3	Sandstone, light brown.
884.3 - 889.2	Sandstone, brownish black, with scattered gray shale partings.
889.2 - 890.0	Sandstone, brownish black, with gray shale partings.
890.0 - 892.7	Sandstone and shale, dark brown and gray, laminated.
892.7 - 894.2	Sandstone and shale, light brown and gray, laminated.

RECEIVED
OIL CORPORATION COMMISSION

AUG - 5 1988

CONSERVATION DIVISION
Wichita, Kansas

KANSAS GEOLOGICAL SURVEY
WICHITA BRANCH

Oilfield Research Laboratories

RESULTS OF SATURATION & PERMEABILITY TESTS

TABLE 1

Company Martin Oil Properties Lease East Morris Well No. 11

Sample No.	Depth, Feet	Porosity Percent	Percent Saturation			Oil Content Bbls. / A. Ft.	Permeability, Millidarcys
			Oil	Water	Total		
1	884.5	24.7	43	32	75	824	16.
2	885.4	26.8	39	22	61	811	144. —
3	886.5	22.8	59	8	67	1044	240.
4	887.5	24.4	45	18	63	852	208.
5	888.6	24.2	50	11	61	939	214.
6	889.6	20.7	46	30	76	739	21. —
7	890.6	21.1	47	26	73	769	18.
8	891.4	15.2	40	57	97	472	2.7
9	892.4	15.0	59	37	96	687	2.1
10	893.5	14.9	17	73	90	197	Imp.

5 FT / 16 SHOTS

877-
884- 15 SHOTS

RECEIVED
LABORATORY DIVISION
AUG 5 1988
LABORATORY DIVISION
Wichita, Kansas