

28-14-20E



STATE CORPORATION COMMISSION OF KANSAS  
OIL & GAS CONSERVATION DIVISION  
WELL COMPLETION OR RECOMPLETION FORM  
ACO-1 WELL HISTORY  
DESCRIPTION OF WELL AND LEASE

API No. 15-091-21-965  
County Johnson  
S. E. Sec. 28. Twp. 14. Rge. 22.  East  
 West

Operator: License # 9511  
Name Alternative Energy Systems, Inc.  
Address 508 W. Washington  
P. O. Box 306  
City/State/Zip Cuba, Mo. 65453

2065 Ft North from Southeast Corner of Section  
925 Ft West from Southeast Corner of Section  
(Note: Locate well in section plat below)

Purchaser: Enron Oil Trading & Trans. Co.  
P. O. Box 20108  
Shreveport, La. 71120

Lease Name Meyers Well # 20  
Field Name Gardner

Operator Contact Person Johnny L. Giles  
Phone 314-385-2838

Producing Formation Bartlesville

Contractor: License # 5335  
Name Hawkeye Drilling

Elevation: Ground KB

Wellsite Geologist  
Phone

Designate Type of Completion  
 New Well  Re-Entry  Workover  
 Oil  SWD  Temp Abd  
 Gas  Inj  Delayed Comp  
 Dry  Other (Core, Water Supply etc.)

RECEIVED  
STATE CORPORATION COMMISSION  
JUL 28 1988  
CONSERVATION DIVISION  
Wichita, Kansas

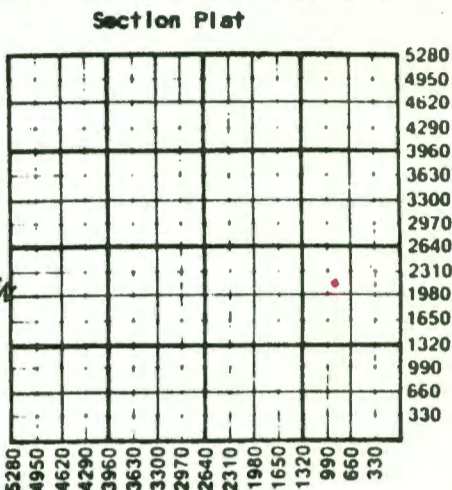

if ONWO: old well info as follows:  
Operator  
Well Name  
Comp. Date Old Total Depth

WATER SUPPLY INFORMATION

Disposition of Produced Water:  Disposal  
Socket #  Repressuring

Drilling Method:  
 Mud Rotary  Air Rotary  Cable  
6-14-88 6-20-88 7-19-88  
Mud Date Date Reached TD Completion Date  
980 971  
Total Depth PBTD

Questions on this portion of the ACO-1 call:

Water Resources Board (913) 296-3717

Source of Water:  
Division of Water Resources Permit #

Groundwater Ft North from Southeast Corner  
(Well) Ft West from Southeast Corner of  
Sec Twp Rge East West

Surface Water Ft North from Southeast Corner  
(Stream, pond etc) Ft West from Southeast Corner  
Sec Twp Rge East West

Other (explain)  
(purchased from city, R.W.D. #)

Amount of Surface Pipe Set and Cemented at 40 feet  
Multiple Stage Cementing Collar Used?  Yes  No  
If yes, show depth set feet  
If alternate 2 completion, cement circulated  
from 971 feet depth to surface / 107.5X cmt  
Cement Company Name Consolidated  
Invoice #

INSTRUCTIONS: This form shall be completed in duplicate and filed with the Kansas Corporation Commission, 200 Colorado Derby Building, Wichita, Kansas 67202, within 90 days after completion or recompletion of any well. Rule 82-3-130 and 82-3-107 apply.

Information on side two of this form will be held confidential for a period of 12 months if requested in writing and submitted with the form. See rule 82-3-107 for confidentiality in excess of 12 months. One copy of all wireline logs and drillers time log shall be attached with this form. Submit CP-4 form with all plugged wells. Submit CP-111 form with all temporarily abandoned wells.

If requirements of the statutes, rules and regulations promulgated to regulate the oil and gas industry have been fully complied with and the statements herein are complete and correct to the best of my knowledge.

Signature *Johnny L. Giles*  
Title President Date 7/25/88

Subscribed and sworn to before me this 26th day of July  
9  
Notary Public *Edward M. Jackson*  
Notary Commission Expires 4-23-90

K.C.C. OFFICE USE ONLY  
F Letter of Confidentiality Attached  
C Wireline Log Received  
C Drillers Time Log Received  
Distribution  
KCC SWD/Rep NGPA  
KGS Plug Other  
(Specify)

Sec. 28 Twp. 14 Rge. 22E

SIDE TWO

Operator Name Alternative Energy Systems, Inc. Lease Name Meyers Well # 20

Sec. 28 Twp. 14 Rge. 22  East  West County Johnson

WELL LOG

INSTRUCTIONS: Show important tops and base of formations penetrated. Detail all cores. Report all drill stem tests giving interval tested, time tool open and closed, flowing and shut-in pressures, whether shut-in pressure reached static level, hydrostatic pressures, bottom hole temperature, fluid recovery, and flow rates if gas to surface during test. Attach extra sheet if more space is needed. Attach copy of log.

Drill Stem Tests Taken  Yes  No  
 Samples Sent to Geological Survey  Yes  No  
 Cores Taken  Yes  No

Formation Description  
 Log  Sample

Name	Top	Bottom
Hertha	384	401
Bartlesville	888	900

CASING RECORD  New  Used

Report all strings set-conductor, surface, intermediate, production, etc.

Purpose of String	Size Hole Drilled	Size Casing Set (in O.D.)	Weight Lbs/Ft.	Setting Depth	Type of Cement	#Sacks Used	Type and Percent Additives
Surface	8 7/8	6 7/8		40	Portland	10	None
Production	6	2 7/8	6		Oil Well	107	Gel

PERFORATION RECORD

Acid, Fracture, Shot, Cement Squeeze Record

Shots Per Foot	Specify Footage of Each Interval Perforated	(Amount and Kind of Material Used)	Depth
3	889 to 897	150 bbl. of oil 5 sacks 12-20 75 sacks 8-12	

TUBING RECORD	Size	Set At	Packer at	Liner Run	<input type="checkbox"/> Yes <input checked="" type="checkbox"/> No
---------------	------	--------	-----------	-----------	---

Date of First Production	Producing Method
	<input checked="" type="checkbox"/> Flowing <input type="checkbox"/> Pumping <input type="checkbox"/> Gas Lift <input type="checkbox"/> Other (explain).....

Estimated Production Per 24 Hours	Oil	Gas	Water	Gas-Oil Ratio	Gravity
	3	0	0		21
	Bbls	MCF	Bbls	CFPB	

METHOD OF COMPLETION

Production Interval

Disposition of gas:  Vented  Open Hole  Perforation  
 Sold  Other (Specify) .....  
 Used on Lease  Dually Completed  
 Commingled

889 to 897  
 .....