

28-14-226
KAS

STATE CORPORATION COMMISSION OF KANSAS
OIL & GAS CONSERVATION DIVISION
WELL COMPLETION OR RECOMPLETION FORM
ACO-1 WELL HISTORY
DESCRIPTION OF WELL AND LEASE

Operator: License # 9511
Name Alternative Energy Systems, Inc
Address 508 W. Washington
P.O. Box 306
City/State/Zip Cuba, Mo. 65453

Purchaser Enron Oil Trading & Trans. Co
P.O. Box 20108
Shreveport, La. 71120

Operator Contact Person Johnny L. Giles
Phone 314-885-2838

Contractor: License # 5335
Name Hawkeye Drilling

Wellsite Geologist
Phone

Designate Type of Completion
 New Well Re-Entry Workover
 Oil SWD Temp Abd
 Gas Inj Delayed Comp.
 Dry Other (Core, Water Supply etc.)

If OWWO: old well info as follows:
Operator
Well Name
Comp. Date
Old Total Depth

WELL HISTORY

Drilling Method:
 Mud Rotary Air Rotary Cable
12-4-87 12-9-87 1-18-88
Spud Date Date Reached TD Completion Date
980 958
Total Depth PBD

Amount of Surface Pipe Set and Cemented at 40 feet
Multiple Stage Cementing Collar Used? Yes No
If yes, show depth set feet
If alternate 2 completion, cement circulated from 958 feet depth to surface 103 SX cmt
Cement Company Name Consolidated
Invoice #

API NO. 15-091-21-913

County Johnson
NW NE SE - KCC
Sec. 28 Twp. 14 Rge. 22 East West

.2445 Ft North from Southeast Corner of Section
1305 Ft West from Southeast Corner of Section
(Note: Locate well in section plat below)

Lease Name Meyers Well # 28

Field Name Gardner

Producing Formation Bartlesville

Elevation: Ground KB

Section Plat

FEB 22 1988
KANSAS GEOLOGICAL SURVEY
WICHITA BRANCH

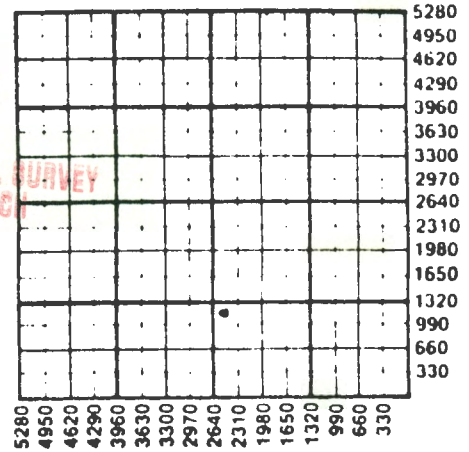

WATER SUPPLY INFORMATION

Disposition of Produced Water: Disposal
Docket # Repressuring

Questions on this portion of the ACO-1 call:

Water Resources Board (913) 296-3717

Source of Water:
Division of Water Resources Permit #

Groundwater Ft North from Southeast Corner (Well) Ft West from Southeast Corner of Sec Twp Rge East West

Surface Water Ft North from Southeast Corner (Stream, pond etc) Ft West from Southeast Corner Sec Twp Rge East West

Other (explain) (purchased from city, R.W.D. #)

INSTRUCTIONS: This form shall be completed in duplicate and filed with the Kansas Corporation Commission, 200 Colorado Derby Building, Wichita, Kansas 67202, within 90 days after completion or recompletion of any well. Rule 82-3-130 and 82-3-107 apply. Information on side two of this form will be held confidential for a period of 12 months if requested in writing and submitted with the form. See rule 82-3-107 for confidentiality in excess of 12 months. One copy of all wireline logs and drillers time log shall be attached with this form. Submit CP-4 form with all plugged wells. Submit CP-111 form with all temporarily abandoned wells.

28-14-275

SIDE TWO

Alternative Energy Systems, Inc. Operator Name Lease Name Meyers Well # 28

Sec. 28 Twp. 14 Rge. 22 East West County Johnson

WELL LOG

INSTRUCTIONS: Show important tops and base of formations penetrated. Detail all cores. Report all drill stem tests giving interval tested, time tool open and closed, flowing and shut-in pressures, whether shut-pressure reached static level, hydrostatic pressures, bottom hole temperature, fluid recovery, and flow rate if gas to surface during test. Attach extra sheet if more space is needed. Attach copy of log.

Drill Stem Tests Taken Yes No
 Samples Sent to Geological Survey Yes No
 Cores Taken Yes No

Formation Description
 Log Sample

Name	Top	Bottom
Hertha	413	425
Bartlesville	881	887

	Oil	Gas	Water	Gas-Oil Ratio	Gravity
Estimated Production Per 24 Hours	6	0	0		21
	Bbls	MCF	Bbls	CFPB	

METHOD OF COMPLETION

Production Interval

Disposition of gas: Vented Open Hole Perforation Sold Other (Specify) 882 to 888
 Used on Lease

CASING RECORD New Used
 Report all strings set-conductor, surface, intermediate, production, etc.

Purpose of String	Size Hole Drilled	Size Casing Set (In O.D.)	Weight Lbs/Ft.	Setting Depth	Type of Cement	#Sacks Used	Type and Percent Additives
Surface	8.7/8	6.7/8		40	Portland	10	None
Production	6	2.7/8	6		Oil Well	103	Gel

PERFORATION RECORD

Shots Per Foot	Specify Footage of Each Interval Perforated	Acid, Fracture, Shot, Cement Squeeze Record (Amount and Kind of Material Used)	Depth
3	882 to 888	140 bbl. of oil	
		10 sacks 12-20	
		65 sacks 8-12	

TUBING RECORD Size Set At Packer at Liner Run Yes No

Date of First Production Producing Method Flowing Pumping Gas Lift Other (explain).....