

28-14-22E

STATE CORPORATION COMMISSION OF KANSAS  
OIL & GAS CONSERVATION DIVISION  
WELL COMPLETION OR RECOMPLETION FORM  
ACO-1 WELL HISTORY  
DESCRIPTION OF WELL AND LEASE

API NO. 15-... 091-21962  
County Johnson  
SENECA - KCC  
Sec. 23 Twp. 14 Rge. 22 East

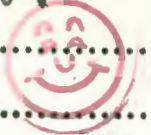

Operator License # 9511  
Name Alternative Energy Systems, Inc.  
Address 502 W. Washington  
City/State/Zip Cuba, Missouri, 65453

1875 Ft North from Southeast Corner of Section  
355 Ft West from Southeast Corner of Section  
(Note: Locate well in section plat below)

Purchase  
Operator Contact Person Johnny L. Giles  
Phone 314-885-2638

Lease Name Meyers Well # 5A  
Field Meyers  
Producing Formation Bartlesville

Contractor License # 5335  
Name Hawkeya Drilling  
Wellsite Geologist  
Phone

Elevation: Ground KB

Designate Type of Completion  
 New Well  Re-Entry  Workover  
Oil SWD Temp Acid  
Gas  Inj Delayed Completion  
Dr Other (Core, Water Supply etc)  
If Old: old well info as follows:  
Operator  
Well Name  
Comp. Date Old Total Depth

RECEIVED  
JUL 28 1988  
STATE CORPORATION COMMISSION  
CONSERVATION DIVISION  
Wichita, Kansas

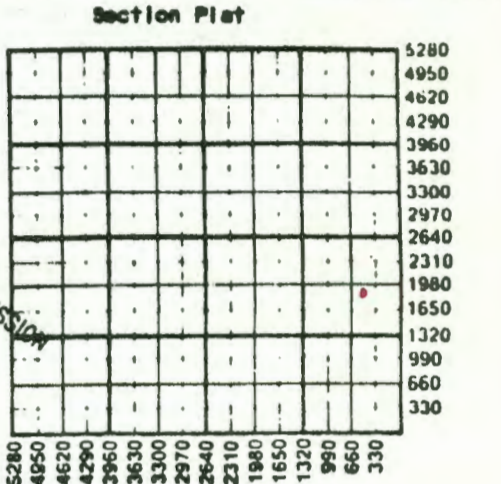

WATER SUPPLY INFORMATION  
Disposition of Produced Water: Disposal  
Bucket #  Repressuring

WELL HISTORY  
Drilling Method:  
 Mud Rotary  Air Rotary  Cable  
6-2-88 6-7-88 7-19-88  
Spud Date Date Reached TD Completion Date  
930 958  
Total Depth PBT  
Amount of Surface Pipe Set and Cemented at 40 feet  
Multiple Stage Cementing Collar Used? Yes  No  
If yes, show depth set feet  
If alternate 2 completion, cement circulated  
from 958 surface 107 SX cement  
Cement Company Name Consolidated  
Invoice # 00093914

Questions on this portion of the ACO-1 call:  
Water Resources Board (913) 296-3717  
Source of Water:  
Division of Water Resources Permit #  
Groundwater Ft North from Southeast Corner  
(Well) Ft West from Southeast Corner of  
Sec Twp Rge East West  
Surface Water Ft North from Southeast Corner  
(Stream, pond etc) Ft West from Southeast Corner  
Sec Twp Rge East West  
Other (explain)  
(purchased from city, R.W.D. #)

INSTRUCTIONS: This form shall be completed in duplicate and filed with the Kansas Corporation Commission, 200 Colorado Derby Building, Wichita, Kansas 67202, within 90 days after completion or recompletion of any well. Rule 82-3-130 and 82-3-107 apply.  
Information on side two of this form will be held confidential for a period of 12 months if requested in writing and submitted with the form. See rule 82-3-107 for confidentiality in excess of 12 months.  
One copy of all wireline logs and ~~the~~ the log shall be attached with this form. Submit CP-4 form with all plugged wells. Submit CP-111 form with all temporarily abandoned wells.

All requirements of the statutes, rules and regulations promulgated to regulate the oil and gas industry have been fully complied with and the statements herein are complete and correct to the best of my knowledge.

Signature [Signature]  
Title President Date 7-25-88

Subscribed and sworn to before me this 26th day of July  
9...  
Notary Public [Signature]  
Notary Commission Expires 4-23-90

K.C.C. OFFICE USE ONLY  
F Letter of Confidentiality Attached  
C Wireline Log Received  
C Driller's Time Log Received  
Distribution  
KCC  SWD/Rep NGPA  
KGS  Plug Other  
(Specify)

AVG 13 1988  
KANSAS GEOLOGICAL SURVEY  
WICHITA BRANCH

sec 82 imp. 14, pge. 220

Operator Name ..... Alternative Energy Systems, Inc. ..... Lease Name ..... Meyers ..... Well # ..... 5A .....

Sec. .... 23 ..... Twp. .... 14 ..... Rge. .... 22 .....  East  West County ..... Johnson .....

WELL LOG

INSTRUCTIONS: Show important tops and base of formations penetrated. Detail all cores. Report all drill tests giving interval tested, time tool open and closed, flowing and shut-in pressures, whether shut pressure reached static level, hydrostatic pressures, bottom hole temperature, fluid recovery, and flow rate if gas to surface during test. Attach extra sheet if more space is needed. Attach copy of log.

Drill Stem Tests Taken  Yes  No  
 Samples Sent to Geological Survey  Yes  No  
 Cores Taken  Yes  No

Formation Description  
 Log  Sample

Name	Top	Bottom
Hertha	385	401
Bartlesville	887	902

RECEIVED BY THE CLERK OF THE DISTRICT COURT  
 COUNTY OF JOHNSON, MISSOURI  
 DATE 11-1-88  
 BY MISS JUDITH B. BERRY  
 COUNTY CLERK

CASING RECORD  New  Used  
 Report all strings set-conductor, surface, intermediate, production, etc.

Purpose of String	Size Hole Drilled	Size Casing Set (in O.D.)	Weight Lbs/Ft.	Setting Depth	Type of Cement	#Sacks Used	Type and Percent Additives
Surface	8 7/8	6 7/8		40	Portland	10	None
Production	5	2 7/8	6	958	Ini	107	Gel 4

PERFORATION RECORD  
 Shots Per Foot Specify Footage of Each Interval Perforated Acid, Fracture, Shot, Cement Squeeze Record (Amount and Kind of Material Used) Depth

3	883 to 894	Water 5 sacks 12-20	
---	------------	------------------------	--

TUBING RECORD Size Set At Packer set Liner Run  Yes  No

Date of First Production Producing Method  
 Flowing  Pumping  Gas Lift  Other (explain).....

Estimated Production Per 24 Hours	Oil Bbls	Gas MCF	Water Bbls	Gas-Oil Ratio CFPB	Gravity

METHOD OF COMPLETION Production Interval

Disposition of gas:  Vented  Open Hole  Perforation  
 Sold  Other (Specify) .....  
 Used on Lease  Dually Completed  Commingled

88 to 894 .....