

STATE CORPORATION COMMISSION OF KANSAS
OIL & GAS CONSERVATION DIVISION

WELL COMPLETION OR RECOMPLETION FORM
ACO-1 WELL HISTORY

DESCRIPTION OF WELL AND LEASE

Operator: License # 8653
Name Petroleum Technologies, Inc.
Address 3535 Broadway, Suite C
City/State/Zip Kansas City, MO 64111

Purchaser N/A

Operator Contact Person Alan J. Seaton
Phone (816) 531 6904

Contractor: License # 6217
Name Sunrise Drilling, Inc.

Wellsite Geologist N/A
Phone

Designate Type of Completion
 New Well Re-Entry Workover
 Oil SWD Temp Abd
 Gas Inj Delayed Comp.
 Dry Other (Core, Water Supply etc.)

If OWWO: old well info as follows:
Operator
Well Name
Comp. Date Old Total Depth

WELL HISTORY

Drilling Method:
 Mud Rotary Air Rotary Cable
9-10-85 9-12-85 9-12-85
Spud Date Date Reached TD Completion Date
900' N/A
Total Depth PBDT

Amount of Surface Pipe Set and Cemented at 20 feet
Multiple Stage Cementing Collar Used? Yes No
If yes, show depth set.....feet
If alternate 2 completion, cement circulated
from.....feet depth to Surface/SX cmt

API NO. 15-091, 21, 628
County Johnson
NW NW NW SE 30 14S 22 East
Sec Twp Rge West

2475 Ft North from Southeast Corner of Section
2475 Ft West from Southeast Corner of Section
(Note: Locate well in section plat below)

Lease Name Gillespie Well # 30-15

Field Name N/A

Producing Formation Cherokee Group

Elevation: Ground N/A KB N/A

Section Plat

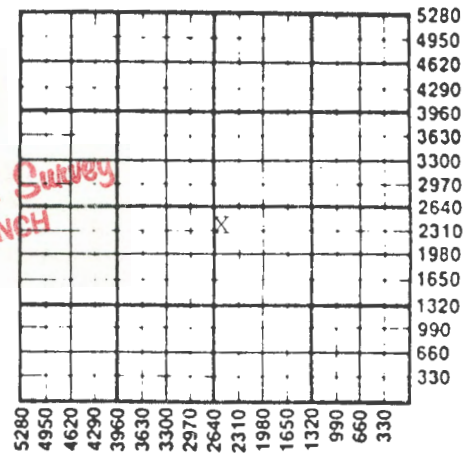

WATER SUPPLY INFORMATION

Disposition of Produced Water: Disposal
Docket # Repressuring

Questions on this portion of the ACO-1 call:

Water Resources Board (913) 296-3717

Source of Water:
Division of Water Resources Permit #

Groundwater.....Ft North from Southeast Corner
(Well)Ft West from Southeast Corner of
Sec Twp Rge East West

Surface Water.....Ft North from Southeast Corner
(Stream, pond etc).....Ft West from Southeast Corner
Sec Twp Rge East West

Other (explain).....
(purchased from city, R.W.D. #)

INSTRUCTIONS: This form shall be completed in duplicate and filed with the Kansas Corporation Commission, 200 Colorado Derby Building, Wichita, Kansas 67202, within 90 days after completion or recompletion of any well. Rule 82-3-130 and 82-3-107 apply. Information on side two of this form will be held confidential for a period of 12 months if requested in writing and submitted with the form. See rule 82-3-107 for confidentiality in excess of 12 months. One copy of all wireline logs and drillers time log shall be attached with this form. Submit CP-4 form with all plugged wells. Submit CP-111 form with all temporarily abandoned wells.

SIDE TWO

Operator Name Petroleum Technologies, Inc. Lease Name..... Gillespie' Well #..... 30-1

Sec..... 30 Twp..... 14 S Rge..... 22 East West County..... Johnson

WELL LOG

INSTRUCTIONS: Show important tops and base of formations penetrated. Detail all cores. Report all drill stem tests giving interval tested, time tool open and closed, flowing and shut-in pressures, whether shut-in pressure reached static level, hydrostatic pressures, bottom hole temperature, fluid recovery, and flow rates if gas to surface during test. Attach extra sheet if more space is needed. Attach copy of log.

Drill Stem Tests Taken Yes No
 Samples Sent to Geological Survey Yes No
 Cores Taken Yes No

Formation Description
 Log Sample

Name Top Bottom

Driller's log attached

CASING RECORD <input checked="" type="checkbox"/> New <input type="checkbox"/> Used							
Report all strings set-conductor, surface, intermediate, production, etc.							
Purpose of String	Size Hole Drilled	Size Casing Set (In O.D.)	Weight Lbs/Ft.	Setting Depth	Type of Cement	#Sacks Used	Type and Percent Additives
Surface	1 1/4"	7-5/8"	20#	20'	OWC	5sx	3% CaCl
PERFORATION RECORD				Acid, Fracture, Shot, Cement Squeeze Record			
Shots Per Foot	Specify Footage of Each Interval Perforated			(Amount and Kind of Material Used)		Depth	
.....	
.....	
.....	
.....	
TUBING RECORD				Liner Run <input type="checkbox"/> Yes <input checked="" type="checkbox"/> No			
Date of First Production	Producing Method						
.....			

Flowing Pumping Gas Lift Other (explain).....

Open: Petroleum Technologies
 30-145-22E
 NW NW NW SE

Gillespie 30-15

DRILLERS LOG

THICKNESS	FORMATION	DEPTH
0-15	CLAY	15
11	SHALE	26
3	WATER SAND	29
43	SHALE	72
35	LIME	107
3	SHALE	110
4	BLACK SHALE	114
11	LIME	125
5	SHALE	130
15	LIME	145
1	SHALE	146
39	LIME	185
15	SHALE	200
15	LIME	215
55	SHALE	270
50	LIME	320 w/lime streak
42	SHALE	362
27	LIME	389
11	SHALE	400
37	LIME	437 shale streak
37	SHALE	474
15	SANDY SHALE	489
118	SHALE	607
3	COAL	610
2	LIME	612
6	SHALE	618
10	LIME	628
16	SHALE	644
3	LIME	647
7	SHALE	654
8	LIME	662
8	SHALE	670
4	LIME	674
76	SHALE	750 w/lime streak
7	LIME	757
134	SHALE	885 w/lime streak and coal

SEP 24 1965
 State Geological Survey
 WICHITA BRANCH

RECEIVED
 STATE CORPORATION COMMISSION

SEP 23 1965

CONSERVATION DIVISION
 Wichita, Kansas