

KANSAS

WELL COMPLETION REPORT AND DRILLER'S LOG

State Geological Survey WICHITA, BRANCH

4-14-23E

IANU

S. 4 T. 14S. R. 23 E

Loc. SW 1/4 - NW 1/4 - NE 1/4

API No. 15 - 091 - 20,278
County Number

County Johnson

Operator E. E. Therpe Jr.

Address RR # 3 Box 44 Olathe Kans.

Well No. 004 Lease Name Ford

Footage Location feet from (N) (S) line feet from (E) (W) line

Principal Contractor Glaze Drilling Co. Geologist

Spud Date Date Completed Total Depth 722 ft P.B.T.D.

Directional Deviation or Gas Purchaser Union Gas Co.

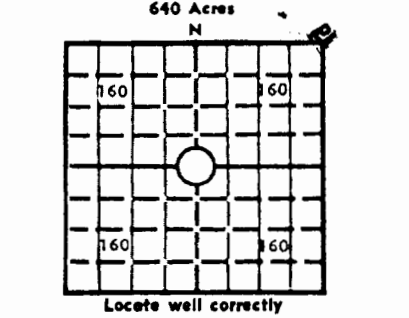

Elev.: Gr. DF KB

CASING RECORD

Report of all strings set - surface, intermediate, production, etc.

Purpose of string	Size hole drilled	Size casing set (in O.D.)	Weight lbs/ft.	Setting depth	Type cement	Sacks	Type and percent additives

LINER RECORD

PERFORATION RECORD

Top, ft.	Bottom, ft.	Sacks cement	Shots per ft.	Size & type	Depth interval

TUBING RECORD

Size	Setting depth	Packer set at

ACID, FRACTURE, SHOT, CEMENT SQUEEZE RECORD

Amount and kind of material used	Depth interval treated

INITIAL PRODUCTION

Date of first production	Producing method (flowing, pumping, gas lift, etc.)
RATE OF PRODUCTION PER 24 HOURS	Oil bbls. Gas MCF Water bbls. Gas-oil ratio CFPB
Disposition of gas (vented, used on lease or sold)	Producing interval(s)

INSTRUCTIONS: As provided in KCC Rule 82-2-125, within 90 days after completion of a well, one completed copy of this Drillers Log shall be transmitted to the State Geological Survey of Kansas, 4150 Monroe Street, Wichita, Kansas 67209. Copies of this form are available from the Conservation Division, State Corporation Commission, 245 No. Water, Wichita, Kansas 67202. Phone AC 316-522-2206. If confidential custody is desired, please note Rule 82-2-125. Drillers Logs will be on open file in the Oil and Gas Division, State Geological Survey of Kansas, Lawrence, Kansas 66044.

(Over)

4-14-23E

WELL LOG

<u>DESCRIPTION</u>	<u>TOP</u>	<u>BOTTOM</u>	<u>NAME</u>	<u>DESCRIPTION</u>	<u>TOP</u>	<u>BOTTOM</u>	<u>NAME</u>
Surface	22	22		Red Bed	3	521	
Clay & Drift	7	29		Shale	9	530	
Lime	9	38		Black Slate	3	533	Lexington
Shale	8	46		(2" in 1")			
Lime	37	83		Shale	14	547	
Shale	27	110		Lime	1	548	
Lime	8	118		Shale	3	551	
Shale	18	136		Lime	1	552	
Lime	9	145		Shale	3	555	
Shale	3	148		Sandstone	7	562	Squirrell
Lime	9	157		Shale	28	590	
Shale	29	186		Lime	1	591	
Lime	1	187		Shale	24	615	
Shale	3	190		Sandstone	14	629	Squirrell
Lime	3	193		(gas bubbles)			300,000-Open
Shale	3	196		Shale (sandy)	15	644	
Lime	11	207		Lime	1	645	
Shale	1	208	Winterset	Shale (sandy)	23	668	
Lime	17	225		Sandstone	16	684	Light
Shale (dark)	9	234		show - faint gas bubbles			
Lime	19	253	Bethany	(Cattleman)			
Shale (dark)	3	256		Shale (sandy)	9	693	
Lime	4	260		Lime	3	696	
Shale	5	265	Hertha	Shale (sandy)	26	722	
Lime	6	271					
Shale	34	305					
Sandstone	7	312	Oil Show				
(no gas)							
Shale (sandy)	7	319					
Sandstone	9	328	Faint bubble				
Shale (sandy)	57	385					
Sandstone	8	398					
Shale (sandy)	23	416					
Red Bed	3	419					
Shale	10	429					
Lime	1	430					
Shale (sandy)	7	437					
Lime	1	438					
Sandstone	4	442					
Shale	8	450					
Lime	5	455					
Shale	7	462					
Lime	2	464					
Black Slate	3	467					
Shale	3	470					
Lime	5	475					
Shale	1	476					
Lime	1	477					
Shale	17	494					
Lime	3	497					
Shale	11	508					
Lime	7	515					
Shale	3	518					

TOTAL DEPTH 722 FEET