

STATE CORPORATION COMMISSION OF KANSAS
OIL & GAS CONSERVATION DIVISION
WELL COMPLETION OR RECOMPLETION FORM
ACO-1 WELL HISTORY
DESCRIPTION OF WELL AND LEASE

C

API NO. 15-091-21,951

19-14-24E

Paul

County Johnson

SW SE NE Sec. 19 Twp. 14 Rge. 24 East West

3810 Ft North from Southeast Corner of Section

950 Ft West from Southeast Corner of Section

(Note: Locate well in section plat below)

Lease Name Effertz Well # 8C

Field Name Paola-Rantoul Northeast

Producing Formation Bartlesville, Burgess, Miss. L.S.

Elevation: Ground KB

Section Plat

OCT 07 1988

KANSAS GEOLOGICAL SURVEY
WICHITA BRANCH

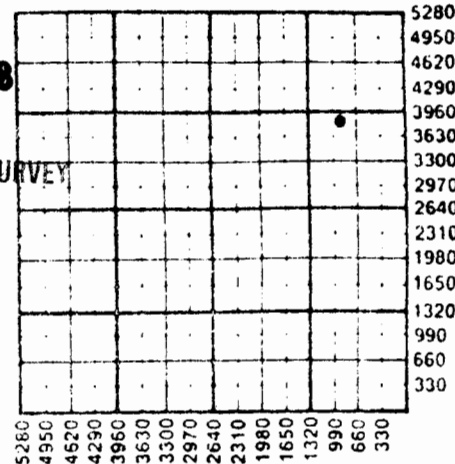

WATER SUPPLY INFORMATION

Disposition of Produced Water: Disposal Repressuring
Docket # E-25,381

Questions on this portion of the ACO-1 call:

Water Resources Board (913) 296-3717

Source of Water:

Division of Water Resources Permit # 889-017

Groundwater 3180 Ft North from Southeast Corner (Well) 950 Ft West from Southeast Corner of Sec 19 Twp 14 Rge 24 East West

Surface Water Ft North from Southeast Corner (Stream, pond etc) Ft West from Southeast Corner Sec Twp Rge East West

Other (explain) (purchased from city, R.W.D. #)

Operator: License # 9690
Name Prairie Resources Corp
Address 7800 W. 110th Suite 122
City/State/Zip Overland Park, Ks. 66210

Purchaser Koch Oil Co.
Wichita, Ks.

Operator Contact Person Dennis Kershner
Phone 316-365-3111

Contractor: License # 5820
Name Kent Drilling Co.

Wellsite Geologist none
Phone

Designate Type of Completion
 New Well Re-Entry Workover

Oil SWD Temp Abd
 Gas Inj Delayed Comp.
 Dry Other (Core, Water Supply etc.)

If OWO: old well info as follows:
Operator
Well Name
Comp. Date Old Total Depth

WELL HISTORY

Drilling Method:
 Mud Rotary Air Rotary Cable

4/25/88 4/28/88 5/12/88
Spud Date Date Reached TD Completion Date

1040' 10'
Total Depth PBTD

Amount of Surface Pipe Set and Cemented at 22 feet
Multiple Stage Cementing Collar Used? Yes No
If yes, show depth set feet

If alternate 2 completion, cement circulated from 1040 feet depth to surface / 158 SX cmt
Cement Company Name Consolidated Services
Invoice # 72801

INSTRUCTIONS: This form shall be completed in triplicate and filed with the Kansas Corporation Commission, 200 Colorado Derby Building, Wichita, Kansas 67202, within 120 days of the spud date of any well. Rule 82-3-130, 82-3-107 and 82-3-106 apply.

Information on side two of this form will be held confidential for a period of 12 months if requested in writing and submitted with the form. See rule 82-3-107 for confidentiality in excess of 12 months.

One copy of all wireline logs and drillers time log shall be attached with this form. Submit CP-4 form with all plugged wells. Submit CP-111 form with all temporarily abandoned wells.

Operator Name **PRAIRIE RESOURCES CORP.** Lease Name **EFFERTZ** Well # **8C**

Sec. **19** Twp. **14** Rge. **24** East West County **Johnson**

WELL LOG

INSTRUCTIONS: Show important tops and base of formations penetrated. Detail all cores. Report all drill stem tests giving interval tested, time tool open and closed, flowing and shut-in pressures, whether shut-in pressure reached static level, hydrostatic pressures, bottom hole temperature, fluid recovery, and flow rates if gas to surface during test. Attach extra sheet if more space is needed. Attach copy of log.

Drill Stem Tests Taken Yes No
Samples Sent to Geological Survey Yes No
Cores Taken Yes No

Formation Description
 Log Sample

Core in Squirrel per Dennis Kershner

Name	Top	Bottom
Squirrel sand	680	684
Battlesville sand	904	935
Burgess sand	976	984
Miss. Lime	991	1,040

CASING RECORD New Used
Report all strings set-conductor, surface, intermediate, production, etc.

Purpose of String	Size Hole Drilled	Size Casing Set (in O.D.)	Weight Lbs/Ft.	Setting Depth	Type of Cement	#Sacks Used	Type and Percent Additives
Surface	9 5/8	7"	17	21.80	neat	6	none
Production	6 1/4	4 1/2"	10.5	1031.85	pos	158	premium Gel

PERFORATION RECORD
Shots Per Foot Specify Footage of Each Interval Perforated

Shots Per Foot	Specify Footage of Each Interval Perforated	Acid, Fracture, Shot, Cement Squeeze Record (Amount and Kind of Material Used)	Depth
1	911-917	10 sacks 10 x 20	
	923-926	15 sacks 18 x 12	
	928-933		
	977-982		

TUBING RECORD Size Set At Packer at Liner Run Yes No

Date of First Production **5/12/88** Producing Method Flowing Pumping Gas Lift Other (explain).....

Oil Gas Water Gas-Oil Ratio Gravity