

19-14-24E P1

STATE CORPORATION COMMISSION OF KANSAS
OIL & GAS CONSERVATION DIVISION



WELL COMPLETION OR RECOMPLETION FORM
ACO-1 WELL HISTORY

DESCRIPTION OF WELL AND LEASE

Operator: license # 9690 name **Prairie Resources**
address 7800 W. 110th Street, Suite 122
City/State/Zip Overland Park, Kansas 66210

Operator Contact Person **Robert A. White**
Phone (913) 451-3807

Contractor: license # 6849 name **Layne-Western Co., Inc**

Wellsite Geologist
Phone

PURCHASER **Amoco Production Co.**

Designate Type of Completion
 New Well Re-Entry Workover

OH SWD Temp Abd
 Gas Inj Delayed Comp.
 Dry Other (Core, Water Supply etc.)

If OWWO: old well info as follows:
Operator
Well Name
Comp. Date Old Total Depth

WELL HISTORY

Drilling Method: Mud Rotary Air Rotary Cable
5-20-85 5-23-85 5-23-85
Date Date Reached TD Completion Date

787 759
Total Depth PBTB

Amount of Surface Pipe Set and Cemented at 21 feet

Multiple Stage Cementing Collar Used? Yes No

If Yes, Show Depth Set feet

If alternate 2 completion, cement circulated from 0 feet depth to 21 w/ 3 SX cmt

API NO. 15 - 091-21,523
County Johnson
SW NW NW Sec 19 Twp 14 Rge 24

4125 Ft North from Southeast Corner of Section
4655 Ft West from Southeast Corner of Section
(Note: locate well in section plat below)

Lease Name **Ridgeview** Well# 3A

Field Name **Paola-Rantoul Northeast**

Producing Formation **Lower Squirrel**

Elevation: Ground 1058 KB 1062

Section Plat

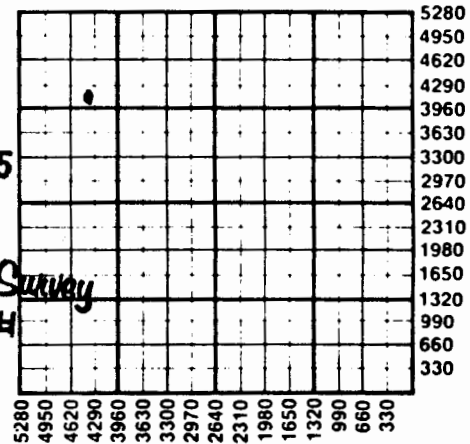

AUG 02 1985

State Geological Survey
WICHITA BRANCH

WATER SUPPLY INFORMATION

Source of Water:
Division of Water Resources Permit #

Groundwater Ft North From Southeast Corner and
(Well) Ft West From Southeast Corner of
Sec Twp Rge East West

Surface Water 4125 Ft North From Southeast Corner and
(Stream, Pond etc.) 4640 Ft West From Southeast Corner
Sec 19 Twp 14 Rge 24 East West

Other (explain) (purchased from city, R.W.D.#)

Disposition of Produced Water: Disposal Repressuring

Docket #

INSTRUCTIONS: This form shall be completed in duplicate and filed with the Kansas Corporation Commission, 200 Colorado Derby Building, Wichita, Kansas 67202, within 90 days after completion or recompletion of any well. Rules 82-3-130 and 82-3-107 apply.

Information on side two of this form will be held confidential for a period of 12 months if requested in writing and submitted with the form. See rule 82-3-107 for confidentiality in excess of 12 months.

One copy of all wireline logs and drillers time log shall be attached with this form. Submit CP-4 form with all plugged wells. Submit CP-111 form with all temporarily abandoned wells.

Operator Name Prairie Resources Lease Name Ridgeview Well# 3A SEC 19 TWP. 14 RGE. 24 East West

WELL LOG

INSTRUCTIONS: Show important tops and base of formations penetrated, Depth Pressure. Report all drill stem tests giving interval tested, time tool open and closed, flowing and shut-in pressures, when shut-in pressure reached stat level, hydrostatic pressures, bottom hole temperature, fluid recovery, and flow rate to surface during test. Attach extra sheet if more space is needed. Attach copy of log.

- Drill Stem Tests Taken Yes No
 Samples Sent to Geological Survey Yes No
 Cores Taken Yes No

PROVISIONAL
 Formation Description
 Log Sample

Top Bottom
 360

TUBING RECORD size set at packer at		Liner Run <input type="checkbox"/> Yes <input type="checkbox"/> No	
Date of First Production <u>7-18-85</u>	Producing method <input type="checkbox"/> flowing <input checked="" type="checkbox"/> pumping <input type="checkbox"/> gas lift <input type="checkbox"/> Other (explain)		
Estimated Production Per 24 Hours	Oil <u>2</u> Bbls	Gas <u>TR</u> MCF	Water <u>.25</u> Bbls
			Gas-Oil Ratio CFPB
			Gravity <u>27.0</u>

- Disposition of gas: vented
 sold
 used on lease

- METHOD OF COMPLETION**
 open hole perforation
 other (specify)
 Dually Completed.
 Commingled

PRODUCTION INTERVAL

CASING RECORD <input checked="" type="checkbox"/> new <input type="checkbox"/> used							
Report all strings set - conductor, surface, intermediate, production, etc.							
Purpose of string	size hole drilled	size casing set (in O.D.)	weight lbs/ft.	setting depth	type of cement	# sacks used	type and percent additives
Surface	8"	6.1/4"	14	21	Portland	3	None
Production	5.5/8"	2.7/8. 1QRnd	6.7	759	Pozz.		2% NaCl

PERFORATION RECORD		Acid, Fracture, Shot, Cement Squeeze Record	
shots per foot	specify footage of each interval perforated	(amount and kind of material used)	Depth
<u>2</u>	<u>717-721</u>	<u>30 Gallons 15M HCl</u> <u>5 sacks 18-20 Sand</u> <u>20 Sacks 10-12 Sand</u>	<u>717-72</u>