

**WELL COMPLETION REPORT AND  
DRILLER'S LOG**

S. 7 T. 15S.R. 1 <sup>E</sup><sub>W</sub>

API No. 15 — 041 — 20056      **JAN 22 1982**  
County                      Number

Loc. C N/2 NE NE  
County Marion Dickinson

Operator  
B M & S Oil Company

Address  
Box 316      Canton, Ks. 67428

Well No. 1      Lease Name Hagg

Footage Location  
feet from (N) (S) line                      feet from (E) (W) line

Principal Contractor  
Ks. Drlg. & Well Serv., Inc.      Geologist

Spud Date 8-17-81      Date Completed 8-21-81      Total Depth 2660'      P.B.T.D.

Directional Deviation      Oil and/or Gas Purchaser

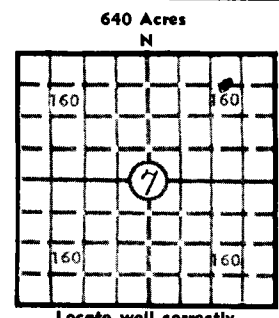

Locate well correctly  
Elev.: Gr. 1320  
DF \_\_\_\_\_ KB \_\_\_\_\_

**CASING RECORD**

Report of all strings set — surface, intermediate, production, etc.

Purpose of string	Size hole drilled	Size casing set (in O.D.)	Weight lbs/ft.	Setting depth	Type cement	Sacks	Type and percent additives
Surface		8 5/8"		146'	Class A Common	100	2% CACL
Production		4 1/2"		2657' KB	60/40 Pozmix	65	

**LINER RECORD**

**PERFORATION RECORD**

Top, ft.	Bottom, ft.	Sacks cement	Shots per ft.	Size & type	Depth interval
			2	V.J.	2602-11

Size	Setting depth	Packer set at
2 FUE	2640	

**ACID, FRACTURE, SHOT, CEMENT SQUEEZE RECORD**

Amount and kind of material used	STATE DEPT. OF REVENUE COMMISSION
	RECEIVED NOV 5 1981 CONSERVATION DIVISION Wichita Kansas

**INITIAL PRODUCTION**

Date of first production <u>9/14/81</u>	Producing method (flowing, pumping, gas lift, etc.) <u>Pumping</u>			
RATE OF PRODUCTION PER 24 HOURS	Oil <u>7</u> bbls.	Gas MCF	Water <u>4</u> bbls.	Gas-oil ratio CFPB
Disposition of gas (vented, used on lease or sold)		Producing interval (s)		

INSTRUCTIONS: As provided in KCC Rule 82-2-125, within 90 days after completion of a well, one completed copy of this Drillers Log shall be transmitted to the State Geological Survey of Kansas, 4150 Monroe Street, Wichita, Kansas 67209. Copies of this form are available from the Conservation Division, State Corporation Commission, 245 No. Water, Wichita, Kansas 67202. Phone AC 316-522-2206. If confidential custody is desired, please note Rule 82-2-125. Drillers Logs will be on open file in the Oil and Gas Division, State Geological Survey of Kansas, Lawrence, Kansas 66044.

Operator **B M & S Oil Company** DESIGNATE TYPE OF COMP.: OIL, GAS, DRY HOLE, SWDW, ETC.: *Oil*

Well No. **1** Lease Name **Hagg**

S 7 T 15 R 1 <sup>(E)</sup> W

**WELL LOG**

Show all important zones of porosity and contents thereof; cored intervals, and all drill-stem tests, including depth interval tested, cushion used, time tool open, flowing and shut-in pressures, and recoveries.

SHOW GEOLOGICAL MARKERS, LOGS RUN, OR OTHER DESCRIPTIVE INFORMATION.

FORMATION DESCRIPTION, CONTENTS, ETC.	TOP	BOTTOM	NAME	DEPTH
0-1968				
lime, shale				
1968-2035				
Lans.				
2035-2400				
Lans. K.C.				
2400-2545				
lime, shale				
2545-2602				
Lans. K.C.				
2602-2642				
Miss				
2642-2660				
Miss Lime				
2660				
TD				

USE ADDITIONAL SHEETS, IF NECESSARY, TO COMPLETE WELL RECORD.

Date Received \_\_\_\_\_

Signature *Henry E. ...*

Title *Partner*

Date *12/30/81*