

KANSAS



State Geological Survey  
WICHITA BRANCH

3082 FSL and 5100 FEL KCC Record

**WELL COMPLETION REPORT AND  
DRILLER'S LOG**

S. 12 T. 15 R. 20 E  
~~27E~~

Loc. NW<sup>1</sup>/<sub>4</sub>

County Douglas

API No. 15 — 045 — 20183  
County Number

Operator  
Reese Exploration, Inc.

Address  
P. O. Box 11598 K. C. Mo. 64138

Well No. 3-80 Lease Name Duayne Madl

Footage Location  
570 feet from (N) (S) line 50 feet from (E) (W) line

Principal Contractor C & R Drilling Co. Geologist

Spud Date 12-19-80 Date Completed 12-20-80 Total Depth 881 P.B.T.D.

Directional Deviation Oil and/or Gas Purchaser  
Maclaskey

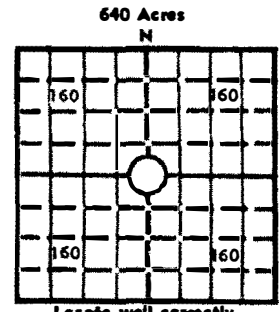

Elev.: Gr. \_\_\_\_\_

DF \_\_\_\_\_ KB \_\_\_\_\_

**CASING RECORD**

Report of all strings set — surface, intermediate, production, etc.

Purpose of string	Size hole drilled	Size casing set (in O.D.)	Weight lbs/ft.	Setting depth	Type cement	Sacks	Type and percent additives
Surface	8 7/8	6 1/4	17#	40	Portland	4	none
2"	5 1/4	2 3/8	4#	850	"	90	2% Gel

**LINER RECORD**

**PERFORATION RECORD**

Top, ft.	Bottom, ft.	Sacks cement	Shots per ft.	Size & type	Depth interval
none					

**TUBING RECORD**

Size	Setting depth	Packer set at
none		

**ACID, FRACTURE, SHOT, CEMENT SQUEEZE RECORD**

Amount and kind of material used	Depth interval treated
Frac - Gelled Water - 60 sacks sand	

**INITIAL PRODUCTION**

Date of first production March 1, 1981 Producing method (flowing, pumping, gas lift, etc.) Pumping

RATE OF PRODUCTION PER 24 HOURS  
Oil 1 bbls. Gas 0 MCF Water 0 bbls. Gas-oil ratio \_\_\_\_\_ CFPB

Disposition of gas (vented, used on lease or sold) \_\_\_\_\_ Producing interval (s) \_\_\_\_\_

INSTRUCTIONS: As provided in KCC Rule 82-2-125, within 90 days after completion of a well, one completed copy of this Drillers Log shall be transmitted to the State Geological Survey of Kansas, 4150 Monroe Street, Wichita, Kansas 67209. Copies of this form are available from the Conservation Division, State Corporation Commission, 245 No. Water, Wichita, Kansas 67202. Phone AC 316-522-2206. If confidential custody is desired, please note Rule 82-2-125. Drillers Logs will be on open file in the Oil and Gas Division, State Geological Survey of Kansas, Lawrence, Kansas 66044.



12-15-20E

# WELL RECORD

Well No. 3/80 Farm Madl Producer Reese Exploration

Location FWL 50 ft. FSL <sup>570</sup> 410 ft Sec. 12 Twp. 15 Rg. 20E

Elevation \_\_\_\_\_ State Kansas County Douglas

Kind (Oil, Gas, Water, Dry Hole) Oil Contractor C & R Drilling

Producing formation \_\_\_\_\_ Top \_\_\_\_\_ Bottom \_\_\_\_\_

Shot with \_\_\_\_\_ qts. \_\_\_\_\_ from \_\_\_\_\_ to \_\_\_\_\_

Packer Set at \_\_\_\_\_ Kind \_\_\_\_\_ Size \_\_\_\_\_

Liner \_\_\_\_\_ from \_\_\_\_\_ to \_\_\_\_\_ Perforated from \_\_\_\_\_ to \_\_\_\_\_

## LOG

Thickness	Strata	Depth	Thickness	Strata	Depth
12	Soil & Clay	12	8	Lime	782
53	Sand & Rock	65	15	Shale	797
2	Lime	67	3	Lime	800
144	Shale	211	17	Shale	817
4	Lime	215	6	Lime	823
7	Shale	222	33	Shale	856
12	Lime	234	8	Oil Sand	864
8	Shale	242	2	Broken Sand	866
9	Lime	251	15	Shale	881
6	Shale	256			
16	Lime	273	34	Joints 25ft 2in pipe	858
34	Shale	307	1	Joint 24.5 ft 2in pipe	859
18	Lime	325			860
75	Shale	400	SN	850 @6ft	861
22	Lime	422	FS	875	862
18	Shale	440			863
8	Lime	448			864
23	Shale	471			865
15	Lime	486			866
19	Shale	507			
23	Lime	530			
7	Shale	537			
24	Lime	561			
3	Shale	564			
16	Lime	580			
169	Shale	749			
8	Lime	757			
6	Shale	763			
4	Lime	767			
7	Shale	774			

Total Depth	881		
Open Hole	Casing Surface	29.20	
Casing	at		
Casing	at		
Casing	at		
Cement			
Tubing			
Rods			
Additional Information	CORE		
856--857	Sand Oil	Good	
858	"	"	
859	"	"	
860	"	"	
861	"	"	
862	"	"	
863	"	"	
864	"	"	
865	Broken Sand	Poor	
866	"	"	
	Shale		

Date Completed \_\_\_\_\_

O. K. \_\_\_\_\_

Superintendent \_\_\_\_\_