

KANSAS

WELL COMPLETION REPORT AND DRILLER'S LOG

State Geological Survey WICHITA BRANCH

S. 12 T. 15 R. 20 W

Loc. SW 1/4

County Douglas

API No. 15 — 045 — 20,287
County Number

Operator
Kent Fry

Address
P. O. Box 3747, Lawrence, KS 66044

Well No. 8-81 Lease Name Jones

Footage Location 1200 feet from (N) (S) line 1407 FSL & 4598 FEL - KCC record 600 feet from (E) (W) line of SW 1/4

Principal Contractor
C & R Drilling, Inc.

Geologist

Spud Date 10/22/81 Date Completed 10/23/81 Total Depth 895 P.B.T.D.

Directional Deviation Oil and/or Gas Purchaser Maclaskey

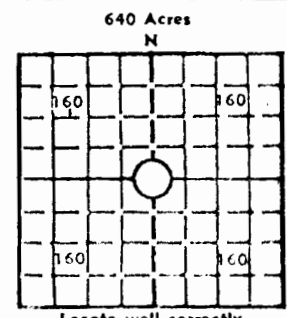

Elev.: Gr. _____
DF _____ KB _____

CASING RECORD

Report of all strings set— surface, intermediate, production, etc.

| Purpose of string | Size hole drilled | Size casing set (in O.D.) | Weight lbs./ft. | Setting depth | Type cement | Sacks | Type and percent additives |
|-------------------|-------------------|---------------------------|-----------------|---------------|-------------|-------|----------------------------|
| Surface | 9 1/4 | 6 1/4 | | 80 | Portland | 117 | |
| Production | 5 1/4 | 2 3/8 | 2.75 | 892 | | | |
| | | | | | | | |
| | | | | | | | |

LINER RECORD

PERFORATION RECORD

| Top, ft. | Bottom, ft. | Sacks cement | Shots per ft. | Size & type | Depth interval |
|----------|-------------|--------------|---------------|----------------|----------------|
| | | | 3 | 1 9/16 DML gun | 841-847 |

TUBING RECORD

| Size | Setting depth | Packer set at |
|------|---------------|---------------|
| | | |

ACID, FRACTURE, SHOT, CEMENT SQUEEZE RECORD

| Amount and kind of material used | Depth interval treated |
|---|------------------------|
| Fractured with 35 sacks of sand and 70 bbls water | 841-847 |
| | |
| | |

INITIAL PRODUCTION

| | |
|--|--|
| Date of first production 11/24/81 | Producing method (flowing, pumping, gas lift, etc.) pumping |
| RATE OF PRODUCTION PER 24 HOURS | Oil 3 bbls. Gas MCF Water 3 bbls. Gas-oil ratio CFPB |
| Disposition of gas (vented, used on lease or sold) | Producing interval(s) 841-847 |

INSTRUCTIONS: As provided in KCC Rule 82-2-125, within 90 days after completion of a well, one completed copy of this Drillers Log shall be transmitted to the State Geological Survey of Kansas, 4150 Monroe Street, Wichita, Kansas 67209. Copies of this form are available from the Conservation Division, State Corporation Commission, 245 No. Water, Wichita, Kansas 67202. Phone AC 316-522-2206. If confidential custody is desired, please note Rule 82-2-125. Drillers Logs will be on open file in the Oil and Gas Division, State Geological Survey of Kansas, Lawrence, Kansas 66044.

12-13-205

DESIGNATE TYPE OF WELL
DRY HOLE, SWDW, ETC

011

Well No.

Lease Name

Jones

S. T. R. E. W.

WELL LOG

Show all important zones of porosity and contents thereof; cored intervals, and all drill-stem tests, including depth interval tested, cushion used, time tool open, flowing and shut-in pressures, and recoveries.

SHOW GEOLOGICAL MARKERS, LOGS RUN, OR OTHER DESCRIPTIVE INFORMATION.

| FORMATION DESCRIPTION, CONTENTS, ETC. | TOP | BOTTOM | NAME | DEPTH |
|---------------------------------------|-----|--------|------|-------|
| Soil & Clay | 0 | 7 | | |
| Sand | 7 | 52 | | |
| Shale | 52 | 195 | | |
| Lime | 195 | 200 | | |
| Shale | 200 | 205 | | |
| Lime | 205 | 219 | | |
| Shale | 219 | 249 | | |
| Lime | 249 | 258 | | |
| Shale | 258 | 293 | | |
| Lime | 293 | 311 | | |
| Shale | 311 | 386 | | |
| Lime | 386 | 408 | | |
| Shale | 408 | 423 | | |
| Lime | 423 | 430 | | |
| Shale | 430 | 439 | | |
| Lime | 439 | 443 | | |
| Shale | 443 | 454 | | |
| Lime | 454 | 472 | | |
| Shale | 472 | 492 | | |
| Lime | 492 | 514 | | |
| Shale | 514 | 524 | | |
| Lime | 524 | 547 | | |
| Shale | 547 | 551 | | |
| Lime | 551 | 555 | | |
| Shale | 555 | 559 | | |
| Lime | 559 | 564 | | |
| Shale | 564 | 738 | | |
| Lime | 738 | 745 | | |
| Shale | 745 | 765 | | |
| Lime | 765 | 770 | | |
| Shale | 770 | 785 | | |
| Lime | 785 | 789 | | |
| Shale | 789 | 804 | | |
| Lime | 804 | 809 | | |
| Shale | 809 | 831 | | |
| Lime | 831 | 833 | | |
| Shale | 833 | 841 | | |
| Sand-solid | 842 | 845 | | |
| Sand-broken | 845 | 850 | | |
| Shale | 850 | 850 | | |

USE ADDITIONAL SHEETS, IF NECESSARY, TO COMPLETE WELL RECORD.

Date Received

Signature

Title

Date