

3AS

IMPORTANT
Kans. Geo. Survey request
samples on this well.

WELL COMPLETION REPORT AND DRILLER'S LOG

S. 34 T. 15S R. 20 ^E
Loc. 670' FEL 1000' FSL
County Franklin

API No. 15 — 059 — 21,597
County Number

Operator
P & W Oil

Address
5987 Miller, Arvada, CO 80004

Well No. BL #5 Lease Name Bleakley

Footage Location
1000' feet from (S) line 670' feet from (E) line

Principal Contractor Wellsville Development Geologist none

Spud Date 11/14/80 Date Completed 11/17/80 Total Depth 725' P.B.T.D.

Directional Deviation Oil and/or Gas Purchaser
La Jet, Inc

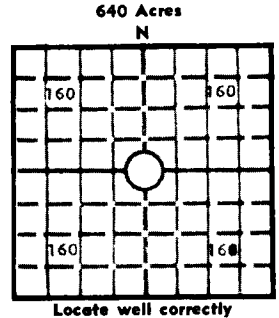

Elev.: Gr. _____
DF _____ KB _____

CASING RECORD

Report of all strings set — surface, intermediate, production, etc.

Purpose of string	Size hole drilled	Size casing set (in O.D.)	Weight lbs/ft.	Setting depth	Type cement	Sacks	Type and percent additives
surface	8-1/8	6-1/4	17#	25'	Neet	1	
production	5-1/4	2-3/8	3.75	700'	Portland A	145	2% gel

LINER RECORD

PERFORATION RECORD

Top, ft.	Bottom, ft.	Sacks cement	Shots per ft.	Size & type	Depth interval
			21	1-11/16 glass	665-686

Size	Setting depth	Packer set at
2-3/8	700'	700'

ACID, FRACTURE, SHOT, CEMENT SQUEEZE RECORD

Amount and kind of material used	Depth interval treated
10 sx 12-30 sand	665-686
40 sx 10-20 sand	
100# water gel	

INITIAL PRODUCTION

Date of first production <u>11/28/80</u>	Producing method (flowing, pumping, gas lift, etc.) <u>pumping</u>			
RATE OF PRODUCTION PER 24 HOURS	Oil <u>1</u> bbls.	Gas <u>0</u> MCF	Water <u>0</u> bbls.	Gas-oil ratio <u>CFPB</u>
Disposition of gas (vented, used on lease or sold) <u>na</u>			Producing interval(s) <u>665-686</u>	

INSTRUCTIONS: As provided in KCC Rule 82-2-125, within 90 days after completion of a well, one completed copy of this Drillers Log shall be transmitted to the State Geological Survey of Kansas, 4150 Monroe Street, Wichita, Kansas 67209. Copies of this form are available from the Conservation Division, State Corporation Commission, 245 No. Water, Wichita, Kansas 67202. Phone AC 316-522-2206. If confidential custody is desired, please note Rule 82-2-125. Drillers Logs will be on open file in the Oil and Gas Division, State Geological Survey of Kansas, Lawrence, Kansas 66044.

Operator _____ DESIGNATE TYPE OF COMP.: OIL, GAS, DRY HOLE, SWDW, ETC.:

Well No. _____ Lease Name _____

S _____ T _____ R _____ E _____ W _____

WELL LOG

Show all important zones of porosity and contents thereof; cored intervals, and all drill-stem tests, including depth interval tested, cushion used, time tool open, flowing and shut-in pressures, and recoveries.

SHOW GEOLOGICAL MARKERS, LOGS RUN, OR OTHER DESCRIPTIVE INFORMATION.

FORMATION DESCRIPTION, CONTENTS, ETC.	TOP	BOTTOM	NAME	DEPTH
<i>See attached log</i>				

ADDITIONAL SHEETS, IF NECESSARY, TO COMPLETE WELL RECORD.

May H. Tolman

Signature

Controller

Title

5/20/81

Date