

KANSAS DRILLERS LOG

IMPORTANT
 State Geological Survey
 Kansas Geological Survey request
 WICHITA BRANCH
 Sample on this well.

S. 6 T. 15 R. 21 E. X W
 Loc. NW 100' FNL & 300' FEL
 2940 FEL -KCC
 County Douglas

API No. 15 — 045 — 20,113
 County Number

Operator
P & W Oil

Address
5987 Miller St. Arvada, Colo 80004

Well No. # G1 Lease Name Glover

Footage Location
100' feet from (N) line 2940 FEL-KCC 300' feet from (E) line

Principal Contractor Wellsville Development Geologist none

Spud Date 9/14/79 Total Depth 650' P.B.T.D.

Date Completed 9/18/79 Oil Purchaser Town Oil - LaJet, Inc

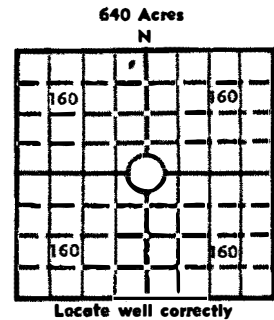

Elev.: Gr. _____
 DF _____ KB _____

CASING RECORD

Report of all strings set — surface, intermediate, production, etc.

Purpose of string	Size hole drilled	Size casing set (in O.D.)	Weight lbs/ft.	Setting depth	Type cement	Sacks	Type and percent additives
surface	8-1/8	6-1/4	17#	25	Neet	1	
production	5-1/4	2-3/8	3.75	619	Portland A	72	2% gel

LINER RECORD

PERFORATION RECORD

Top, ft.	Bottom, ft.	Sacks cement	Shots per ft.	Size & type	Depth interval

Size	Setting depth	Packer set at
2-3/8	619	619

ACID, FRACTURE, SHOT, CEMENT SQUEEZE RECORD

Amount and kind of material used	Depth interval treated
8 sx 12-30 sand	619-630
31 sx 10-20 sand	
4 sx 20-40 sand	
85 # water gel	

INITIAL PRODUCTION

Date of first production 4/15/80 Producing method (flowing, pumping, gas lift, etc.) pumping

RATE OF PRODUCTION PER 24 HOURS	Oil	Gas	Water	Gas-oil ratio
	<u>1</u> bbls.	<u>0</u> MCF	<u>0</u> bbls.	CFPB

Disposition of gas (vented, used on lease or sold) na Producing interval (s) 619-630

INSTRUCTIONS: As provided in KCC Rule 82-2-125, within 90 days after completion of a well, one completed copy of this Drillers Log shall be transmitted to the State Geological Survey of Kansas, 4150 Monroe Street, Wichita, Kansas 67209. Copies of this form are available from the Conservation Division, State Corporation Commission, 3830 So. Meridian (P.O. Box 17027), Wichita, Kansas 66217. Phone AC 316-522-2206. If confidential custody is desired, please note Rule 82-2-125. Drillers Logs will be on open file in the Oil and Gas Division, State Geological Survey of Kansas, Lawrence, Kansas 66044.

Operator

DESIGNATE TYPE OF COMP.: OIL, GAS, DRY HOLE, SWDW, ETC.:

Well No.

Lease Name

S _____ T _____ R _____ E _____ W _____

WELL LOG

Show all important zones of porosity and contents thereof; cored intervals, and all drill-stem tests, including depth interval tested, cushion used, time tool open, flowing and shut-in pressures, and recoveries.

SHOW GEOLOGICAL MARKERS, LOGS RUN, OR OTHER DESCRIPTIVE INFORMATION.

FORMATION DESCRIPTION, CONTENTS, ETC.	TOP	BOTTOM	NAME	DEPTH
<p><i>see attached log</i></p>				

USE ADDITIONAL SHEETS, IF NECESSARY, TO COMPLETE WELL RECORD.

Date Received

Mary H. Tolman

Signature

Controller

Title

7/20/81

Date

6-15-2/E

Farm - Glover

Contractor - Wellsville Development, Inc

County - Douglas

Drilling Started -

Well - G 1

Drilling Completed -

Lease Owner - P&W

Permanent Casing

<u>Size</u>	<u>Amount</u>	<u>Condition</u>	<u>Cement</u>
<u>Strata</u>	<u>Total Depth</u>		
Soil & Clay	12		
Lime	15		
Slate	19		
Lime	27		
Shale	36		
Lime	48		
Shale	259		
Lime	284		
Shale & Shells	202		
Lime	207		
Shale & Shells	212		
Lime	215		
Shale	219		
Lime	226		
Shale	246		
Lime	251		
Shale	272		
Lime	305		
Shale	315		
Lime	333		
Shale	337		
Lime	355		
Shale	515		
Lime	525		
Shale & Shells	529		
Lime Shells	533		
Shale	562		
Lime	568		
Shale & Shells	584		
Lime	590		
Shale	596		
Lime	605		
Shale	510		
Lime	613		
Shale	615		
Lime	618		
Shale	619		
Oil sand	630		
Shale, broken sand	650	TD	