

KANSAS DRILLERS LOG

IMPORTANT
Kans. Geo. Survey request
samples on this well.

152/21-20478

S. 20 T. 15 R. 23 E
NW NW SW NE
County Miami

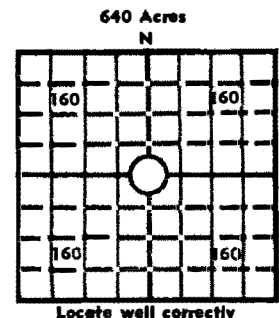

Elev.: Gr. _____
DF _____ KB _____

API No. 15 — 121 — 20,478 3780 FSL and 2430 FEL
County Number -KCC

Operator
Lutz & Schuetz % William Schuetz

Address
Spring Hill, Kansas 66083

Well No. #1 Lease Name Lutz & Scheutz

Footage Location
1500 feet from (N) (S) line 210 feet from (E) (W) line

Principal Contractor Town Oil Co. Geologist _____

Spud Date April 20, 1977 Total Depth 705 P.B.T.D. _____

Date Completed May 13, 1977 Oil Purchaser _____

CASING RECORD

Report of oil strings set — surface, intermediate, production, etc.

Purpose of string	Size hole drilled	Size casing set (in O.D.)	Weight lbs/ft.	Setting depth	Type cement	Sacks	Type and percent additives
Surface	10"	8"		21'			
Water string	8"	7"		582'			

LINER RECORD

PERFORATION RECORD

Top, ft.	Bottom, ft.	Sacks cement	Shots per ft.	Size & type	Depth interval

TUBING RECORD

Size	Setting depth	Packer set at

ACID, FRACTURE, SHOT, CEMENT SQUEEZE RECORD

Amount and kind of material used	Depth interval treated

INITIAL PRODUCTION

Date of first production Dry Hole Producing method (flowing, pumping, gas lift, etc.) No production

RATE OF PRODUCTION PER 24 HOURS	Oil bbls.	Gas MCF	Water bbls.	Gas-oil ratio	CFPB

Disposition of gas (vented, used on lease or sold) _____ Producing interval(s) _____

INSTRUCTIONS: As provided in KCC Rule 82-2-125, within 90 days after completion of a well, one completed copy of this Drillers Log shall be transmitted to the State Geological Survey of Kansas, 4150 Monroe Street, Wichita, Kansas 67209. Copies of this form are available from the Conservation Division, State Corporation Commission, 3830 So. Meridian (P.O. Box 17027), Wichita, Kansas 66217. Phone AC 316-522-2206. If confidential custody is desired, please note Rule 82-2-125. Drillers Logs will be on open file in the Oil and Gas Division, State Geological Survey of Kansas, Lawrence, Kansas 66044.

20-15-25 E

Operator Town Oil Co. DESIGNATE TYPE OF COMP.: OIL, GAS, DRY HOLE, SWDW, ETC.:

Well No. 1 Lease Name Lutz & Schuetz Dry Hole

S 20 T 15 R 23 E
XX

WELL LOG
Show all important zones of porosity and contents thereof; cored intervals, and all drill-stem tests, including depth interval tested, cushion used, time tool open, flowing and shut-in pressures, and recoveries. SHOW GEOLOGICAL MARKERS, LOGS RUN, OR OTHER DESCRIPTIVE INFORMATION.

FORMATION DESCRIPTION, CONTENTS, ETC.			TOP	BOTTOM	NAME	DEPTH
3	Soil	3	43	Light Shale	666	
15	Lime	18	2	Black Lime	668	
12	Shale	30	37	Dark Shale	705	
18	Lime (Water)	48				
97	Shale	145				
27	Lime	172			T.D.	705
6	Shale	178				
5	Lime	183				
9	Shale	192				
4	Red Bed	196				
8	Shale	204				
5	lime	209				
38	Shale	247				
2	Lime	249				
12	Shale	261				
19	Lime	280				
6	Shale	286				
22	Lime	308				
4	Shale	312				
15	Lime	327 (Hertha)				
4	Shale	331				
6	Sandy Lime	337				
12	Shale	349				
1	Lime	350				
136	Shale	486				
26	Green Shale	512				
6	Lime	518				
3	Shale	521				
15	Lime	536				
20	Shale	556				
4	Lime	560				
5	Shale & Slate	565				
3	Lime	568				
3	Shale	571				
8	Lime	579				
26	Shale	605				
9	Lime	614				
3	Dark Shale	617				
6	Light Sandy Shale	623				

USE ADDITIONAL SHEETS, IF NECESSARY, TO COMPLETE WELL RECORD.

Date Received	<i>Winton Lutz</i> Signature
	Partner Title
	May 17, 1977 Date