

KANSAS DRILLERS LOG

IMPORTANT
Kans. Geo. Survey request
samples on this well.

S. 8 T. 16 R. 20 ^E_W
Loc. 990' FEL & 700' FSL
900-1000
County Franklin

API No. 15 — 059 — 20,354
County Number

Operator
Barney B. Shiotani c/o John E. Hickox

Address
Box 4482 Topeka, Kansas 66604

Well No. #1 Lease Name
1000 J. A. Baldwin, Jr.

Footage Location *900* east 700 south
990 feet from ~~ZXZX~~ line feet from ~~ZXZX~~ line

Principal Contractor Fred Green Geologist John E. Hickox

Spud Date 6-15-77 Total Depth 743' P.B.T.D.

Date Completed 8-8-77 Oil Purchaser

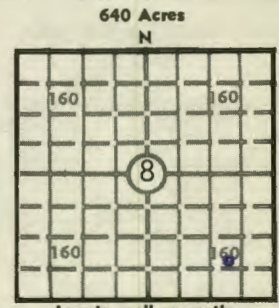

Locate well correctly
Elev.: Gr. _____
DF _____ KB _____

Note: Lost hole at approx. 550'. **CASING RECORD** Moved location for new hole 8' south.

Report of all strings set — surface, intermediate, production, etc.

Purpose of string	Size hole drilled	Size casing set (in O.D.)	Weight lbs/ft.	Setting depth	Type cement	Sacks	Type and percent additives
1st Surface string	9"	7"		20'	Common	3	
2nd Surface string	9"	7"		20'	Common	3	
Production	6-1/4"	4-1/2"		651"	Common	100	

LINER RECORD

PERFORATION RECORD

Top, ft.	Bottom, ft.	Sacks cement	Shots per ft.	Size & type	Depth interval

TUBING RECORD		
Size	Setting depth	Packer set at

ACID, FRACTURE, SHOT, CEMENT SQUEEZE RECORD

Amount and kind of material used	Depth interval treated

INITIAL PRODUCTION

Date of first production		Producing method (flowing, pumping, gas lift, etc.)			
RATE OF PRODUCTION PER 24 HOURS	Oil	Gas	Water	Gas-oil ratio	
	bbls.	MCF	bbls.	CFPB	
Disposition of gas (vented, used on lease or sold)			Producing interval (s)		

INSTRUCTIONS: As provided in KCC Rule 82-2-125, within 90 days after completion of a well, one completed copy of this Drillers Log shall be transmitted to the State Geological Survey of Kansas, 4150 Monroe Street, Wichita, Kansas 67209. Copies of this form are available from the Conservation Division, State Corporation Commission, 3830 So. Meridian (P.O. Box 17027), Wichita, Kansas 66217. Phone AC 316-522-2206. If confidential custody is desired, please note Rule 82-2-125. Drillers Logs will be on open file in the Oil and Gas Division, State Geological Survey of Kansas, Lawrence, Kansas 66044.

Operator Barney B. Shiotani

DESIGNATE TYPE OF COMP.: OIL, GAS, DRY HOLE, SWDW, ETC.:
Dry hole, temporarily

Well No. 1

Lease Name J. A. Baldwin, Jr.

abandoned

S 8 T 16 R 20 E
XX

WELL LOG

Show all important zones of porosity and contents thereof; cored intervals, and all drill-stem tests, including depth interval tested, cushion used, time tool open, flowing and shut-in pressures, and recoveries.

SHOW GEOLOGICAL MARKERS, LOGS RUN, OR OTHER DESCRIPTIVE INFORMATION.

FORMATION DESCRIPTION, CONTENTS, ETC.	TOP	BOTTOM	NAME	DEPTH
Lime and shale	surface	409	Base Hertha	409'
Shale and sand	409	564	Knobtown sd	413'
Lime and shale	564	666	Peru sd	532'
Sand and shale, show of gas	666	734	Lenepah-Altamont	564'
Sand and shale, water	734	743	Base Ft. Scott	666'
			1st Squirrel sd	668'
			2nd Squirrel sd	734'
			RTD	668'
			CTTD	743'

USE ADDITIONAL SHEETS, IF NECESSARY, TO COMPLETE WELL RECORD.

Date Received

John E. Hickox

 Signature
 John E. Hickox

 Geologist
 Box 4482

 Title
 Topeka, Kansas

 Date
 September 28, 1977