

State Geological Survey
KANSAS WICHITA BRANCH

IMPORTANT
Kans. Geo. Survey request
samples on this well.

S. 7 T. 16 R. 21 ^E/_W
Loc. NE SE SW
SW-1000
County Franklin

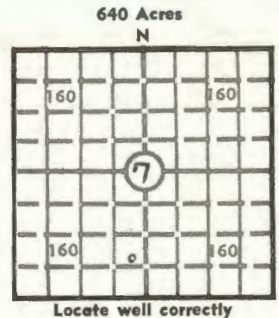

Locate well correctly
Elev.: Gr. _____
DF _____ KB _____

API No. 15 — 059 — 20,221
County Number

Operator
Rader Oil Company

Address
Route #1 Eudora, Kansas 66025

Well No. #2 Lease Name McGlashon 395 FSL; 3137 FEL-1000

Footage Location
825' from S. line 165' from E. line
feet from (N) (S) line feet from (E) (W) line

Principal Contractor Kent Drilling Co. Geologist Dick Rader

Spud Date August 7, 1975 Total Depth 750 P.B.T.D. _____

Date Completed Sept. 6, 1975 Oil Purchaser Bluebird Oil Co.

CASING RECORD

Report of all strings set — surface, intermediate, production, etc.

Purpose of string	Size hole drilled	Size casing set (in O.D.)	Weight lbs/ft.	Setting depth	Type cement	Sacks	Type and percent additives
Surface	10"	7"	24	40'	common	7	none
Production	6 1/4"	4 1/2"	10.5	746	salt sat. poz	100	10% salt, 50% poz, 2% gel

LINER RECORD

PERFORATION RECORD

Top, ft.	Bottom, ft.	Sacks cement	Shots per ft.	Size & type	Depth interval
			1	1/2" jet	668-671

Size	Setting depth	Packer set at
2"	666	

ACID, FRACTURE, SHOT, CEMENT SQUEEZE RECORD

Amount and kind of material used	Depth interval treated
20 sx. 12-30 sand, 20 sx. 10-20 sand, 5 sx. 8-12 sand	668-671

INITIAL PRODUCTION

Date of first production <u>Sept. 6, 1975</u>		Producing method (flowing, pumping, gas lift, etc.) <u>pumping</u>			
RATE OF PRODUCTION PER 24 HOURS	Oil <u>5</u> bbls.	Gas <u>0</u> MCF	Water <u>3</u> bbls.	Gas-oil ratio CFPB	
Disposition of gas (vented, used on lease or sold)			Producing interval (s) <u>668-671</u>		

INSTRUCTIONS: As provided in KCC Rule 82-2-125, within 90 days after completion of a well, one completed copy of this Drillers Log shall be transmitted to the State Geological Survey of Kansas, 4150 Monroe Street, Wichita, Kansas 67209. Copies of this form are available from the Conservation Division, State Corporation Commission, 3830 So. Meridian (P.O. Box 17027), Wichita, Kansas 66217. Phone AC 316-522-2206. If confidential custody is desired, please note Rule 82-2-125. Drillers Logs will be on open file in the Oil and Gas Division, State Geological Survey of Kansas, Lawrence, Kansas 66044.

Operator

Rader Oil Co.

DESIGNATE TYPE OF COMP.: OIL, GAS,
DRY HOLE, SWDW, ETC.:
Oil

Well No.

2

Lease Name

McGlashon

S 7 T 16 R 21 E
WK

WELL LOG

Show all important zones of porosity and contents thereof; cored intervals, and all drill-stem tests, including depth interval tested, cushion used, time tool open, flowing and shut-in pressures, and recoveries.

SHOW GEOLOGICAL MARKERS, LOGS RUN,
OR OTHER DESCRIPTIVE INFORMATION.

FORMATION DESCRIPTION, CONTENTS, ETC.	TOP	BOTTOM	NAME	DEPTH
Soil & Clay	0	10		
Lime	40	41		
Shale	41	49		
Lime	49	72		
Shale	72	114		
Lime	114	131		
Shale	131	211		
Lime	211	236		
Shale	236	291		
Lime	291	299		
Shale	299	328		
Lime	328	351		
Shale	351	360		
Lime	360	383		
Shale	383	387		
Lime	387	391		
Shale	391	396		
Lime	396	401		
Shale	401	566		
Lime	566	577		
Shale	577	619		
Lime	619	623		
Shale	623	632		
Lime	632	635		
Shale	635	665		
Sand	665	676	1st. Squirrel	665-676
Shale	676	705		
Lime	705	708		
Shale	708	719		
Sand	719	722.50	2nd. Squirrel	719-722.50
Shale	722.50	750 TD		

USE ADDITIONAL SHEETS, IF NECESSARY, TO COMPLETE WELL RECORD.

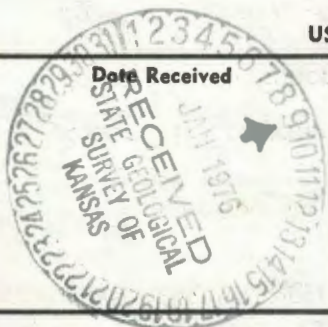

Richard Rader
Signature

Owner

Title

Sept. 18, 1975

Date