

State Geological Survey

15-059-20378

WICHITA BRANCH
KANSAS DRILLERS LOG

API No. 15 — 059-20 — 378
County Number

S. 7 T. 16 R. 21 E W

Loc. NE-SW-SE
NW-100
County Franklin

Operator
Rader Oil Co.

Address
R.R. #1

Well No. 9 Lease Name Stephens

Footage Location
1-000 feet from (S) line 1002 FSL: 1816 FEL-KCC 1,180 feet from (E) line

Principal Contractor Kent Drilling Co. Geologist Dick Rader

Spud Date Sept. 5, 1977 Total Depth 750 P.B.T.D.

Date Completed Nov. 22, 1977 Oil Purchaser Bluebird Oil Co.

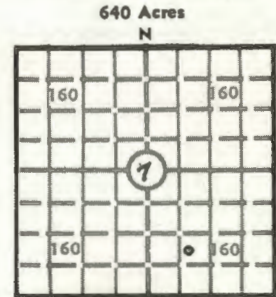

Elev.: Gr. _____

DF _____ KB _____

CASING RECORD

Report of all strings set — surface, intermediate, production, etc.

Purpose of string	Size hole drilled	Size casing set (in O.D.)	Weight lbs/ft.	Setting depth	Type cement	Sacks	Type and percent additives
Surface	9	7	24	37	common	9	none
Production	6 1/4	4 1/2	10.5	729	pozmix	100	salt, poz. gel. flo-seal

LINER RECORD

PERFORATION RECORD

Top, ft.	Bottom, ft.	Sacks cement	Shots per ft.	Size & type	Depth interval
			1	1/2 jet	707-710

Size	Setting depth	Packer set at
2"	704	

ACID, FRACTURE, SHOT, CEMENT SQUEEZE RECORD

Amount and kind of material used	Depth interval treated
40 sx. sand and 110 bbl. oil	707-710

INITIAL PRODUCTION

Date of first production		Producing method (flowing, pumping, gas lift, etc.) Pumping			
RATE OF PRODUCTION PER 24 HOURS	Oil <u>4</u> bbls.	Gas <u>0</u> MCF	Water <u>2</u> bbls.	Gas-oil ratio CFPB	
Disposition of gas (vented, used on lease or sold)			Producing interval (s) 707-710		

INSTRUCTIONS: As provided in KCC Rule 82-2-125, within 90 days after completion of a well, one completed copy of this Drillers Log shall be transmitted to the State Geological Survey of Kansas, 4150 Monroe Street, Wichita, Kansas 67209. Copies of this form are available from the Conservation Division, State Corporation Commission, 3830 So. Meridian (P.O. Box 17027), Wichita, Kansas 66217. Phone AC 316-522-2206. If confidential custody is desired, please note Rule 82-2-125. Drillers Logs will be on open file in the Oil and Gas Division, State Geological Survey of Kansas, Lawrence, Kansas 66044.

Operator **Rader Oil Co.** DESIGNATE TYPE OF COMP.: OIL, GAS, DRY HOLE, SWDW, ETC.: **Oil**

Well No. **9** Lease Name **Stephens**

S 7 T 16 R 21 E 4

WELL LOG

Show all important zones of porosity and contents thereof; cored intervals, and all drill-stem tests, including depth interval tested, cushion used, time tool open, flowing and shut-in pressures, and recoveries.

SHOW GEOLOGICAL MARKERS, LOGS RUN, OR OTHER DESCRIPTIVE INFORMATION.

FORMATION DESCRIPTION, CONTENTS, ETC.	TOP	BOTTOM	NAME	DEPTH
Soil & Clay s	0	10		
Lime	10	30		
Shale	30	37		
Lime	37	72		
Shale	72	112		
Lime	112	130		
Shale	130	207		
Lime	207	229		
Shale	229	257		
Lime	257	262		
Shale	262	284		
Lime	284	292		
Shale	292	321		
Lime	321	342		
Shale	342	353		
Lime	353	378		
Shale	378	380		
Lime	380	393		
Shale	393	397		
Lime	397	400		
Shale	400	560		
Lime	560	567		
Shale	567	577		
Lime	577	581		
Shale & Shells	581	668		
Shale	668	707		
Sand Oil	707	712	Squirrel	707-712
Shale	712	735 TD		

USE ADDITIONAL SHEETS, IF NECESSARY, TO COMPLETE WELL RECORD.

Date Received	<i>Richard Rader</i>
	Signature
	Owner
	Title
	Nov 22, 1977
	Date