

State Geol. Survey  
WICHITA BRANCH  
KANSAS DRILLERS LOG

15-121-20909  
Released  
12/16/81  
S. 13 T. 16 R. 21 E W

API No. 15 — 121 — 20909  
County Number

Operator  
Reese Exploration, Inc.

Address  
PO Box 11598, Kansas City, Mo. 64138

Well No. 18-79 Lease Name Meyers

Footage Location  
585 feet from ~~XX~~ (S) line 2500 feet from (X) (W) line

Principal Contractor Michael Drilling Geologist

Spud Date May 30, 1979 Total Depth 695' P.B.T.D.

Date Completed July 1979 Oil Purchaser Bluebird Oil Co.

Loc. \_\_\_\_\_  
County Miami

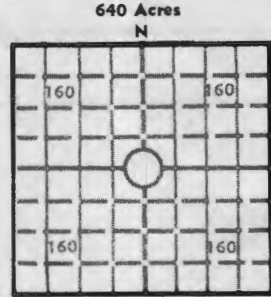

Elev.: Gr. \_\_\_\_\_  
DF \_\_\_\_\_ KB \_\_\_\_\_

CONFIDENTIAL

CASING RECORD

Report of all strings set — surface, intermediate, production, etc.

Purpose of string	Size hole drilled	Size casing set (in O.D.)	Weight lbs/ft.	Setting depth	Type cement	Sacks	Type and percent additives
Surface	8-7/8	6-1/4	17#	40'	Portland	4	none
2"	5-1/4	2-3/8	4#	675'	"	90	2% Gel

LINER RECORD

PERFORATION RECORD

Top, ft.	Bottom, ft.	Sacks cement	Shots per ft.	Size & type	Depth interval
none					

Size	Setting depth	Packer set at
none		

ACID, FRACTURE, SHOT, CEMENT SQUEEZE RECORD

Amount and kind of material used	Depth interval treated
Frac - Gelled Water 2% Gel	675' to 695'

INITIAL PRODUCTION

Date of first production August, 1979	Producing method (flowing, pumping, gas lift, etc.) Pumping
RATE OF PRODUCTION PER 24 HOURS	Oil 1 bbls. Gas 0 MCF Water _____ Gas-oil ratio _____ CFPB
Disposition of gas (vented, used on lease or sold)	Producing interval(s)

INSTRUCTIONS: As provided in KCC Rule 82-2-125, within 90 days after completion of a well, one completed copy of this Drillers Log shall be transmitted to the State Geological Survey of Kansas, 4150 Monroe Street, Wichita, Kansas 67209. Copies of this form are available from the Conservation Division, State Corporation Commission, 3830 So. Meridian (P.O. Box 17027), Wichita, Kansas 66217. Phone AC 316-522-2206. If confidential custody is desired, please note Rule 82-2-125. Drillers Logs will be on open file in the Oil and Gas Division, State Geological Survey of Kansas, Lawrence, Kansas 66044.

Operator **Reese Enterprises, Inc.** DESIGNATE TYPE OF COMP.: OIL, GAS, DRY HOLE, SWDW, ETC.:

Well No. **18-79** Lease Name **Meyers**

S 13 T 16 R 21 E XX

**WELL LOG**

Show all important zones of porosity and contents thereof; cored intervals, and all drill-stem tests, including depth interval tested, cushion used, time tool open, flowing and shut-in pressures, and recoveries. SHOW GEOLOGICAL MARKERS, LOGS RUN, OR OTHER DESCRIPTIVE INFORMATION.

FORMATION DESCRIPTION, CONTENTS, ETC.	TOP	BOTTOM	NAME	DEPTH
Soil and clay	0	12		
Lime	12	23		
Shale	23	28		
Lime	28	39		
Shale	39	44		
Lime	44	65		
Shale	65	91		
Lime	91	108		
Shale	108	198		
Lime	198	217		
Shale	217	253		
Lime	253	258		
Shale	258	289		
Lime	289	295		
Shale	295	319		
Lime	319	342		
Shale	342	350		
Lime	350	372		
Shale	372	376		
Lime	376	389		
Shale	389	560		
Lime	560	567		
Shale	567	573		
Lime	573	578		
Shale	578	597		
Lime	597	602		
Shale	602	620		
Lime	620	624		
Shale	624	633		
Lime	633	640		
Shale	640	645		
Lime	645	650		
Shale	650	662		
Lime	662	665		
Shale	665	675		
Sandy shale	675	678		
Sand	678	682		
Shale	682	695		

USE ADDITIONAL SHEETS, IF NECESSARY, TO COMPLETE WELL RECORD.

Date Received	<i>Dotty Richman</i> Signature
	<i>Bookkeeper</i> Title
	<i>8-23-79</i> Date