

WELL COMPLETION REPORT AND
DRILLER'S LOG

API No. 15 — 121 — 21184
County Number

Operator Glenn F. Kayton Jr.

Address Box 337 Wellsville Mo

Well No. A-4 Lease Name Shields

Footage Location 2475 FNL; 1155 FWL-1000
feet from (N) (S) line feet from (E) (W) line

Principal Contractor Shaw Geologist

Spud Date 11-19-79 Date Completed 11-19-79 Total Depth 682 P.B.T.D.

Directional Deviation Oil and/or Gas Purchaser

S. 13 T. 16 R. E 21
W
Loc. S12 W12 NW14
County Miami

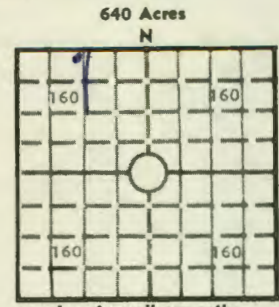

Elev.: Gr. _____
DF _____ KB _____

CASING RECORD

Report of all strings set — surface, intermediate, production, etc.

Purpose of string	Size hole drilled	Size casing set (in O.D.)	Weight lbs/ft.	Setting depth	Type cement	Sacks	Type and percent additives
	<u>5 1/4</u>	<u>2 3/8</u>	<u>3.75</u>	<u>672</u>		<u>90</u>	
		<u>6 1/4</u>		<u>20</u>			

LINER RECORD

PERFORATION RECORD

Top, ft.	Bottom, ft.	Sacks cement	Shots per ft.	Size & type	Depth interval

Size	Setting depth	Packer set at

ACID, FRACTURE, SHOT, CEMENT SQUEEZE RECORD

Amount and kind of material used	Depth interval treated
<u>4000 # water based frac</u>	

INITIAL PRODUCTION

Date of first production <u>12-19-79</u>	Producing method (flowing, pumping, gas lift, etc.)
RATE OF PRODUCTION PER 24 HOURS	Oil <u>4</u> bbls. Gas MCF Water bbls. Gas-oil ratio CFPB
Disposition of gas (vented, used on lease or sold)	Producing interval (s)

INSTRUCTIONS: As provided in KCC Rule 82-2-125, within 90 days after completion of a well, one completed copy of this Drillers Log shall be transmitted to the State Geological Survey of Kansas, 4150 Monroe Street, Wichita, Kansas 67209. Copies of this form are available from the Conservation Division, State Corporation Commission, 245 No. Water, Wichita, Kansas 67202. Phone AC 316-522-2206. If confidential custody is desired, please note Rule 82-2-125. Drillers Logs will be on open file in the Oil and Gas Division, State Geological Survey of Kansas, Lawrence, Kansas 66044.

