

SIDE ONE

13-16-21E

And

STATE CORPORATION COMMISSION OF KANSAS
OIL & GAS CONSERVATION DIVISION
WELL COMPLETION OR RECOMPLETION FORM
ACO-1 WELL HISTORY
DESCRIPTION OF WELL AND LEASE

Operator: License # 6142
Name Town Oil Co.
Address Rt. 4
Paola, KS. 66071
City/State/Zip

Purchaser: N/A

Operator Contact Person Lestes Town
Phone 913-294-2125

Contractor: License #
Name COMPANY TOOLS

Wellsite Geologist
Phone

Designate Type of Completion
 New Well Re-Entry Workover
 Oil SWD Temp. Abs.
 Gas Inj Delayed Comp.
 Dry Other (Core, Water Supply etc.)
If ONWO: old well into as follows:
Operator
Well Name
Comp. Date Old Total Depth

WELL HISTORY

Drilling Method:
 Mud Rotary Air Rotary Cable
11-3-88 11-13-88
Spud Date Date Reached TD Completion Date
710
Total Depth PBTD

Amount of Surface Pipe Set and Cemented at 20 feet
Multiple Stage Cementing Collar Used? Yes No
If yes, show depth set feet
If alternate 2 completion, cement circulated
from 0 feet depth to 20 w/ 3 SX cmt
Cement Company Name
Invoice #

API NO. 15-121-26,946
County Miami
SW. Sec. 13 Twp 16. Rge. 21 East
1945 Ft North from Southeast Corner of Section
3650 Ft West from Southeast Corner of Section
(Note: Locate well in section plat below)
Lease Name Nutt Well # GW-2 - FW2 - KCC

Field Name
Producing Formation
Elevation: Ground KB

JAN 12 1989

KANSAS GEOLOGICAL SURVEY
WICHITA BRANCH
RECEIVED
STATE CORPORATION COMMISSION
JAN 10 1989
CONSERVATION DIVISION
Wichita, Kansas

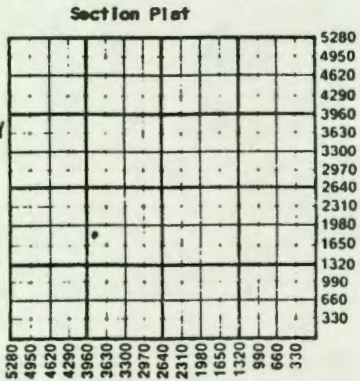

WATER SUPPLY INFORMATION
Disposition of Produced Water: Disposal
Docket # Repressuring

Questions on this portion of the ACO-1 call:
Water Resources Board (913) 296-3717
Source of Water:
Division of Water Resources Permit #
Groundwater Ft North from Southeast Corner (Well)
Ft West from Southeast Corner of Sec Twp Rge East West
Surface Water Ft North from Southeast Corner (Stream, pond etc) Ft West from Southeast Corner Sec Twp Rge East West
Other (explain) (purchased from city, R.W.D. #)

INSTRUCTIONS: This form shall be completed in triplicate and filed with the Kansas Corporation Commission, 200 Colorado Derby Building, Wichita, Kansas 67202, within 120 days of the spud date of any well. Rule 82-3-130, 82-3-107 and 82-3-106 apply. Information on side two of this form will be held confidential for a period of 12 months if requested in writing and submitted with the form. See rule 82-3-107 for confidentiality in excess of 12 months. One copy of all wireline logs and drillers time log shall be attached with this form. Submit CP-4 form with all plugged wells. Submit CP-111 form with all temporarily abandoned wells.

All requirements of the statutes, rules and regulations promulgated to regulate the oil and gas industry have been fully complied with and the statements herein are complete and correct to the best of my knowledge.

Signature Lester Town
Title Partner Date 12-21-88

Subscribed and sworn to before me this 21 day of Dec 1988
Notary Public Sonna Jean Sambart
Date Commission Expires 4-6-89

K.C.C. OFFICE USE ONLY
F Letter of Confidentiality Attached
C Wireline Log Received
C Drillers Time Log Received
Distribution
KCC SWD/Rep NGPA
KGS Plug Other (Specify)

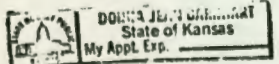

Operator Name Town Oil Co. Lease Name Null Well GW 2

Sec. 13 Twp. 16 Rge. 21 East West County Miami

WELL LOG

INSTRUCTIONS: Show important tops and base of formations penetrated. Detail all cores. Report all drill stem tests giving interval tested, time tool open and closed, flowing and shut-in pressures, whether shut-in pressure reached static level, hydrostatic pressures, bottom hole temperature, fluid recovery, and flow rates if gas to surface during test. Attach extra sheet if more space is needed. Attach copy of log.

Drill Stem Tests Taken Yes No
 Samples Sent to Geological Survey Yes No
 Cores Taken Yes No

Formation Description
 Log Sample

Name Top Bottom

See attached log

CASING RECORD <input type="checkbox"/> New <input type="checkbox"/> Used							
Report all strings set-conductor, surface, intermediate, production, etc.							
Purpose of String	Size Hole Drilled	Size Casing Set (in O.D.)	Weight Lbs/Ft.	Setting Depth	Type of Cement	#Sacks Used	Type and Percent Additives
Surface	9 1/2"	6 1/2"		20	Portland	3	
Completion	5 1/2"	2"		692	Portland	85	60/40 Poz
PERFORATION RECORD				Acid, Fracture, Shot, Cement Squeeze Record			
Shots Per Foot	Specify Footage of Each Interval Perforated			(Amount and Kind of Material Used)		Depth	
TUBING RECORD							
Size	Set At	Packer at	Liner Run <input type="checkbox"/> Yes <input type="checkbox"/> No				
Date of First Production		Producing Method					
N/A		<input type="checkbox"/> Flowing <input type="checkbox"/> Pumping <input type="checkbox"/> Gas Lift <input type="checkbox"/> Other (explain).....					
Estimated Production Per 24 Hours	Oil	Gas	Water	Gas-Oil Ratio	Gravity		
	N/A						
	Bbls	MCF	Bbls	CFPB			

METHOD OF COMPLETION

Production Interval

Disposition of gas: Vented Open Hole Perforation
 Sold Other (Specify)
 Used on Lease Dually Completed
 Commingled

TOWN OIL COMPANY

"Drilling and Production"

913-294-2125

13-16-21E

Route 4
Paola, Kansas 66071

Well #GW-2
Farm: Nutt
Miami County, KS.
Lease Owner: Town Oil Co.

WELL LOG

Thickness of Strata	Formation	Total Depth
0-7	Soil & clay	7
9	Shale & slate	16
9	Lime	25
5	Shale	30
20	Lime	50
27	Sandy shale	77
21	Lime	98
87	Shale	185
20	Lime	205
7	Shale	212
10	Sand	222
7	Shale	229
7	Shale & shells	236
8	Lime	244
18	Shale	262
12	Sand	274
5	Lime	279
7	Shale	286
1	Lime	287
17	Shale	304
8	Lime	312
2	Shale	314
14	Lime	328
6	Shale & slate	335
24	Lime	359
4	Shale & slate	363
5	Lime	368
2	Shale	370
6	Lime	376
155	Shale	531
3	Lime	534
6	Shale	540
10	Lime	550
30	Shale	580
5	Lime	585
15	Shale	600
4	Lime	604
8	Shale & slate	612
1	Lime	613
8	shale & shells	621
1	Lime	622
7	Shale & shells	629
2	Lime	631
9	Shale & shells	640
6	Shale	646

Hertha

RECEIVED
STATE CORPORATION COMMISSION
JAN 10 1989
CONSERVATION DIVISION
Wichita Kansas

31.6 - d1 -
Well #CW-2
Farm: Nutt
Miami County, KS.
Lease Owner: Town Oil Co.

WELL LOG (cont'd)

Thickness of Strata	Formation	Total Depth
5	Shale & shells	651
4	Shale	655
5	Sandy shale	660
2	Sand	662
4	Sand	666
3	Sandy shale	669
6	Sandy shale	675
35	Shale	710 TD

RECEIVED
STATE CORPORATION COMMISSION

JAN 10 1989

CONSERVATION DIVISION
Wichita, Kansas