

KANSAS DRILLERS LOG

15-121-20, 955

Released 12/16/81

S. 14 T. 16 R. 21 E
 Loc. NW 1/4 NW SE NW
 County Miami

API No. 15 — 121 — 20,955
 County Number

Operator
 Reese Exploration, Inc.

Address
 PO Box 11598, Kansas City, Mo 64138

Well No. 20-79 Lease Name Johnson

Footage Location 1878 feet from (N) line 3410 FSL : 3920 FGL - KCC 1270 feet from (E) line

Principal Contractor Michael Drilling Geologist

Spud Date July 10, 1979 Total Depth 679' P.B.T.D.

Date Completed August, 1979 Oil Purchaser Bluebird Oil Co.

CONFIDENTIAL

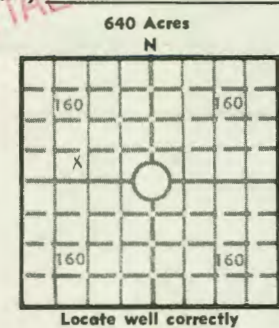

Elev.: Gr. _____
 DF _____ KB _____

CASING RECORD

Report of all strings set— surface, intermediate, production, etc.

| Purpose of string | Size hole drilled | Size casing set (in O.D.) | Weight lbs/ft. | Setting depth | Type cement | Sacks | Type and percent additives |
|-------------------|-------------------|---------------------------|----------------|---------------|-------------|-------|----------------------------|
| Surface | 8-7/8 | 6-1/4 | 17# | 40' | Portland | 4 | none |
| 2" | 5-1/4 | 2-3/8 | 4# | 659' | " | 90 | 2% Gel |
| | | | | | | | |
| | | | | | | | |

LINER RECORD

PERFORATION RECORD

| Top, ft. | Bottom, ft. | Sacks cement | Shots per ft. | Size & type | Depth interval |
|----------|-------------|--------------|---------------|-------------|----------------|
| none | | | | | |

| Size | Setting depth | Packer set at |
|------|---------------|---------------|
| none | | |

ACID, FRACTURE, SHOT, CEMENT SQUEEZE RECORD

| Amount and kind of material used | Depth interval treated |
|----------------------------------|------------------------|
| Frac - Hot Oil - 100 sacks sand | 659' to 679' |
| | |
| | |

INITIAL PRODUCTION

| | |
|--|--|
| Date of first production August 1979 | Producing method (flowing, pumping, gas lift, etc.) Pumping |
| RATE OF PRODUCTION PER 24 HOURS | Oil 1 bbls. Gas 0 MCF Water bbls. Gas-oil ratio CFPB |
| Disposition of gas (vented, used on lease or sold) | Producing interval (s) |

INSTRUCTIONS: As provided in KCC Rule 82-2-125, within 90 days after completion of a well, one completed copy of this Drillers Log shall be transmitted to the State Geological Survey of Kansas, 4150 Monroe Street, Wichita, Kansas 67209. Copies of this form are available from the Conservation Division, State Corporation Commission, 3830 So. Meridian (P.O. Box 17027), Wichita, Kansas 66217. Phone AC 316-522-2206. If confidential custody is desired, please note Rule 82-2-125. Drillers Logs will be on open file in the Oil and Gas Division, State Geological Survey of Kansas, Lawrence, Kansas 66044.

Operator

Reese Exploration, Inc.

DESIGNATE TYPE OF COMP.: OIL, GAS, DRY HOLE, SWDW, ETC.:

Oil

Well No.

20-79

Lease Name

Johnson

s 14 T 16 R 21 ^E ~~XXX~~

WELL LOG

Show all important zones of porosity and contents thereof; cored intervals, and all drill-stem tests, including depth interval tested, cushion used, time tool open, flowing and shut-in pressures, and recoveries.

SHOW GEOLOGICAL MARKERS, LOGS RUN, OR OTHER DESCRIPTIVE INFORMATION.

| FORMATION DESCRIPTION, CONTENTS, ETC. | TOP | BOTTOM | NAME | DEPTH |
|---------------------------------------|-----|--------|------|-------|
| Soil and clay | 0 | 7 | | |
| Lime | 7 | 19 | | |
| Shale | 19 | 26 | | |
| Lime | 26 | 37 | | |
| Shale | 37 | 44 | | |
| Lime | 44 | 61 | | |
| Shale | 61 | 93 | | |
| Lime | 93 | 110 | | |
| Shale | 110 | 190 | | |
| Lime | 190 | 212 | | |
| Shale | 212 | 244 | | |
| Lime | 244 | 249 | | |
| Shale | 249 | 279 | | |
| Lime | 279 | 282 | | |
| Shale | 282 | 309 | | |
| Lime | 309 | 333 | | |
| Shale | 333 | 342 | | |
| Lime | 342 | 364 | | |
| Shale | 364 | 368 | | |
| Lime | 368 | 382 | | |
| Shale | 382 | 584 | | |
| Lime | 584 | 590 | | |
| Shale | 590 | 606 | | |
| Lime | 606 | 619' | | |
| Shale | 610 | 619 | | |
| Lime | 619 | 627 | | |
| Shale | 627 | 631 | | |
| Lime | 631 | 635 | | |
| Shale | 635 | 659 | | |
| Sand Oil | 659 | 661 | | |
| Shale | 661 | 679 | | |

USE ADDITIONAL SHEETS, IF NECESSARY, TO COMPLETE WELL RECORD.

Date Received

Ratty (Erickson)

Signature

Bobbeper

Title

8-23-79

Date