

PL

KANSAS

**WELL COMPLETION REPORT AND
DRILLER'S LOG**

JUL 8 0 REC'D

S. 14 T. 16 R. 21 ^(E)W

API No. 15 — 121 — 21,355
County Number

State Geological Survey Loc. 580 EWL, 60 SNL, SE 1/4

County Miami

Operator
Scimitar Resources Ltd.

Address
P.O. Box 211 Paola, Ks. 66071

Well No. S-11A Lease Name Phillips

Footage Location
60 feet from (N) (S) line 580 feet from (E) (W) line

Principal Contractor TD Corporation Geologist Jim Stegeman

Spud Date 4-9-80 Date Completed 4-11-80 Total Depth 726' P.B.T.D.

Directional Deviation Oil and/or Gas Purchaser Producers Group

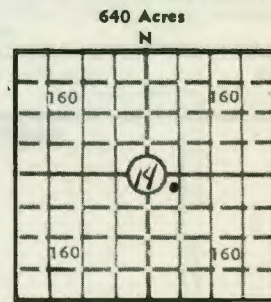

Elev.: Gr. _____

DF _____ KB _____

CASING RECORD

Report of all strings set — surface, intermediate, production, etc.

Purpose of string	Size hole drilled	Size casing set (in O.D.)	Weight lbs/ft.	Setting depth	Type cement	Sacks	Type and percent additives
	6 1/4	4 1/2"	10.5	715		110 SX.	
		2"	3.75				
		1"	1.7				

LINER RECORD

PERFORATION RECORD

Top, ft.	Bottom, ft.	Sacks cement	Shots per ft.	Size & type	Depth interval
			2 Holes	3 1/2" Strip Jets	649-650
			26 Holes	3 1/2" Strip Jets	650-659
			3 Holes	3 1/2" Strip Jets	659-660

TUBING RECORD

Size	Setting depth	Packer set at

ACID, FRACTURE, SHOT, CEMENT SQUEEZE RECORD

Amount and kind of material used	Depth interval treated
Not Acidized	649-660
1st Frac Pressured up. 2nd Frac.—170 bbls. water	
3000 lbs. Sand 20/40. No Salt. Max. 2300. AVG. 1900. Shut-In 1000 psi	

INITIAL PRODUCTION

Date of first production		Producing method (flowing, pumping, gas lift, etc.)			
5-9-80		Pumping			
RATE OF PRODUCTION PER 24 HOURS	Oil	Gas	Water	Gas-oil ratio	
	4.8 bbls.	MCF	2.8 bbls.	CFPB	
Disposition of gas (vented, used on lease or sold)			Producing interval(s)		
vented (very Little)			1st Squirrel Sand		

INSTRUCTIONS: As provided in KCC Rule 82-2-125, within 90 days after completion of a well, one completed copy of this Drillers Log shall be transmitted to the State Geological Survey of Kansas, 4150 Montoe Street, Wichita, Kansas 67209. Copies of this form are available from the Conservation Division, State Corporation Commission, 245 No. Water, Wichita, Kansas 67202. Phone AC 316-522-2206. If confidential custody is desired, please note Rule 82-2-125. Drillers Logs will be on open file in the Oil and Gas Division, State Geological Survey of Kansas, Lawrence, Kansas 66044.

Operator Scimitar Resources Ltd.		DESIGNATE TYPE OF COMP.: OIL, GAS, DRY HOLE, SWDW, ETC.:
Well No. S-11A	Lease Name Phillips	Oil Well
S <u>14</u> T <u>16</u> R <u>21</u> E W		

WELL LOG

Show all important zones of porosity and contents thereof; cored intervals, and all drill-stem tests, including depth interval tested, cushion used, time tool open, flowing and shut-in pressures, and recoveries.

SHOW GEOLOGICAL MARKERS, LOGS RUN, OR OTHER DESCRIPTIVE INFORMATION.

FORMATION DESCRIPTION, CONTENTS, ETC.	TOP	BOTTOM	NAME	DEPTH
Soil and Clay	6	6		
Lime	3	9		
Limey Shale	4	13		
Lime	17	30		
Shale	5	35		
Lime	25	60		
Shale	21	81		
Lime	24	105		
Shale	80	185		
Lime	25	210		
Shale	5	215		
Lime	3	218		
Shale	12	230		
Lime	3	233		
Shale	8	241		
Lime	5	246		
Shale	15	261		
Lime	4	265		
Shale	4	269		
Lime	4	273		
Shale	10	283		
Lime	1	284		
Shale	15	299		
Lime	21	320		
Shale	1	321		
Lime	86	407		
Shale	130	537		
Lime	8	545		
Shale	31	576		
Lime	6	582		
Shale	16	598		
Lime	5	603		
Shale	23	626		
Lime	5	631		
Shale	16	647		
Oil Sand Core 647	9	654		
Sandy Shale	2	656		
Sand Shale	9	665		
Sandy Shale	37	712		

USE ADDITIONAL SHEETS, IF NECESSARY, TO COMPLETE WELL RECORD.

Date Received	<div style="border-bottom: 1px solid black; margin-bottom: 5px; text-align: right;">Signature</div> <div style="border-bottom: 1px solid black; margin-bottom: 5px; text-align: right;">Title</div> <div style="border-bottom: 1px solid black; text-align: right;">Date</div>
---------------	--

Operator

Scimitar Resources Ltd.

DESIGNATE TYPE OF COMP.: OIL, GAS,
DRY HOLE, SWDW, ETC.:

Well No.

S-11A

Lease Name

Phillips

Oil Well

14-16-21E

S 14 T 16 R 21 (E)
W

WELL LOG

Show all important zones of porosity and contents thereof; cored intervals, and all drill-stem tests, including depth interval tested, cushion used, time tool open, flowing and shut-in pressures, and recoveries.

SHOW GEOLOGICAL MARKERS, LOGS RUN,
OR OTHER DESCRIPTIVE INFORMATION.

FORMATION DESCRIPTION, CONTENTS, ETC.

TOP

BOTTOM

NAME

DEPTH

Lime
Shale

2

726
726TD 726
F/S 715

Gamma Ray & Neutron Logged

350

710

USE ADDITIONAL SHEETS, IF NECESSARY, TO COMPLETE WELL RECORD.

Date Received

Signature

Title

Date