

KANSAS DRILLERS LOG

S. 18 T. 16 R. 21 E
W

API No. 15 — 059 — 20,602
County Number

Loc. SW SE NE SW
NW-1000
County Franklin

Operator
Town Oil Company

Address
Rural Route #4 Paola, Kansas 66071

Well No. #3 Lease Name Bivens

Footage Location
feet from (N) (S) line feet from (E) (W) line

Principal Contractor Geologist

Spud Date Total Depth 785 P.B.T.D.

Date Completed Oil Purchaser

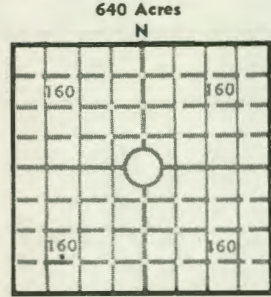

Elev.: Gr. _____
DF _____ KB _____

CASING RECORD

Report of all strings set — surface, intermediate, production, etc.

Purpose of string	Size hole drilled	Size casing set (in O.D.)	Weight lbs/ft.	Setting depth	Type cement	Sacks	Type and percent additives

LINER RECORD

PERFORATION RECORD

Top, ft.	Bottom, ft.	Sacks cement	Shots per ft.	Size & type	Depth interval

Size	Setting depth	Packer set at

ACID, FRACTURE, SHOT, CEMENT SQUEEZE RECORD

Amount and kind of material used	Depth interval treated

INITIAL PRODUCTION

Date of first production Producing method (flowing, pumping, gas lift, etc.)

RATE OF PRODUCTION PER 24 HOURS	Oil bbls.	Gas MCF	Water bbls.	Gas-oil ratio	CFPB

Disposition of gas (vented, used on lease or sold) Producing interval (s)

INSTRUCTIONS: As provided in KCC Rule 82-2-125, within 90 days after completion of a well, one completed copy of this Drillers Log shall be transmitted to the State Geological Survey of Kansas, 4150 Monroe Street, Wichita, Kansas 67209. Copies of this form are available from the Conservation Division, State Corporation Commission, 3830 So. Meridian (P.O. Box 17027), Wichita, Kansas 66217. Phone AC 316-522-2206. If confidential custody is desired, please note Rule 82-2-125. Drillers Logs will be on open file in the Oil and Gas Division, State Geological Survey of Kansas, Lawrence, Kansas 66044.

Operator		DESIGNATE TYPE OF COMP.: OIL, GAS, DRY HOLE, SWDW, ETC.:
Well No.	Lease Name	
S _____ T _____ R _____ E _____ W _____		

WELL LOG

Show all important zones of porosity and contents thereof; cored intervals, and all drill-stem tests, including depth interval tested, cushion used, time tool open, flowing and shut-in pressures, and recoveries.

SHOW GEOLOGICAL MARKERS, LOGS RUN, OR OTHER DESCRIPTIVE INFORMATION.

FORMATION DESCRIPTION, CONTENTS, ETC.	TOP	BOTTOM	NAME	DEPTH

USE ADDITIONAL SHEETS, IF NECESSARY, TO COMPLETE WELL RECORD.

Date Received	<div style="text-align: right; margin-bottom: 5px;">_____ Signature</div> <div style="text-align: right; margin-bottom: 5px;">_____ Title</div> <div style="text-align: right;">_____ Date</div>
----------------------	--

TOWN OIL CO.
"Purchaser of Crude Oil"

18-16-21 E

Route 4
Paola, Kansas 66071

913-294-2854
913-294-4232

Well No. 3
Farm: Bivens
Franklin County, Kansas
Section 18, Township 16, Range 21

WELL LOG

<u>Thickness of Strata</u>	<u>Formation</u>	<u>Total Depth</u>
17	soil & clay	17
24	lime	41
8	shale	49
10	lime	59
3	shale	62
21	lime	83
7	shale	90
1	lime	91
53	shale	144
3	lime	147
1	shale	148
22	lime	170
50	shale	220
23	lime	243
17	shale	260
2	red bed	262
6	shale	268
6	lime	274
24	shale	298
10	lime	308
9	shale	317
1	lime	318
16	shale	334
24	lime	358
7	shale & slate	365
24	lime	389
4	slate	393
12	lime	405
2	shale	407
4	lime	411
39	shale	450
10	sand	460
53	shale	513
9	sand	522
25	shale	547
3	slate	550
5	shale	555
3	lime	558
6	sand	564
4	shale	568
8	lime	576
7	shale	583

TOWN OIL CO.
"Purchaser of Crude Oil"

18-16-21E

Route 4
Paola, Kansas 66071

913-294-2854
913-294-4232

Well No. 3
Farm: Bivens
Franklin County, Kansas
Section 18, Township 16, Range 21

WELL LOG (Con't)

<u>Thickness of Strata</u>	<u>Formation</u>	<u>Total Depth</u>
10	lime	593
5	slate	598
10	lime	608
12	shale & slate	620
3	lime	623
9	shale & slate	632
3	lime	635
1	shale	636
1	lime	637
1	shale	638
7	lime	645
8	shale & slate	653
1	lime	654
4	slate	658
4	lime	662
4	shale & slate	666
1	lime	667
11	sand	678
32	shale	710
2	lime	712
8	shale	720
2	slate	722
3	sand	725
40	sandy shale	764
5	sand	769
8	shale	777
4	lime	781
4	shale	785
	Total Depth	<u>785</u>