

15-059-20900

State Geological Survey

KANSAS DRILLERS' LOG

API No. 15 — 059 — 20,680
County Number

S. 18 T. 16 R. 21 ^E/_W
 Loc. NE SW NE SE NW NE
 County Franklin *KCC*

Operator
Rader Oil Co.

Address
Route #1 Eudora, Kansas 66025

Well No. #23 Lease Name McConnell

Footage Location 1,540 4580 FSL; 1580 FGL-KCC 1,540
feet from (N) (E) line feet from (E) (W) line

Principal Contractor Kent Drilling Co. Geologist Dick Rader

Spud Date Feb. 12, 1979 Total Depth 765 P.B.T.D.

Date Completed June 18, 1979 Oil Purchaser Bluebird Oil Co.

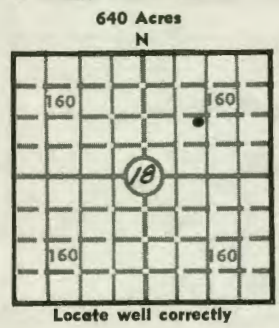

Elev.: Gr. _____
 DF _____ KB _____

CASING RECORD

Report of all strings set — surface, intermediate, production, etc.

Purpose of string	Size hole drilled	Size casing set (in O.D.)	Weight lbs/ft.	Setting depth	Type cement	Sacks	Type and percent additives
Surface	10	7	24	30	common	8	none
Production	6 1/4	4 1/2	101.50	757	Pozmix	100	Pozmix, gel, salt, flo-seal

LINER RECORD

PERFORATION RECORD

Top, ft.	Bottom, ft.	Sacks cement	Shots per ft.	Size & type	Depth interval
			1	1/2 Jet	734-40

Size	Setting depth	Packer set at
2"	730	

ACID, FRACTURE, SHOT, CEMENT SQUEEZE RECORD

Amount and kind of material used	Depth interval treated
15 sx. sand W/ 50 Bo	734-40

INITIAL PRODUCTION

Date of first production _____ Producing method (flowing, pumping, gas lift, etc.) Pumping

RATE OF PRODUCTION PER 24 HOURS	Oil <u>1</u> bbls.	Gas _____ MCF	Water <u>6</u> bbls.	Gas-oil ratio _____ CFPB
---------------------------------	--------------------	---------------	----------------------	--------------------------

Disposition of gas (vented, used on lease or sold) _____ Producing interval (s) 734-40

INSTRUCTIONS: As provided in KCC Rule 82-2-125, within 90 days after completion of a well, one completed copy of this Drillers Log shall be transmitted to the State Geological Survey of Kansas, 4150 Monroe Street, Wichita, Kansas 67209. Copies of this form are available from the Conservation Division, State Corporation Commission, 3830 So. Meridian (P.O. Box 17027), Wichita, Kansas 66217. Phone AC 316-522-2206. If confidential custody is desired, please note Rule 82-2-125. Drillers Logs will be on open file in the Oil and Gas Division, State Geological Survey of Kansas, Lawrence, Kansas 66044.

Operator **Rader Oil Co.** DESIGNATE TYPE OF COMP.: OIL, GAS, DRY HOLE, SWDW, ETC.: **Oil**

Well No. **23** Lease Name **McConnell**

S 18 T 16 R 21 E WX

WELL LOG

Show all important zones of porosity and contents thereof; cored intervals, and all drill-stem tests, including depth interval tested, cushion used, time tool open, flowing and shut-in pressures, and recoveries.

SHOW GEOLOGICAL MARKERS, LOGS RUN, OR OTHER DESCRIPTIVE INFORMATION.

FORMATION DESCRIPTION, CONTENTS, ETC.	TOP	BOTTOM	NAME	DEPTH
Soil & Clay	0	25		
Lime	25	49		
Shale	49	53		
Lime	53	66		
Shale	66	71		
Lime	71	88		
Shale	88	136		
Lime	136	167		
Shale	167	226		
Lime	226	249		
Shale	249	273		
Lime	273	278		
Shale	278	300		
Lime	300	308		
Shale	308	339		
Lime	339	362		
Shale	362	369		
Lime	369	394		
Shale	394	398		
Lime	398	408		
Shale	408	597		
Lime	597	605		
Shale	605	611		
Lime	611	615		
Shale	615	631		
Lime	631	634		
Shale	634	642		
Lime	642	656		
Shale	656	676		
Oil-Sand	676	690	1st. Squir.	676-690
Shale	690	734		
Oil-Sand	734	742	2nd Squirrel	734-742
Shale	742	765 TD		

USE ADDITIONAL SHEETS, IF NECESSARY, TO COMPLETE WELL RECORD.

Date Received	Signature
	Owner
	Title
	Date

Nov. 13, 1979