

WICHITA BRANCH  
KANSAS DRILLERS LOG

Released  
12/16/81

S. 24 T. 16 R. 21 E  
Loc. E 1/2 NW 1/4  
County Miami

API No. 15 — 121 — 20928  
County Number

Operator  
Reese Exploration, Inc

Address  
PO Box 11598, Kansas City, Mo. 64138

Well No. 6-79 Lease Name Schendel

Footage Location  
1155 feet from (N)  line 864 feet from (W)  line

Principal Contractor Michael Drilling Geologist

Spud Date June 12, 1979 Total Depth 687' P.B.T.D.

Date Completed July, 1979 Oil Purchaser Bluebird Oil Co.

CONFIDENTIAL

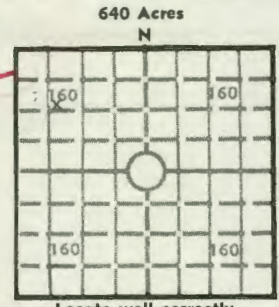

Elev.: Gr. \_\_\_\_\_  
DF \_\_\_\_\_ KB \_\_\_\_\_

CASING RECORD

Report of all strings set — surface, intermediate, production, etc.

Purpose of string	Size hole drilled	Size casing set (in O.D.)	Weight lbs/ft.	Setting depth	Type cement	Sacks	Type and percent additives
Surface	8-7/8	6-1/4	17#	40'	Portland	4	none
2"	5-1/4	2-3/8	4#	667'	"	90	2% Gel

LINER RECORD

PERFORATION RECORD

Top, ft.	Bottom, ft.	Sacks cement	Shots per ft.	Size & type	Depth interval
none					

Size	Setting depth	Packer set at
none		

ACID, FRACTURE, SHOT, CEMENT SQUEEZE RECORD

Amount and kind of material used	Depth interval treated
Frac Gelled Water 200 sacks sand	667' to 687'

INITIAL PRODUCTION

Date of first production <u>August 1979</u>	Producing method (flowing, pumping, gas lift, etc.) <u>Pumping</u>
RATE OF PRODUCTION PER 24 HOURS	Oil <u>1</u> bbls. Gas <u>0</u> MCF Water _____ bbls. Gas-oil ratio _____ CFPB
Disposition of gas (vented, used on lease or sold)	Producing interval (s)

INSTRUCTIONS: As provided in KCC Rule 82-2-125, within 90 days after completion of a well, one completed copy of this Drillers Log shall be transmitted to the State Geological Survey of Kansas, 4150 Monroe Street, Wichita, Kansas 67209. Copies of this form are available from the Conservation Division, State Corporation Commission, 3830 So. Meridian (P.O. Box 17027), Wichita, Kansas 66217. Phone AC 316-522-2206. If confidential custody is desired, please note Rule 82-2-125. Drillers Logs will be on open file in the Oil and Gas Division, State Geological Survey of Kansas, Lawrence, Kansas 66044.

Operator **Reese Enterprises, Inc.** DESIGNATE TYPE OF COMP.: OIL, GAS, DRY HOLE, SWDW, ETC.: **Oil**

Well No. **6-79** Lease Name **Schendel**

S 24 T 16 R 21 <sup>E</sup>  
~~XXXX~~

**WELL LOG**

Show all important zones of porosity and contents thereof; cored intervals, and all drill-stem tests, including depth interval tested, cushion used, time tool open, flowing and shut-in pressures, and recoveries.

SHOW GEOLOGICAL MARKERS, LOGS RUN, OR OTHER DESCRIPTIVE INFORMATION.

FORMATION DESCRIPTION, CONTENTS, ETC.	TOP	BOTTOM	NAME	DEPTH
Soil and clay	0	8		
Lime	8	15		
Shale	15	21		
Lime	21	29		
Shale	29	38		
Lime	38	56		
Shale	56	84		
Lime	84	100		
Shale	100	191		
Lime	191	211		
Shale	211	241		
Lime	241	249		
Shale	249	282		
Lime	282	289		
Shale	289	311		
Lime	311	337		
Shale	337	344		
Lime	344	367		
Shale	367	370		
Lime	370	383		
Shale	383	551		
Lime	551	558		
Shale	558	587		
Lime	587	591		
Shale	591	609		
Lime	609	613		
Shale	613	620		
Lime	620	632		
Shale	632	637		
Lime	637	642		
Shale	642	654		
Lime	654	659		
Shale	659	667		
Sand oil	667	677		
Sandy shale	677	683		
Shale	683	687		

USE ADDITIONAL SHEETS, IF NECESSARY, TO COMPLETE WELL RECORD.

Date Received \_\_\_\_\_

*Patty Friedman*  
 Signature  
*Bookkeeper*  
 Title  
 8-23-79  
 Date