

WELL COMPLETION REPORT AND DRILLER'S LOG

0091

S. 25 T. 16 R. 21 E. W
 Loc. 660 NSL 1210 WEL NW 1/4
 County Miami *SE NW-160*

API No. 15 — 121 — 21463
 County Number

Operator Scimitar Resources, Ltd.			
Address P.O. Box 211 Paola, Ks. 66071			
Well No. S-6A	Lease Name Pflug		
Footage Location <u>660</u> feet from (W) (S) line <u>3174 FSL & 3850 FEL-1000</u> <u>1210</u> feet from (E) (W) line			
Principal Contractor T.D. Corporation		Geologist Jim Stegeman	
Spud Date 5/1/80	Date Completed 5/2/80	Total Depth 730'	P.B.T.D.
Directional Deviation —		Oil and/or Gas Purchaser Producers Group	

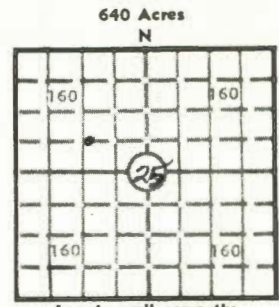

Elev.: Gr. _____
 DF _____ KB _____

CASING RECORD

Report of all strings set — surface, intermediate, production, etc.

Purpose of string	Size hole drilled	Size casing set (in O.D.)	Weight lbs/ft.	Setting depth	Type cement	Sacks	Type and percent additives
Production	6 1/4	4 1/2"	10.5	720'	Portland A	125	2 sks of gel

LINER RECORD

PERFORATION RECORD

Top, ft.	Bottom, ft.	Sacks cement	Shots per ft.	Size & type	Depth interval
TUBING RECORD			2 1/2 44 total	3 1/2 strip jets	653-670'
Size	Setting depth	Packer set at			

ACID, FRACTURE, SHOT, CEMENT SQUEEZE RECORD

Amount and kind of material used	Depth interval treated
400# rock salt 70 gal. 15% HCL	653-670'
8000# 20/40 frac sand	
Immed. SDP: 550 psi max pressure: 775 psi Av. pressure: 600 psi final pressure: 650 psi	

INITIAL PRODUCTION

Date of first production 6/12/80	Producing method (flowing, pumping, gas lift, etc.) pumping		
RATE OF PRODUCTION PER 24 HOURS	Oil 2.7 bbls.	Gas MCF	Water 2.5 bbls.
Disposition of gas (vented, used on lease or sold) Vented		Producing interval (s) Squirrel	

INSTRUCTIONS: As provided in KCC Rule 82-2-125, within 90 days after completion of a well, one completed copy of this Drillers Log shall be transmitted to the State Geological Survey of Kansas, 4150 Monroe Street, Wichita, Kansas 67209. Copies of this form are available from the Conservation Division, State Corporation Commission, 245 No. Water, Wichita, Kansas 67202. Phone AC 316-522-2206. If confidential custody is desired, please note Rule 82-2-125. Drillers Logs will be on open file in the Oil and Gas Division, State Geological Survey of Kansas, Lawrence, Kansas 66044.

Operator		DESIGNATE TYPE OF COMP.: OIL, GAS, DRY HOLE, SWDW, ETC.:
Well No.	Lease Name	
S <u>25</u> T <u>16</u> R <u>21</u> ^E _W		

WELL LOG

Show all important zones of porosity and contents thereof; cored intervals, and all drill-stem tests, including depth interval tested, cushion used, time tool open, flowing and shut-in pressures, and recoveries.

SHOW GEOLOGICAL MARKERS, LOGS RUN, OR OTHER DESCRIPTIVE INFORMATION.

FORMATION DESCRIPTION, CONTENTS, ETC.	TOP	BOTTOM	NAME	DEPTH
soil and clay	6	6		
clay and lime	1	7		
lime	3	10		
sand stone	1	11		
sandstone and lime	1	12		
lime	2	14		
limey shale	3	17		
shale	7	24		
lime	2	26		
shale	7	33		
limey shale	6	39		
lime	3	42		
limey shale	2	44		
lime	2	46		
shale	27	73		
lime	4	77		
limey shale	9	86		
lime	1	87		
shale	96	183		
lime	19	202		
shale	30	232		
lime and shale	1	233		
lime	8	241		
shale	21	262		
limey shale	4	266		
lime	12	278		
shale	19	297		
lime	16	313		
shale	4	317		
lime	2	319		
shale	2	321		
lime	1	322		
shale	12	334		
lime	1	335		
shale	10	345		
lime	2	347		
shale	6	353		
lime	5	358		
shale	1	359		
lime	2	361		

USE ADDITIONAL SHEETS, IF NECESSARY, TO COMPLETE WELL RECORD.

Date Received	<hr style="border: none; border-top: 1px solid black; margin-bottom: 5px;"/> Signature <hr style="border: none; border-top: 1px solid black; margin-bottom: 5px;"/> Title <hr style="border: none; border-top: 1px solid black; margin-bottom: 5px;"/> Date
---------------	---

Operator _____ DESIGNATE TYPE OF COMP.: OIL, GAS, DRY HOLE, SWDW, ETC.: SEP

Well No. _____ Lease Name _____ P1

S 25 T 16 R 21 ^E_W

WELL LOG

Show all important zones of porosity and contents thereof; cored intervals, and all drill-stem tests, including depth interval tested, cushion used, time tool open, flowing and shut-in pressures, and recoveries.

SHOW GEOLOGICAL MARKERS, LOGS RUN, OR OTHER DESCRIPTIVE INFORMATION.

FORMATION DESCRIPTION, CONTENTS, ETC.	TOP	BOTTOM	NAME	DEPTH
shale	4	365		
lime	6	371		
shale	13	384		
sand	6	390		
shale	149	539		
lime	6	545		
shale	9	554		
lime	1	555		
shale	24	579		
lime	6	585		
shale	17	602		
lime	1	603		
shale	4	607		
lime	3	610		
shale	11	621		
lime	7	628		
shale	2	630		
lime	1	631		
shale	4	635		
lime	1	636		
shale	5	641		
lime	1	642		
shale and lime	16	658		
oilsand	12	670		
shale	50	720		
lime	1	721		
shale	9	730		

F/S 720
ID 730

USE ADDITIONAL SHEETS, IF NECESSARY, TO COMPLETE WELL RECORD.

Date Received	<hr/> <p style="text-align: right;">Signature</p> <hr/> <p style="text-align: right;">Title</p> <hr/> <p style="text-align: right;">Date</p>
---------------	--

WELL COMPLETION REPORT AND
DRILLER'S LOG

API No. 15 _____
County _____ Number _____

S. _____ T. _____ R. _____ E _____
W _____

Loc. _____

County _____

Operator _____

Address _____

Well No. _____ Lease Name _____

Footage Location
feet from (N) (S) line _____ feet from (E) (W) line _____

Principal Contractor _____ Geologist _____

Spud Date _____ Date Completed _____ Total Depth _____ P.B.T.D. _____

Directional Deviation _____ Oil and/or Gas Purchaser _____

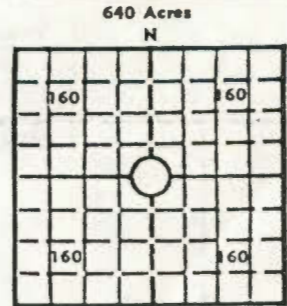

Locate well correctly

Elev.: Gr. _____

DF _____ KB _____

CASING RECORD

Report of all strings set— surface, intermediate, production, etc.

Purpose of string	Size hole drilled	Size casing set (in O.D.)	Weight lbs/ft.	Setting depth	Type cement	Sacks	Type and percent additives

LINER RECORD

PERFORATION RECORD

Top, ft.	Bottom, ft.	Sacks cement	Shots per ft.	Size & type	Depth interval

TUBING RECORD

Size	Setting depth	Packer set at

ACID, FRACTURE, SHOT, CEMENT SQUEEZE RECORD

Amount and kind of material used	Depth interval treated

INITIAL PRODUCTION

Date of first production _____	Producing method (flowing, pumping, gas lift, etc.) _____			
RATE OF PRODUCTION PER 24 HOURS _____	Oil _____ bbls.	Gas _____ MCF	Water _____ bbls.	Gas-oil ratio _____ CFPB
Disposition of gas (vented, used on lease or sold) _____			Producing interval(s) _____	

INSTRUCTIONS: As provided in KCC Rule 82-2-125, within 90 days after completion of a well, one completed copy of this Drillers Log shall be transmitted to the State Geological Survey of Kansas, 4150 Monroe Street, Wichita, Kansas 67209. Copies of this form are available from the Conservation Division, State Corporation Commission, 245 No. Water, Wichita, Kansas 67202. Phone AC 316-522-2206. If confidential custody is desired, please note Rule 82-2-125. Drillers Logs will be on open file in the Oil and Gas Division, State Geological Survey of Kansas, Lawrence, Kansas 66044.

WELL RECORD

15-121-21,463
25-16-21E

Well No S-6-A Farm Pflug Producer Scimitar Resources, Ltd.
 Location $S\frac{1}{2}$ of NW $\frac{1}{4}$ Sec. 25 Twp. 16 Rg. 21E
 Elevation State Kansas County Miami
 Kind (Oil, Gas, Water, Dry Hole) Oil Contractor McGown Drilling, Inc.
 Producing formation Top Bottom
 Shot with qts. from to
 Packer Set at Kind Size
 Liner from to Perforated from to

LOG					
Top			Bottom		
Thick-ness	Strata	Depth	Thick-ness	Strata	Depth
	Soil/Clay	0	55		
	Shale	55	85		
	Lime	85	99		
	Shale	99	192		
	Lime	192	212		
	Shale	212	240		
	Lime	240	248		
	Shale	248	271		
	Lime	271	283		
	Shale	283	304		
	Lime	304	329		
	Shale	329	342		
	Lime	342	362		
	Shale	362	366		
	Lime	366	379		
	Shale	379	547		
	Lime	547	554		
	Shale	554	562		
	Lime	562	566		
	Shale	566	587		
	Lime	587	592		
	Shale	592	609		
	Lime	609	612		
	Shale	612	665		
	Core	665	682		
	Oil Sand	682	670		
	Sand & Shale	670	681		
	Shale	681	725/TD		

Total Depth 725'
 Open Hole
 Casing 2 $\frac{1}{2}$ " at 710'
 Casing at
 Casing at
 Cement
 Tubing
 Rods
 Additional Information
 SN 660'

Date Completed 032180

O. K.

Superintendent