

KANSAS

WELL COMPLETION REPORT AND  
DRILLER'S LOG

State Geological Survey  
WICHITA, BRANCH

S. 25 T. 16 R. 21 E  
Loc. 160<sup>1</sup> SWL 1320<sup>1</sup> EWL E<sub>1</sub> SW<sub>1</sub><sup>1</sup>  
County Miami NW NW SE

API No. 15 — 121 — 21446  
County Number

Operator Scimitar Resources Ltd.			
Address P.O. Box 211 Paola, Kansas 66071			
Well No. S-13A	Lease Name Pflug		
Footage Location 160 feet from (N) line 2452 FSL: 2614 FGL-KCC 1920 feet from (W) line			
Principal Contractor T. D. Corporation		Geologist Jim Stegeman	
Spud Date 5/12/80	Date Completed 5/16/80	Total Depth 740'	P.B.T.D.
Directional Deviation		Oil and/or Gas Purchaser Producers Group	

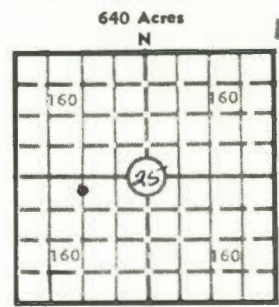

Locate well correctly  
Elev.: Gr. \_\_\_\_\_  
DF \_\_\_\_\_ KB \_\_\_\_\_

CASING RECORD

Report of all strings set — surface, intermediate, production, etc.

Purpose of string	Size hole drilled	Size casing set (in O.D.)	Weight lbs/ft.	Setting depth	Type cement	Sacks	Type and percent additives
Production	6 1/8"	4 1/2"	10.5	730'	Portland	100	4 sks of gel

LINER RECORD

PERFORATION RECORD

Top, ft.	Bottom, ft.	Sacks cement	Shots per ft.	Size & type	Depth interval
			2 1/2 per ft. 74	3 1/2" strip jets	645-678'

TUBING RECORD

Size	Setting depth	Packer set at

ACID, FRACTURE, SHOT, CEMENT SQUEEZE RECORD

Amount and kind of material used	Depth interval treated
50 gal. 15% HCL	645-678'

INITIAL PRODUCTION

Date of first production 6/16/80		Producing method (flowing, pumping, gas lift, etc.) pumping		
RATE OF PRODUCTION PER 24 HOURS	Oil 2.7 bbls.	Gas MCF	Water 2.5 bbls.	Gas-oil ratio CFPB
Disposition of gas (vented, used on lease or sold) Vented			Producing interval (s) Squirrel	

INSTRUCTIONS: As provided in KCC Rule 82-2-125, within 90 days after completion of a well, one completed copy of this Drillers Log shall be transmitted to the State Geological Survey of Kansas, 4150 Monroe Street, Wichita, Kansas 67209. Copies of this form are available from the Conservation Division, State Corporation Commission, 245 No. Water, Wichita, Kansas 67202. Phone AC 316-522-2206. If confidential custody is desired, please note Rule 82-2-125. Drillers Logs will be on open file in the Oil and Gas Division, State Geological Survey of Kansas, Lawrence, Kansas 66044.

Operator		DESIGNATE TYPE OF COMP.: OIL, GAS, DRY HOLE, SWDW, ETC.:
Well No.	Lease Name	
S <u>25</u> T <u>16</u> R <u>21</u> E		

**WELL LOG**

Show all important zones of porosity and contents thereof; cored intervals, and all drill-stem tests, including depth interval tested, cushion used, time tool open, flowing and shut-in pressures, and recoveries.

SHOW GEOLOGICAL MARKERS, LOGS RUN, OR OTHER DESCRIPTIVE INFORMATION.

FORMATION DESCRIPTION, CONTENTS, ETC.	TOP	BOTTOM	NAME	DEPTH
soil and clay	3	3		
clay and lime	1	4		
lime	6	10		
shale	12	22		
lime	1	23		
shale	1	24		
lime	14	38		
shale	13	51		
lime	1	52		
shale	8	60		
lime	1	61		
shale	1	62		
lime	1	63		
shale	4	67		
lime	17	84		
shale	93	177		
lime	18	195		
shale	28	223		
Lime	8	231		
shale	26	257		
lime	12	269		
shale	1	270		
lime	1	271		
shale	18	289		
lime	24	313		
shale	10	323		
lime	19	342		
black shale	4	346		
lime	5	351		
shale	2	353		
lime	7	360		
shale	3	363		
lime	3	366		
shale	158	524		
lime	9	533		
shale	8	541		
lime	3	544		
shale	21	565		
lime	6	571		
shale	17	588		

USE ADDITIONAL SHEETS, IF NECESSARY, TO COMPLETE WELL RECORD.

Date Received	_____ Signature
	_____ Title
	_____ Date

Operator *Seimitar* DESIGNATE TYPE OF COMP.: OIL, GAS, DRY HOLE, SWDW, ETC.:

Well No. *S-13A* Lease Name *Pflug*

*S 25 T 16 R 21 E W*

**WELL LOG**

Show all important zones of porosity and contents thereof; cored intervals, and all drill-stem tests, including depth interval tested, cushion used, time tool open, flowing and shut-in pressures, and recoveries.

SHOW GEOLOGICAL MARKERS, LOGS RUN, OR OTHER DESCRIPTIVE INFORMATION.

FORMATION DESCRIPTION, CONTENTS, ETC.	TOP	BOTTOM	NAME	DEPTH
lime	4	592		
shale	5	597		
lime	2	599		
shale	4	603		
lime	8	611		
shale	2	613		
limey shale	4	617		
lime	8	625		
shale	3	628		
lime	1	629		
shale	6	635		
lime	2	637		
shale	1	638		
lime	1	639		
shale	2	641		
lime	1	642		
shale	2	644		
lime	2	646		
oil sand	1	647		
core 647 to 663	16			
shale	28	691		
shale	49	740		

USE ADDITIONAL SHEETS, IF NECESSARY, TO COMPLETE WELL RECORD.

Date Received	Signature _____
	Title _____
	Date _____