

31-16-21E

STATE CORPORATION COMMISSION OF KANSAS
OIL & GAS CONSERVATION DIVISION
WELL COMPLETION OR RECOMPLETION FORM
ACO-1 WELL HISTORY
DESCRIPTION OF WELL AND LEASE

API NO. 15-059-24381

County Franklin

NW SW SE Sec. 31 Twp 16 Rge 21 East West

1300 Ft North from Southeast Corner of Section
2020 Ft West from Southeast Corner of Section
(Note: Locate well in section plat below)

Operator: License # 5959
Name Richard Rader
Address R. R. #1
City/State/Zip Eudora, Kansas 66025

Lease Name Hermes Well # 24

Purchaser Crude Marketing, Inc.
Coffeyville, Ks.

Field Name Paola-Rantoul

Operator Contact Person Richard Rader
Phone 913-883-2885

Producing Formation Squirrel

Contractor: License # 5820
Name Kent Drilling Co.

Elevation: Ground 940 KB

Wellsite Geologist None
Phone

Designate Type of Completion
 New Well Re-Entry Workover
 Oil SWD Temp Abd
 Gas Inj Delayed Comp.
 Dry Other (Core, Water Supply etc.)

DEC 20 1988
RECEIVED
STATE CORPORATION COMMISSION
DEC 21 1988
CONSERVATION DIVISION
Wichita Kansas
KANSAS GEOLOGICAL SURVEY
WICHITA BRANCH

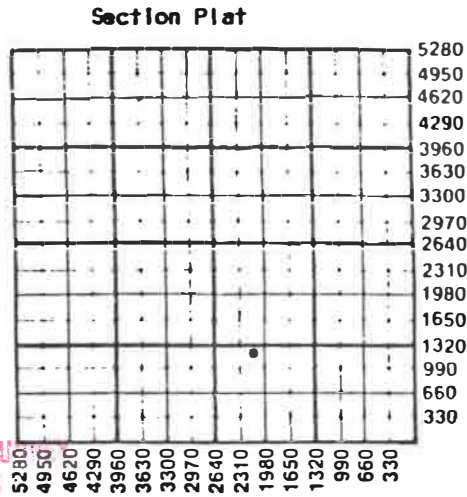

If OWO: old well info as follows:
Operator
Well Name
Comp. Date Old Total Depth

WATER SUPPLY INFORMATION

Disposition of Produced Water: Disposal
Docket # Repressuring

WELL HISTORY

Drilling Method:
 Mud Rotary Air Rotary Cable
9-26-88 9-27-88 12-5-88
Spud Date Date Reached TD Completion Date
685
Total Depth PBTD

Questions on this portion of the ACO-1 call:

Water Resources Board (913) 296-3717
Source of Water:
Division of Water Resources Permit #
 Groundwater Ft North from Southeast Corner (Well) Ft West from Southeast Corner of Sec Twp Rge East West
 Surface Water Ft North from Southeast Corner (Stream, pond etc.) Ft West from Southeast Corner Sec Twp Rge East West
 Other (explain) (purchased from city, R.W.D. #)

Amount of Surface Pipe Set and Cemented at 20 feet
Multiple Stage Cementing Collar Used? Yes No
If yes, show depth set feet
If alternate 2 completion, cement circulated from 680 feet depth to surf. w/ 89 SX cmt
Cement Company Name Consolidated Serv.
Invoice # 7443

INSTRUCTIONS: This form shall be completed in triplicate and filed with the Kansas Corporation Commission, 200 Colorado Derby Building, Wichita, Kansas 67202, within 120 days of the spud date of any well. Rule 82-3-130, 82-3-107 and 82-3-106 apply.
Information on side two of this form will be held confidential for a period of 12 months if requested in writing and submitted with the form. See rule 82-3-107 for confidentiality in excess of 12 months.
One copy of all wireline logs and drillers time log shall be attached with this form. Submit CP-4 form with all plugged wells. Submit CP-111 form with all temporarily abandoned wells.

All requirements of the statutes, rules and regulations promulgated to regulate the oil and gas industry have been fully complied with and the statements herein are complete and correct to the best of my knowledge.

Signature *Richard Rader*
Title Owner Date 12-15-88

Subscribed and sworn to before me this 15th day of Dec 1988.
Notary Public *Marie Linder*
Date Commission Expires 11, 1990

K.C.C. OFFICE USE ONLY
F Letter of Confidentiality Attached
C Wireline Log Received
C Drillers Time Log Received
Distribution
 KCC SWD/Rep NGPA
 KGS Plug Other (Specify)

MARIE LINDER
State of Kansas
My Appt. Exp. 2-11-90

Sec 31 Twp 16 Rge 21E

Operator Name Richard Rader Lease Name Hermes Well # 24

Sec. 31 Twp. 16 Rge. 21 East West County Franklin 550176

WELL LOG

INSTRUCTIONS: Show important tops and base of formations penetrated. Detail all cores. Report all drill stem tests giving interval tested, time tool open and closed, flowing and shut-in pressures, whether shut-in pressure reached static level, hydrostatic pressures, bottom hole temperature, fluid recovery, and flow rates if gas to surface during test. Attach extra sheet if more space is needed. Attach copy of log.

Drill Stem Tests Taken Yes No
 Samples Sent to Geological Survey Yes No
 Cores Taken Yes No

Formation Description
 Log Sample

Name	Top	Bottom
Squirrel	573	595
Squirrel	641	650

CASING RECORD New Used
 Report all strings set-conductor, surface, intermediate, production, etc.

Purpose of String	Size Hole Drilled	Size Casing Set (In O.D.)	Weight Lbs/Ft.	Setting Depth	Type of Cement	#Sacks Used	Type and Percent Additives
Surface	11 1/2"	7"	18#	21'	Common	5	None
Production	6 1/2"	4 1/2"	9.5#	680'	Pozmix	89	50/50

PERFORATION RECORD Acid, Fracture, Shot, Cement Squeeze Record (Amount and Kind of Material Used)

Shots Per Foot	Specify Footage of Each Interval Perforated	Depth
2	573 1/2 - 588	100 Gal 7 1/2% HCL

TUBING RECORD Size 2" Set At 570 Packer at _____ Liner Run Yes No

Date of First Production 12-6-88 Producing Method Flowing Pumping Gas Lift Other (explain).....

Estimated Production Per 24 Hours	Oil	Gas	Water	Gas-Oil Ratio	Gravity
	.5 Bbls	0 MCF	.5 Bbls	CFPB	30

METHOD OF COMPLETION Production Interval

Disposition of gas: Vented Open Hole Perforation
 Sold Other (Specify) 573 1/2 - 588
 Used on Lease Dually Completed
 Commingled

3 opt. 28, 1988

31-16-21E

Kent Drilling Co.

TELEPHONE 448-1102 or 3927

GARNETT, KANSAS 66032

ADLER OIL COMPANY

WICHITA 66203

3	Soil & clay	3
19	Lime	22
87	Shale	109
19	Lime	128
83	Shale	191
12	Lime	203
21	Shale	224
24	Lime	248
10	Shale	258
22	Lime	280
5	Shale	285
12	Lime	297
140	Shale	445
7	Lime	453
53	Shale	500
6	Lime	511
14	Shale	525
4	Lime	529
29	Shale	558
6	Br. Lime	564
11	Shale	575
5	Lime	583
7	Oil sand	590
5	blk sand	595
3	Shale	623
7	Sand	655
6	Shale	641
0	Oil sand	650
33	Shale	685 T.D.

7" set @ 20' cemented to surface.
4" set @ 679.95' cemented to surface

RECEIVED
STATE CORPORATION COMMISSION

DEC 21 1988

CONSERVATION DIVISION
Wichita, Kansas