

15-121-20586

State Geological Survey

WICHITA BRANCH
KANSAS DRILLERS LOG

S. 19 T. 16 R. 22 E
W
Loc. 175' ~~BL~~ & 575' FEL NWc SW
7 NL " " "
County Miami

API No. 15 — 121 — 20,586
County Number

Operator
Charles D. Nicolay

Address
Box 365 Wellsville, Kansas 66092

Well No. #7 Lease Name Tarr

Footage Location
175 feet from (N) line 575' feet from (E) line

Principal Contractor Hawkeye Drilling Geologist None

Spud Date 11-17-77 Total Depth 688 P.B.T.D.

Date Completed 11-29-77 Oil Purchaser Town Oil

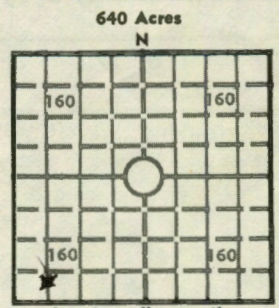

Elev.: Gr. 1050'
DF _____ KB _____

CASING RECORD

Report of all strings set — surface, intermediate, production, etc.

Purpose of string	Size hole drilled	Size casing set (in O.D.)	Weight lbs/ft.	Setting depth	Type cement	Sacks	Type and percent additives
	6 1/2"						
2 1/2" open completion with 1" pump pipe - all #2.							

LINER RECORD

PERFORATION RECORD

Top, ft.	Bottom, ft.	Sacks cement	Shots per ft.	Size & type	Depth interval
Cemented Top & Seating nipple					
TUBING RECORD alt #2			Open Hole		
Size	Setting depth	Packer set at			

ACID FRACTURE SHOT, CEMENT SQUEEZE RECORD

Amount and kind of material used	Depth interval treated
Fractured with Jelled Water	

INITIAL PRODUCTION

Date of first production 11-29-77	Producing method (flowing, pumping, gas lift, etc.) pumping
RATE OF PRODUCTION PER 24 HOURS 1024 hrs	Oil A flow frac water Gas B 6 1/2 bbls. 0 MCF 60 bbls. — CFPB
Disposition of gas (vented, used on lease or sold)	Producing interval (s) 12 at 1/2 min

INSTRUCTIONS: As provided in KCC Rule 82-2-125, within 90 days after completion of a well, one completed copy of this Drillers Log shall be transmitted to the State Geological Survey of Kansas, 4150 Monroe Street, Wichita, Kansas 67209. Copies of this form are available from the Conservation Division, State Corporation Commission, 3830 So. Meridian (P.O. Box 17027), Wichita, Kansas 66217. Phone AC 316-522-2206. If confidential custody is desired, please note Rule 82-2-125. Drillers Logs will be on open file in the Oil and Gas Division, State Geological Survey of Kansas, Lawrence, Kansas 66044.

Operator Holly Oil Co.

DESIGNATE TYPE OF COMP.: OIL, GAS, DRY HOLE, SWDW, ETC.: Oil

Well No. # 7

Lease Name Tau

S 19 T 16 R 22 E

WELL LOG

Show all important zones of porosity and contents thereof; cored intervals, and all drill-stem tests, including depth interval tested, cushion used, time tool open, flowing and shut-in pressures, and recoveries.

SHOW GEOLOGICAL MARKERS, LOGS RUN, OR OTHER DESCRIPTIVE INFORMATION.

FORMATION DESCRIPTION, CONTENTS, ETC.	TOP	BOTTOM	NAME	DEPTH
Clay -	0	2		
Shale -	2	28		
lime & Shale	28	668		
Oil Sand	668	669	Squid	
Broken Sand	669	671		
Oil Sand	671	676		
Broken Oil Sand	676	678		
Oil Sand	678	683		
Broken	683	684		
Shale	684	688	T D	

USE ADDITIONAL SHEETS, IF NECESSARY, TO COMPLETE WELL RECORD.

Date Received

C.D. [Signature]
Signature

Partner Holly Oil
Title

1-11-78
Date