

State Geological Survey  
WICHITA BRANCH  
KANSAS DRILLERS LOG

15-101-20372

API No. 15 — 121 — 20,592  
County Number

S. 19 T. 16 R. 22 E  
Loc. 175' FSL & 1425' E/NWc SW  
County Miami

Operator  
Charles D. Nicolay

Address  
Box 365 Wellsville, Kansas 66092

Well No. #9 Lease Name Tarr

Footage Location  
175 feet from (N) line 1425 feet from (W) line

Principal Contractor Hawkeye Drilling Geologist None

Spud Date 12-2-77 Total Depth 688 P.B.T.D.

Date Completed 12-14-77 Oil Purchaser Town Oil

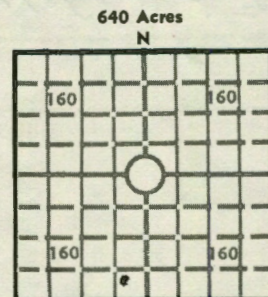

Locate well correctly  
Elev.: Gr. 1045  
DF KB

CASING RECORD

Report of all strings set — surface, intermediate, production, etc.

| Purpose of string | Size hole drilled | Size casing set (in O.D.) | Weight lbs/ft. | Setting depth | Type cement | Sacks  | Type and percent additives |
|-------------------|-------------------|---------------------------|----------------|---------------|-------------|--------|----------------------------|
| 2 1/2" Completion |                   | 1" pump pipe              |                |               |             | ALX #2 |                            |

LINER RECORD

PERFORATION RECORD

| Top, ft.               | Bottom, ft.        | Sacks cement  | Shots per ft. | Size & type | Depth interval |
|------------------------|--------------------|---------------|---------------|-------------|----------------|
| Cemented               | From Top to Bottom |               |               |             |                |
| ALX #2 - TUBING RECORD |                    |               | Open Hole     |             |                |
| Size                   | Setting depth      | Packer set at |               |             |                |

ACID, FRACTURE, SHOT, CEMENT SQUEEZE RECORD

| Amount and kind of material used | Depth interval treated |
|----------------------------------|------------------------|
| Fractured with Jelled Water      |                        |

INITIAL PRODUCTION

Date of first production 12-14-77 Producing method (flowing, pumping, gas lift, etc.) pumping

RATE OF PRODUCTION PER 24 HOURS 10224 bbls. Oil after water 7 bbls. Gas 0 bbls. Water 70680 bbls. Gas-oil ratio 20.6 bbls CFPB

Disposition of gas (used on lease or sold) None - (Producing interval (s)) 12 S. P. M.

INSTRUCTIONS: As provided in KCC Rule 82-2-125, within 90 days after completion of a well, one completed copy of this Drillers Log shall be transmitted to the State Geological Survey of Kansas, 4150 Monroe Street, Wichita, Kansas 67209. Copies of this form are available from the Conservation Division, State Corporation Commission, 3830 So. Meridian (P.O. Box 17027), Wichita, Kansas 66217. Phone AC 316-522-2206. If confidential custody is desired, please note Rule 82-2-125. Drillers Logs will be on open file in the Oil and Gas Division, State Geological Survey of Kansas, Lawrence, Kansas 66044.



|                                       |                       |   |
|---------------------------------------|-----------------------|---|
| Operator <u>Holly Oil</u>             |                       | DESIGNATE TYPE OF COMP.: OIL, GAS,<br>DRY HOLE, SWDW, ETC.: |
| Well No. <u>9</u>                     | Lease Name <u>Tan</u> | <u>Oil</u>  |
| S <u>19</u> T <u>16</u> R <u>22</u> E |                       |   |

### WELL LOG

Show all important zones of porosity and contents thereof; cored intervals, and all drill-stem tests, including depth interval tested, cushion used, time tool open, flowing and shut-in pressures, and recoveries.

SHOW GEOLOGICAL MARKERS, LOGS RUN, OR OTHER DESCRIPTIVE INFORMATION.

| FORMATION DESCRIPTION, CONTENTS, ETC. | TOP | BOTTOM | NAME   | DEPTH |
|---------------------------------------|-----|--------|--------|-------|
| Soil                                  | 0   | 2      |        |       |
| Clay                                  | 2   | 12     |        |       |
| Black Stone                           | 20  | 24     |        |       |
| lime & Shale                          | 24  | 668    |        |       |
| Broken Sand                           | 668 | 671    | Squirt |       |
| Oil Sand                              | 671 | 672    |        |       |
| Broken Sand                           | 672 | 674    |        |       |
| Oil Sand                              | 674 | 678    |        |       |
| Broken Sand                           | 678 | 682    |        |       |
| Shale                                 | 682 | 688    | T.D.   |       |

USE ADDITIONAL SHEETS, IF NECESSARY, TO COMPLETE WELL RECORD.

|               |                          |
|---------------|--------------------------|
| Date Received | <u>CPD/indley</u>        |
|               | Signature                |
|               | <u>Partner Holly Oil</u> |
|               | Title                    |
|               | <u>1-11-78</u>           |
|               | Date                     |