

State Geological Survey
WICHITA, BRANCH
KANSAS DRILLERS LOG

IMPORTANT
Kans. Geo. Survey request
samples on this well.

24-16-7E ✓

S. 24 T. 16 R. 7 E
Loc. NW NE NE
County Morris

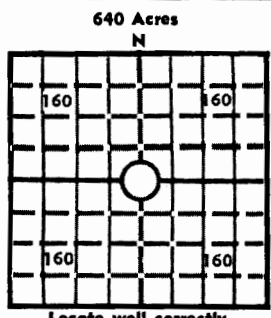

Elev.: Gr. 1416
DF 1418 KB 1421

API No. 15 - 127 - 20030
County Number

Operator
Brandt Oil Co.

Address
300 West Douglas - Suite 510

Well No. #1 Lease Name Bosch

Footage Location
340 feet from (N) line 990 feet from (E) line

Principal Contractor TRIANGLE Drilling Co Geologist EARL O BRANDT

Spud Date 12-8-1972 Total Depth 3120 P.B.T.D. 2959

Date Completed 1-16-1973 Oil Purchaser Permian

CASING RECORD

Report of all strings set — surface, intermediate, production, etc.

Purpose of string	Size hole drilled	Size casing set (in O.D.)	Weight lbs/ft.	Setting depth	Type cement	Sacks	Type and percent additives
Surface	12 1/4	8 5/8		135	Permian	85	
Production	7 7/8	5 1/2		2990	Latex	150	

LINER RECORD

PERFORATION RECORD

Top, ft.	Bottom, ft.	Sacks cement	Shots per ft.	Size & type	Depth interval
			2 per ft		2934-44
			2 per ft		2911 1/2 - 2915 1/2

TUBING RECORD

Size	Setting depth	Packer set at
2 1/2	2748	

ACID, FRACTURE, SHOT, CEMENT SQUEEZE RECORD

Amount and kind of material used	Depth interval treated
2000 gallo 28%	2934-44
250 Mud Acid + 2500 gallo 28%	2911 1/2 - 2915 1/2

INITIAL PRODUCTION

Date of first production 1-16-1973 Producing method (flowing, pumping, gas lift, etc.) Pumping

RATE OF PRODUCTION PER 24 HOURS	Oil	Gas	Water	Gas-oil ratio
	<u>2 bbls</u>	<u>15</u>	<u>15</u>	

Disposition of gas (vented, used on lease or sold) _____ Producing interval (s) 2934-44 + 2911 1/2 - 2915 1/2

INSTRUCTIONS: As provided in KCC Rule 82-2-125, within 90 days after completion of a well, one completed copy of this Drillers Log shall be transmitted to the State Geological Survey of Kansas, 4150 Monroe Street, Wichita, Kansas 67209. Copies of this form are available from the Conservation Division, State Corporation Commission, 3830 So. Meridian (P.O. Box 17027), Wichita, Kansas 66217. Phone AC 316-522-2206. If confidential custody is desired, please note Rule 82-2-125. Drillers Logs will be on open file in the Oil and Gas Division, State Geological Survey of Kansas, Lawrence, Kansas 66044.

3-5-73 Well P.B. + Completed from Hunter Plot. 2748-52

Operator BRANDT Oil Company DESIGNATE TYPE OF COMP.: OIL, GAS, DRY HOLE, SWDW, ETC.: Oil

Well No. 1 Lease Name Bosch

S 24 T 16s R 7 E 24

WELL LOG

Show all important zones of porosity and contents thereof; cored intervals, and all drill-stem tests, including depth interval tested, cushion used, time tool open, flowing and shut-in pressures, and recoveries.

SHOW GEOLOGICAL MARKERS, LOGS RUN, OR OTHER DESCRIPTIVE INFORMATION.

FORMATION DESCRIPTION, CONTENTS, ETC.	TOP	BOTTOM	NAME	DEPTH
			Howard	1004 (+417)
			Topoka	1072 (+349)
			Heekham	1388 (+33)
			Lansing	1641 (-220)
			BKc	2006 (-585)
			Cher Sh	2214 (-793)
			Miss Chert	2461 (-1040)
			Miss Ln	2499 (-1078)
			Kh	2564 (-1143)
			Hon	2748 (-1327)
			Maguoketa	2820 (-1399)
			Viola	2909 (-1488)
			Sp Sh	3010 (-1589)
			Sp Sd	3003 (-1592)
			Sp Sd (lower)	3058 (-1637)
			ARB	3076 (-1655)
			RT10	3120
			LTD	3103

USE ADDITIONAL SHEETS, IF NECESSARY, TO COMPLETE WELL RECORD.

Date Received 1973

RECEIVED
STATE GEOLOGICAL
DEPARTMENT
OF
MINES

Carl A Brandt
Signature

Geologist
Title

9-28-1973
Date